

CDWA-9c

Client; Mussi, L&R

Field; 12; 01 (86.1 ac.)

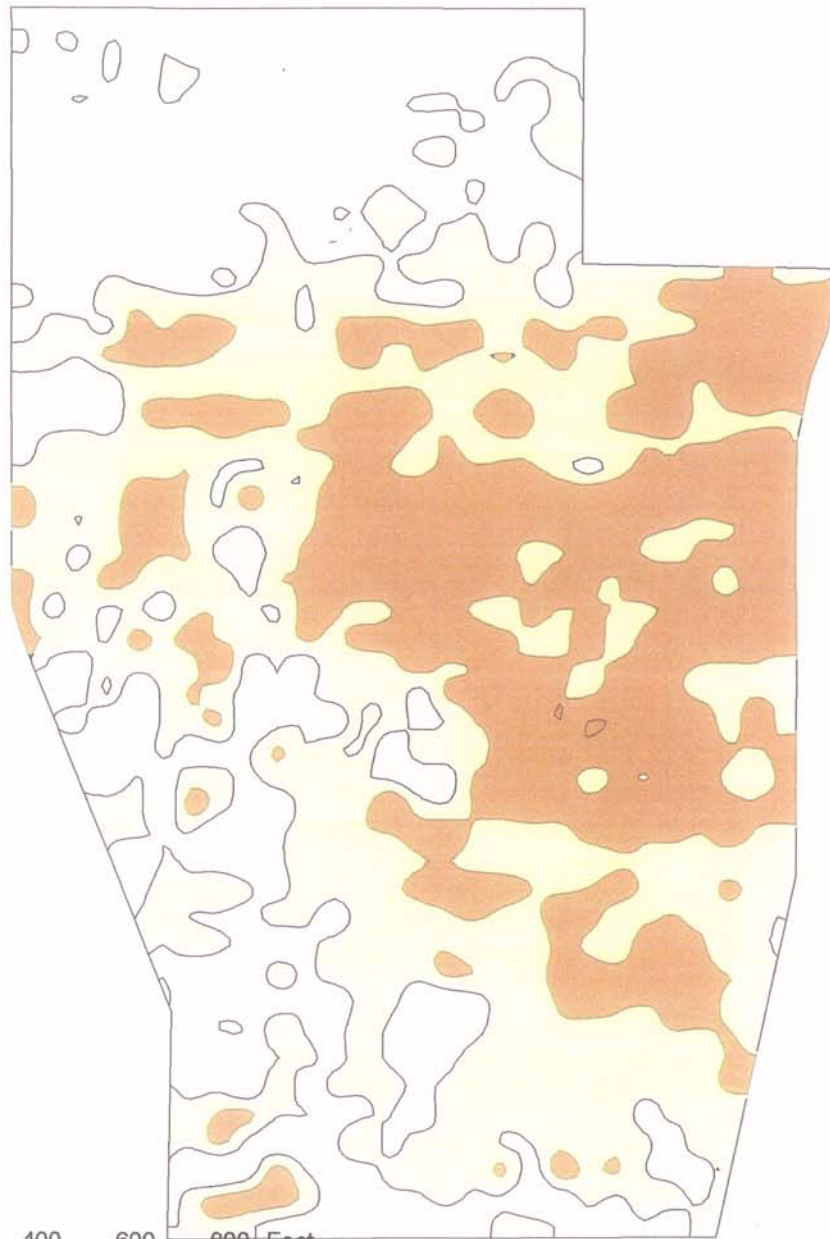

200 0 200 400 600 800 Feet

Deep Surface Polygons	
	9.8 - 40.4 (26.8 ac.)
	40.4 - 58.6 (35.1 ac.)
	58.6 - 91.1 (24.3 ac.)



Date: Mar 14, 2002
Field Name: 12; 01
Location: San Co., California, United States
Section 0, T, R
Section 0, T1N, R6E
Farm Name: Muller
Client Name: L&R Mussi
Total Acres: 86.1
Field Boundary Start Location:
Latitude: 37.90506132
Longitude: -121.37128516

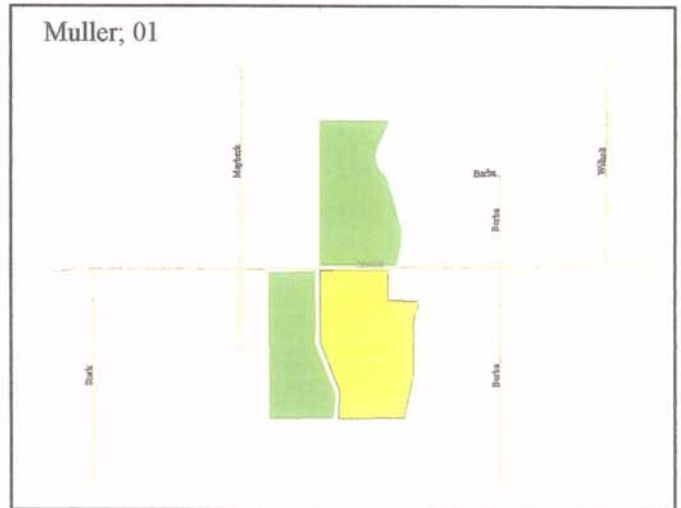

Client; Mussi, L&R

Field; 12; 01 (86.1 ac.)

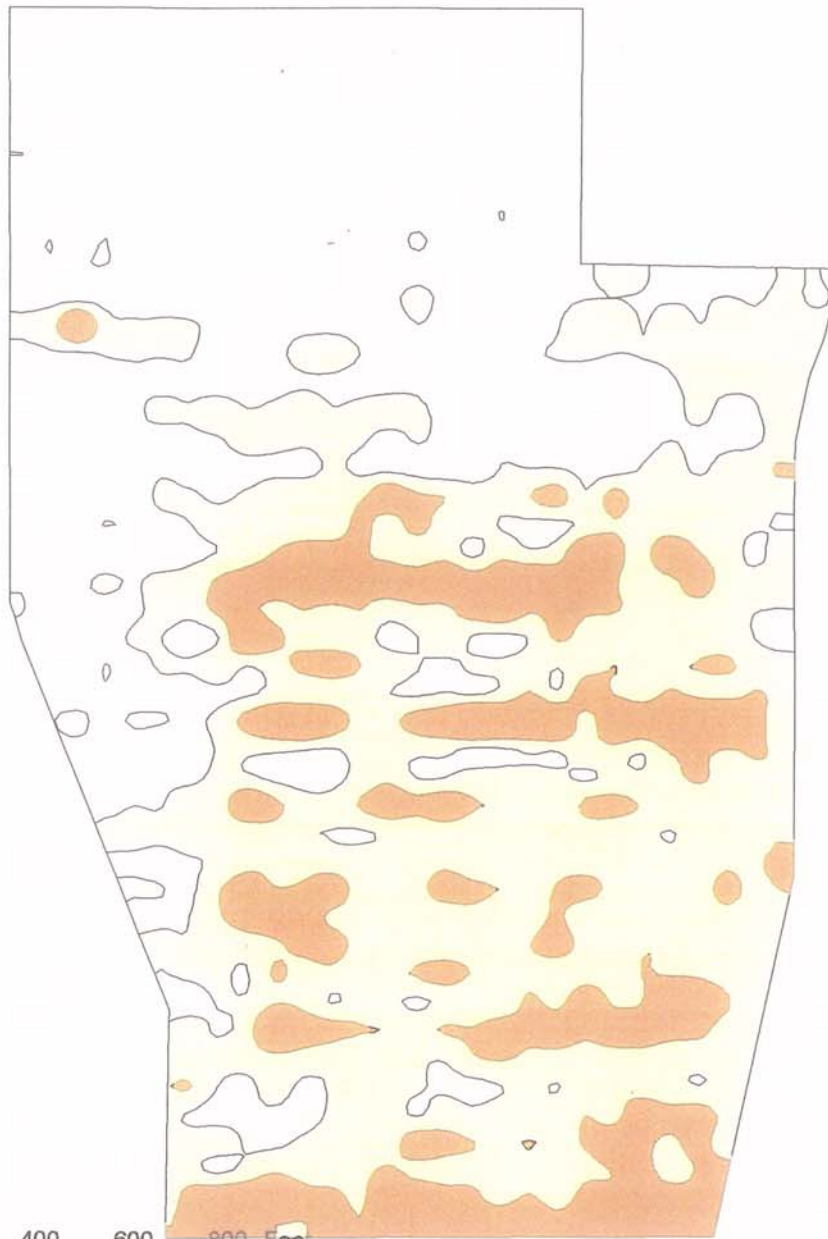

200 0 200 400 600 800 Feet

Shallow Surface Polygons	
	2.9 - 6.6 (35.5 ac.)
	6.6 - 10.3 (36.8 ac.)
	10.3 - 22.1 (13.8 ac.)



Date: Mar 14, 2002
Field Name: 12; 01
Location: San Co., California, United States
Section 0, T, R
Section 0, T1N, R6E
Farm Name: Muller
Client Name: L&R Mussi
Total Acres: 86.1
Field Boundary Start Location:
Latitude: 37.90506132
Longitude: -121.37128516

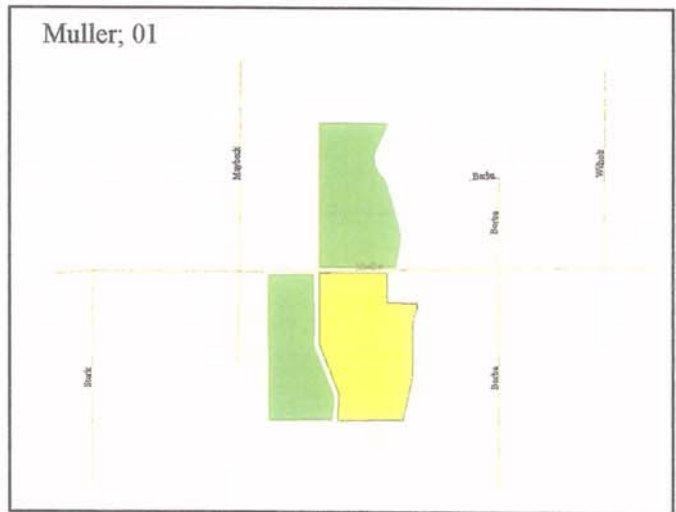

Client; Mussi, L&R

Field; 11/13; 01 (55.1 ac.)



Deep Surface Polygons	
	9.7 - 28.6 (15.8 ac.)
	28.6 - 43 (24.2 ac.)
	43 - 67.4 (15.1 ac.)



Date: Mar 14, 2002
Field Name: 11/13; 01
Location: San Co., California, United States
Section 0, T, R
Farm Name: Muller
Client Name: L&R Mussi
Total Acres: 55.1
Field Boundary Start Location:
Latitude: 37.90494098
Longitude: -121.37445350

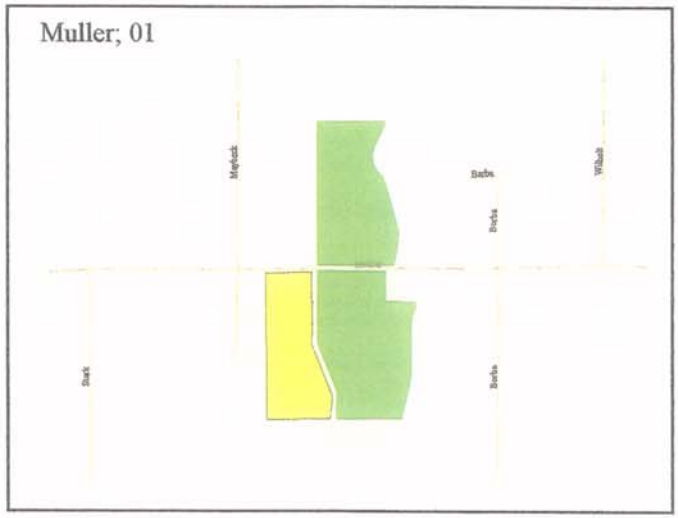

Client; Mussi, L&R

Field; 11/13; 01 (55.1 ac.)

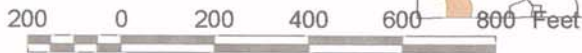

Shallow Surface Polygons	
	10.5 - 16.6 (22.6 ac.)
	16.6 - 21.4 (23.6 ac.)
	21.4 - 34.1 (9.0 ac.)



Date: Mar 14, 2002
Field Name: 11/13; 01
Location: San Co., California, United States
Section 0, T, R
Farm Name: Muller
Client Name: L&R Mussi
Total Acres: 55.1
Field Boundary Start Location:
Latitude: 37.90494098
Longitude: -121.37445350



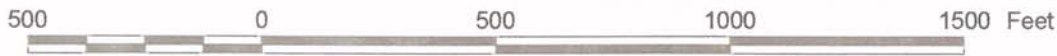

Deep Surface Polygons	
	9.4 - 35.7 (11.6 ac.)
	35.7 - 56.9 (34.8 ac.)
	56.9 - 105.6 (26.8 ac.)



Date: Mar 14, 2002
Field Name: 9; 01
Location: San Co., California, United States
Section 0, T, R
Section 0, T1N, R6E
Farm Name: Muller
Client Name: L&R Mussi
Total Acres: 73.3
Field Boundary Start Location:
Latitude: 37.91230401
Longitude: -121.37129800

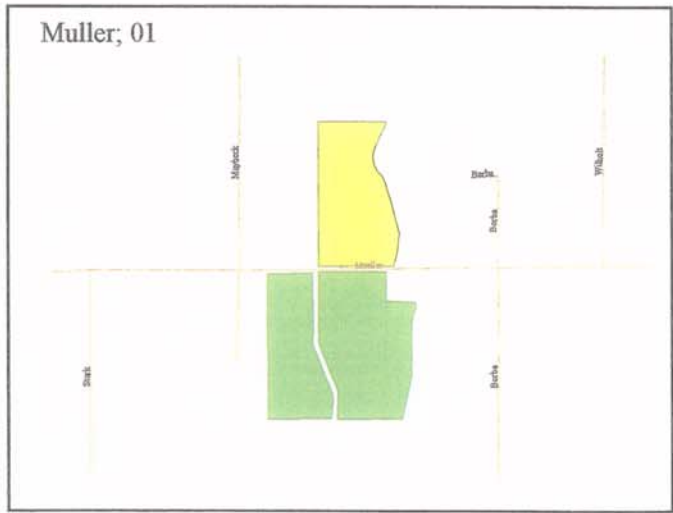

Client: Mussi, L&R

Field; 9; 01 (73.3 ac.)

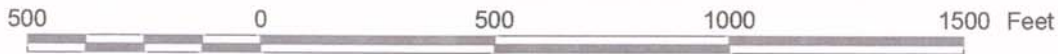
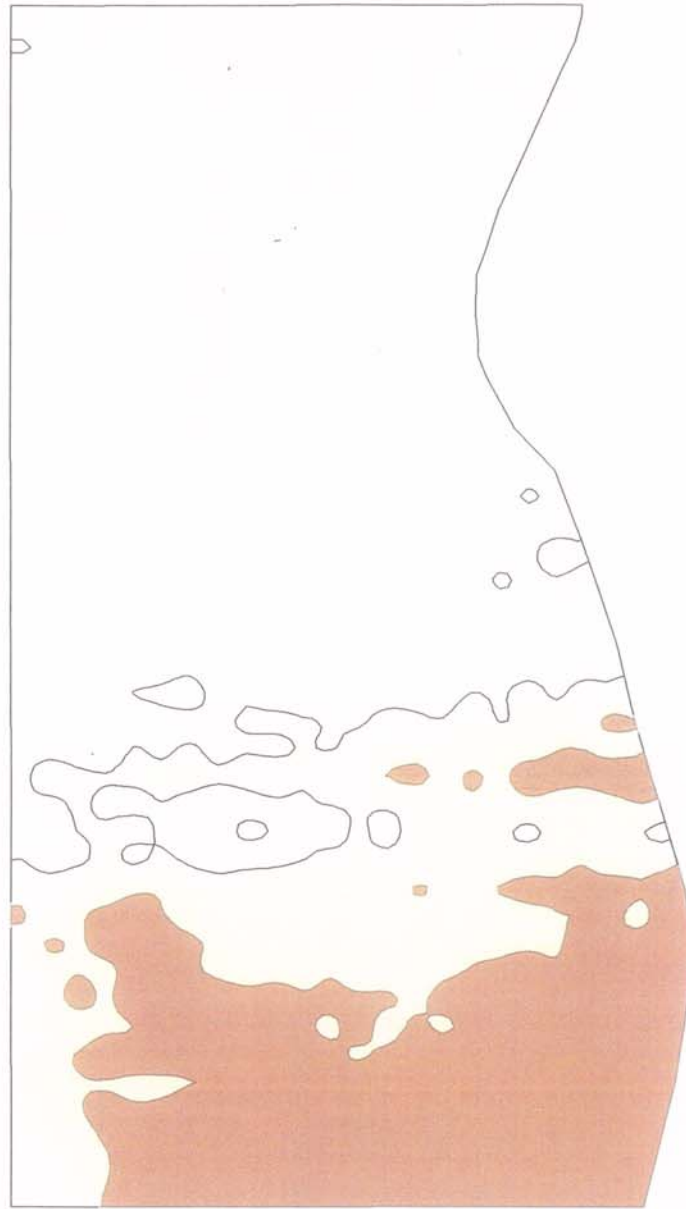

Shallow Surface Polygons	
	3.1 - 14.5 (42.0 ac.)
	14.5 - 29 (14.9 ac.)
	29 - 63.9 (16.3 ac.)



Date: Mar 14, 2002
Field Name: 9; 01
Location: San Co., California, United States
Section 0, T, R
Section 0, T1N, R6E
Farm Name: Muller
Client Name: L&R Mussi
Total Acres: 73.3
Field Boundary Start Location:
Latitude: 37.91230401
Longitude: -121.37129800

