

CDWA - 5

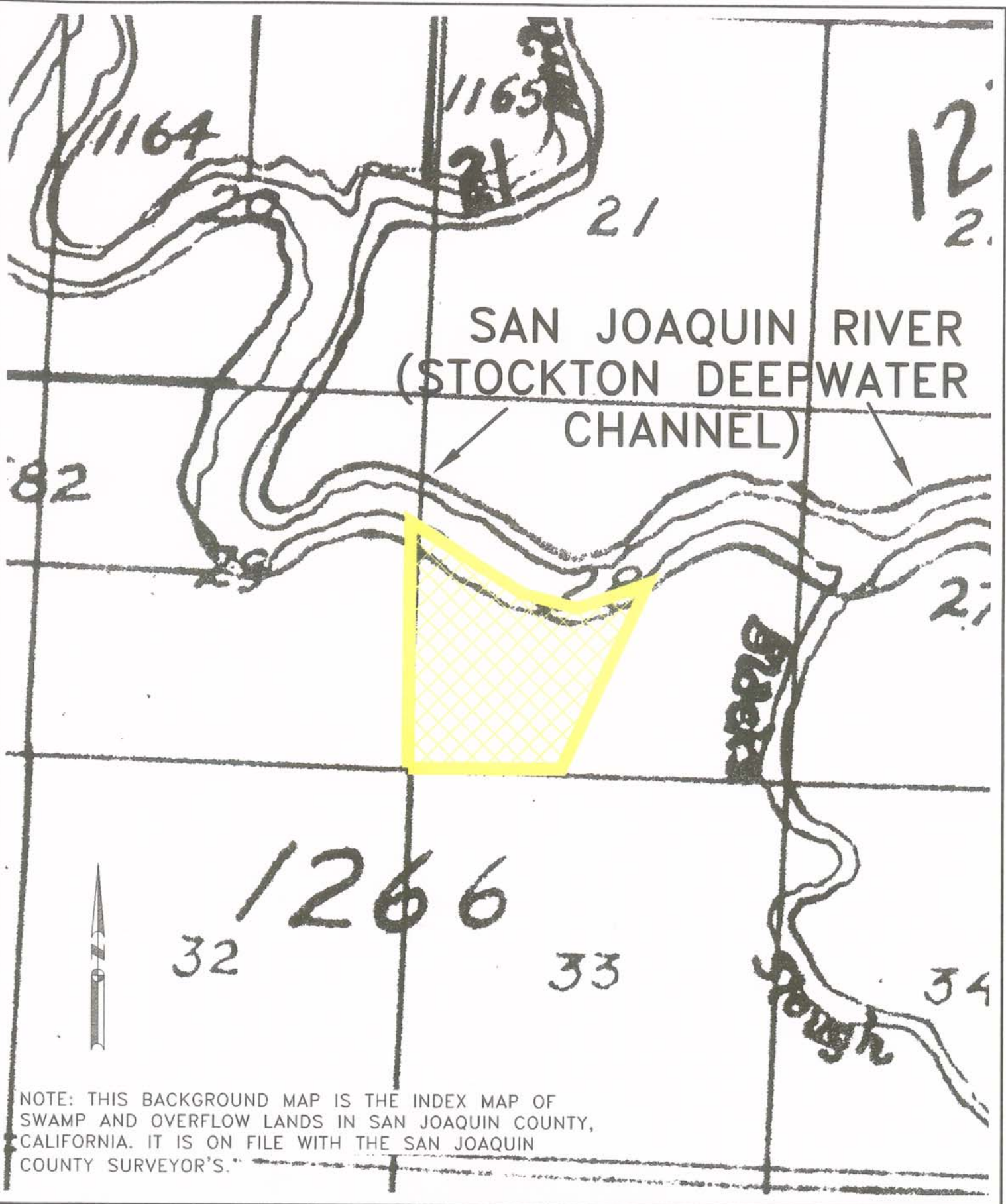

NOTE: THIS BACKGROUND MAP IS THE INDEX MAP OF SWAMP AND OVERFLOW LANDS IN SAN JOAQUIN COUNTY, CALIFORNIA. IT IS ON FILE WITH THE SAN JOAQUIN COUNTY SURVEYOR'S.

K S N INC. KJELDSSEN SINNOCK NEUDECK
 Consulting Engineers and Land Surveyors
 Post Office Box 844
 711 N. Pershing Avenue
 Stockton, CA 95201-0844
 Office: (209) 946-0268
 Faxes: (209) 946-0298
 E-mail: KSN@ksninc.com

RC FARMS INC.
ROBERTS ISLAND
 GRANT DEED - 9/11/1974
CONVEYANCE EXHIBIT

Design	Scale 1" = 2000'
Drawn SLB	Original Drawing Scale 0 1/4" 1/2"
Check BAS	

Date	6/10/03
Sheet Number	1 Of 9
Project File No.	1084-1000

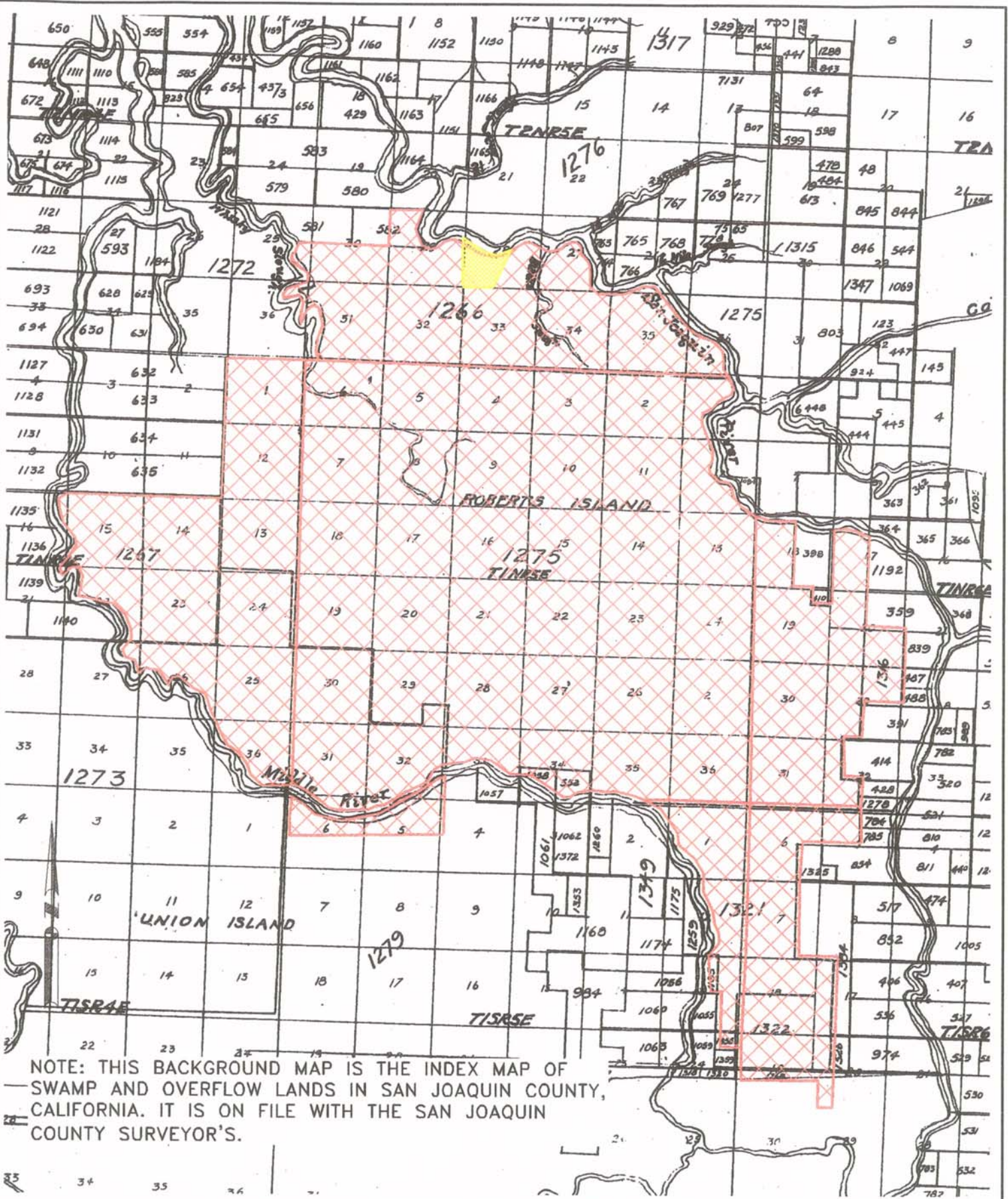

NOTE: THIS BACKGROUND MAP IS THE INDEX MAP OF SWAMP AND OVERFLOW LANDS IN SAN JOAQUIN COUNTY, CALIFORNIA. IT IS ON FILE WITH THE SAN JOAQUIN COUNTY SURVEYOR'S.

K S N
KJELSDEN
SINNOCK
NEUDECK
 INC. Consulting Engineers
 and Land Surveyors
 Post Office Box 844
 711 N. Pershing Avenue
 Stockton, CA 95201-0844
 Office: (209) 946-0268
 Faxes: (209) 946-0296
 E-mail: KSN@ksninc.com

GRANTOR: STATE OF CALIFORNIA
GRANTEE: J.P. WHITNEY
GRANT DEED - 01/17/1877
CONVEYANCE EXHIBIT

Design
 Drawn
 SLB
 Check
 BAS

Scale
 1" = 10000'
 Original Drawing Scale
 0 1/4" 1/2"

Date
 6-10-03
 Sheet Number
 2 of 9
 Project File No.
 1084-1000

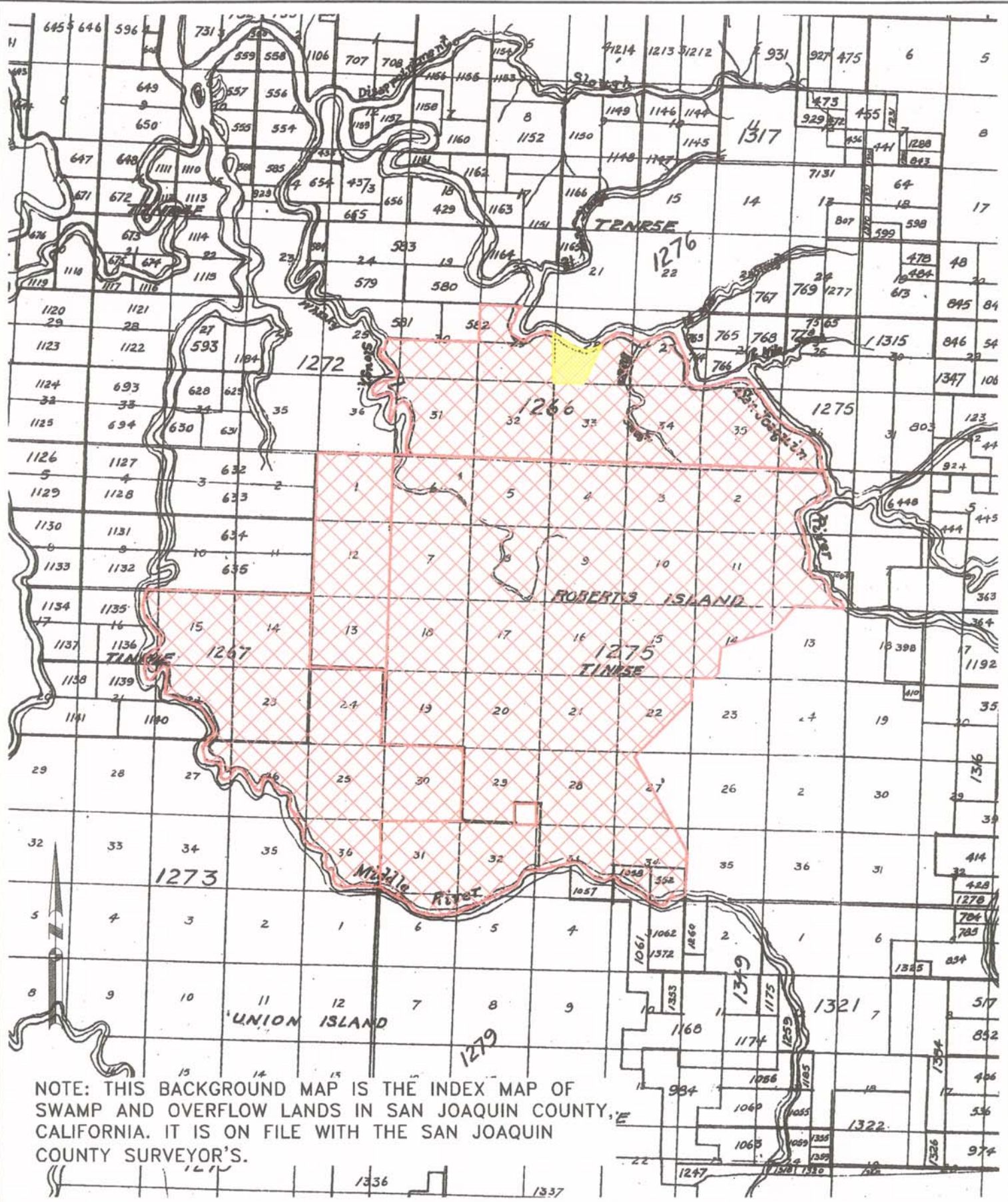

NOTE: THIS BACKGROUND MAP IS THE INDEX MAP OF SWAMP AND OVERFLOW LANDS IN SAN JOAQUIN COUNTY, CALIFORNIA. IT IS ON FILE WITH THE SAN JOAQUIN COUNTY SURVEYOR'S.

K S N INC. KJELSDEN SINNOCK NEUDECK
 Consulting Engineers and Land Surveyors
 Post Office Box 844
 711 N. Pershing Avenue
 Stockton, CA 95201-0844
 Office: (209) 946-0268
 Faxes: (209) 946-0296
 E-mail: KSN@ksninc.com

GRANTOR: J.P. WHITNEY
GRANTEE: MORTON FISHER
GRANT DEED - 1/22/1877
CONVEYANCE EXHIBIT

Design	Scale	Date
Drawn	1" = 1000'	6/10/03
SLB	Original Drawing Scale	Sheet Number
Check	0 1/4" 1/2"	3 Of 9
BAS		Project File No.
		1084-1000

Project File No.
1084-1000

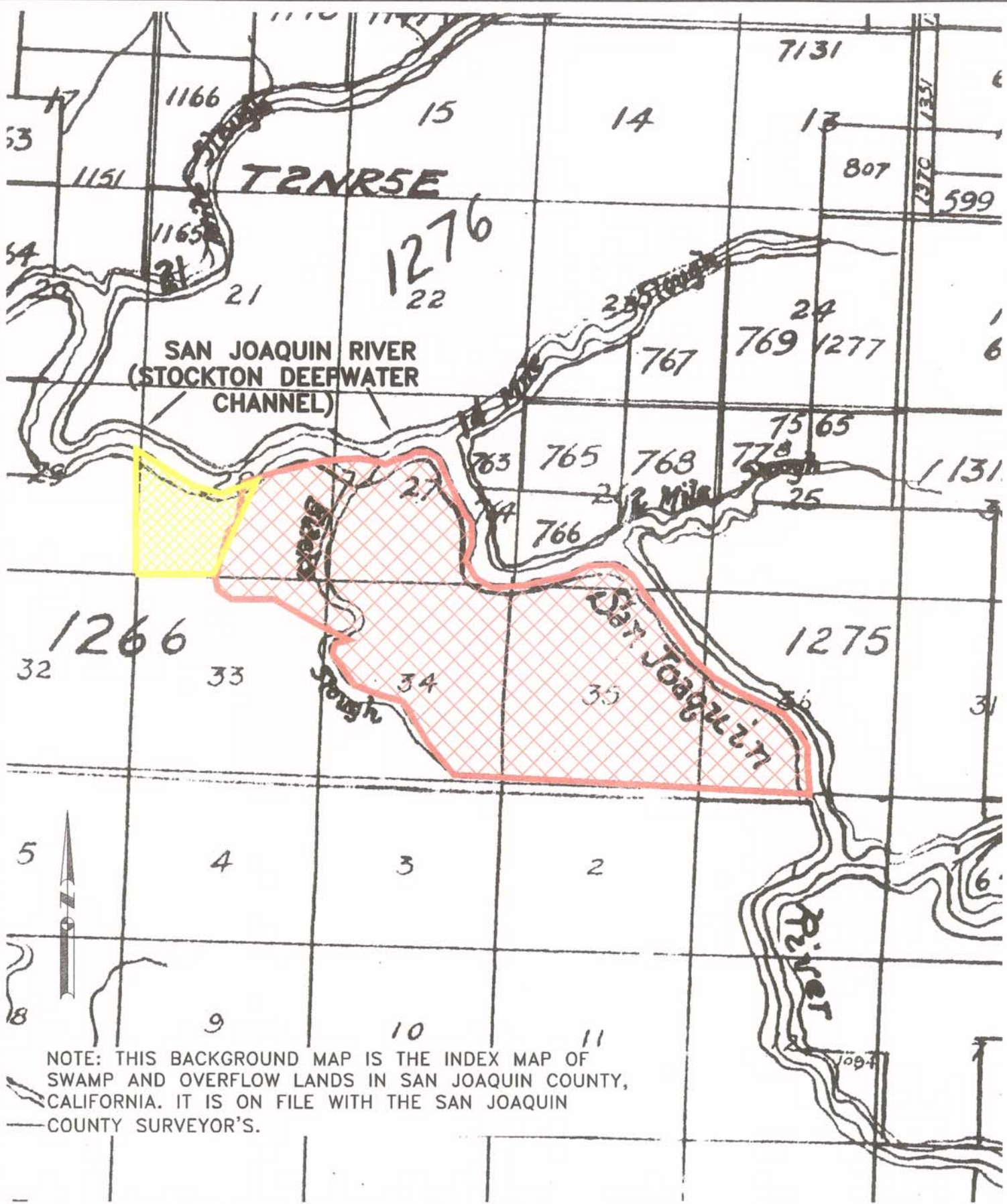

NOTE: THIS BACKGROUND MAP IS THE INDEX MAP OF SWAMP AND OVERFLOW LANDS IN SAN JOAQUIN COUNTY, CALIFORNIA. IT IS ON FILE WITH THE SAN JOAQUIN COUNTY SURVEYOR'S.

K S N KJELDSSEN SINNOCK NEUDECK INC.
 Consulting Engineers and Land Surveyors
 Post Office Box 844
 711 N. Pershing Avenue
 Stockton, CA 95201-0844
 Office: (209) 946-0268
 Faxes: (209) 946-0296
 E-mail: KSN@ksninc.com

GRANTOR: GLASGOW LAND CO.
 GRANTEE: A.J. LARSON
 GRANT DEED - 11/27/1896
CONVEYANCE EXHIBIT

Design
 Drawn SLB
 Check BAS

Scale
 1" = 4000'
 Original Drawing Scale
 0 1/4" 1/2"

Date 6/10/03
 Sheet Number 4 Of 9
 Project File No. 1084-1000

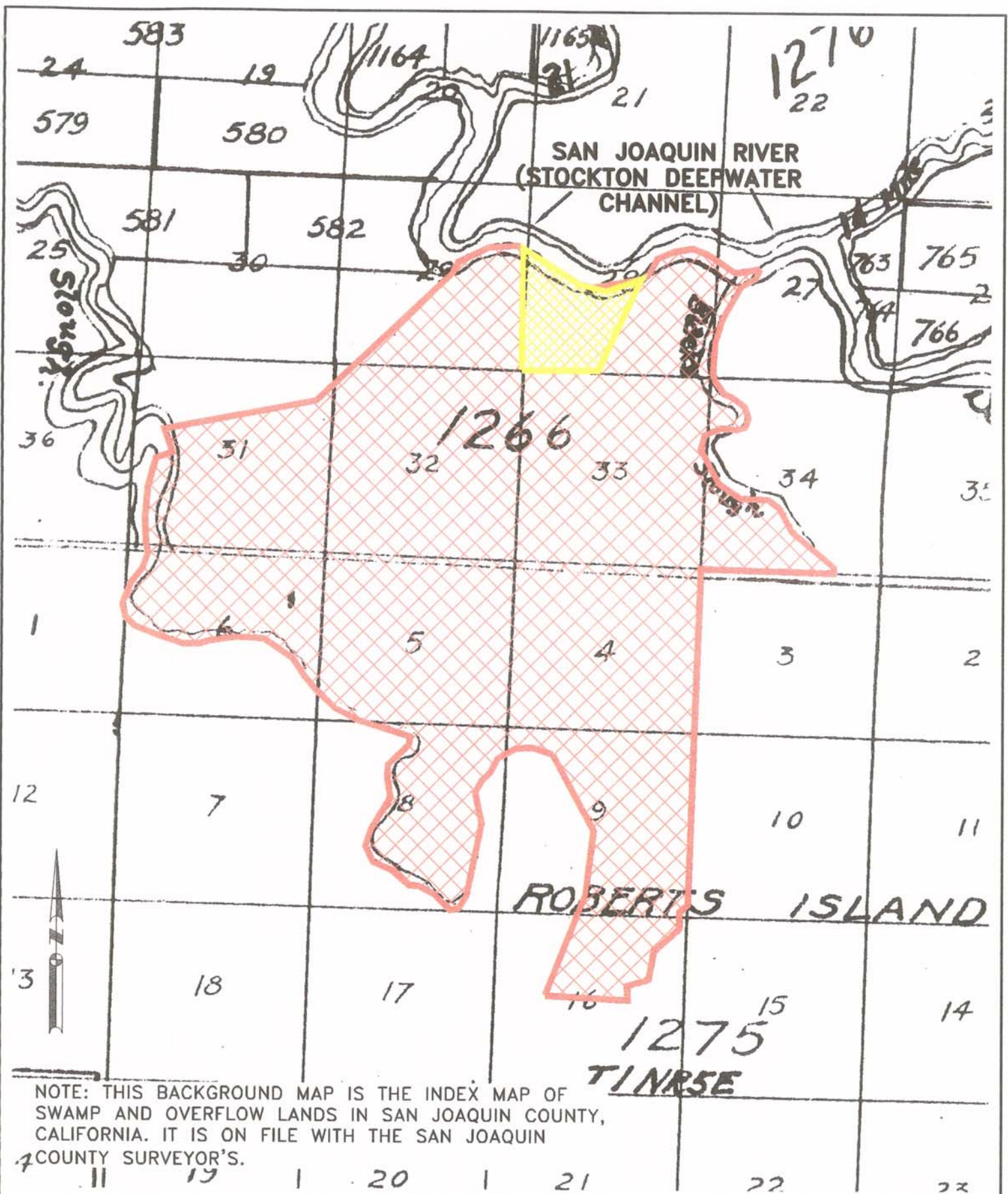

NOTE: THIS BACKGROUND MAP IS THE INDEX MAP OF SWAMP AND OVERFLOW LANDS IN SAN JOAQUIN COUNTY, CALIFORNIA. IT IS ON FILE WITH THE SAN JOAQUIN COUNTY SURVEYOR'S.

K S N KJELDSSEN
SINNOCK
NEUDECK
INC. Consulting Engineers
and Land Surveyors
Post Office Box 844
711 N. Pershing Avenue
Stockton, CA 95201-0844
Office: (209) 946-0268
Faxes: (209) 946-0296
E-mail: KSN@ksninc.com

GRANTOR: GLASCOW LAND CO.
GRANTEE: JOHN FERRIS
GRANT DEED - 01/27/1897
CONVEYANCE EXHIBIT

Design
Drawn SLB
Check BAS

Scale
1" = 4000'
Original Drawing Scale
0 1/4" 1/2"

Date
6/10/03
Sheet Number
5 of 9
Project File No.
1084-1000

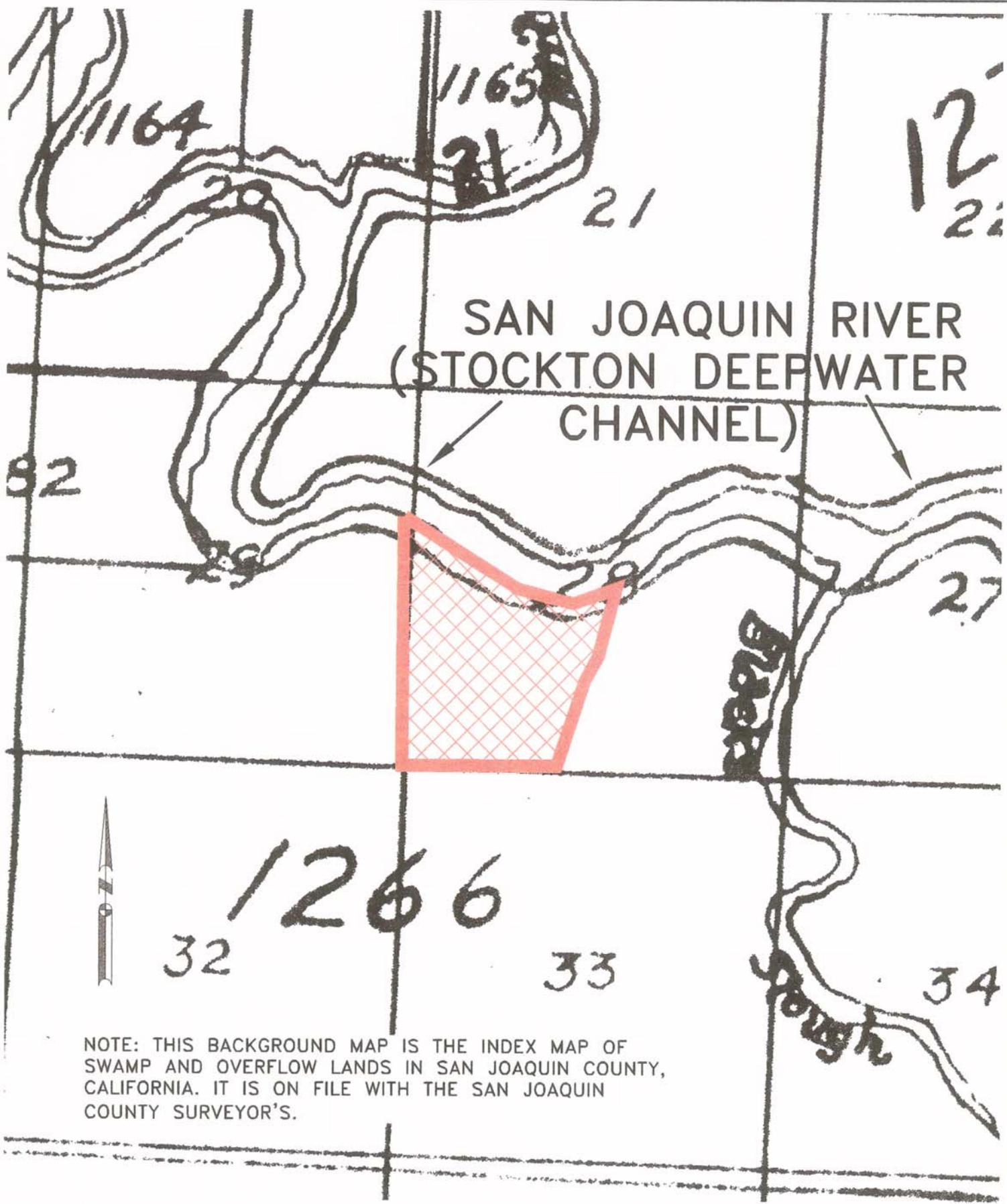

NOTE: THIS BACKGROUND MAP IS THE INDEX MAP OF SWAMP AND OVERFLOW LANDS IN SAN JOAQUIN COUNTY, CALIFORNIA. IT IS ON FILE WITH THE SAN JOAQUIN COUNTY SURVEYOR'S.

**K
S
N
INC.** **KJELSDEN
SINNOCK
NEUDECK**
Consulting Engineers
and Land Surveyors
Post Office Box 844
711 N. Pershing Avenue
Stockton, CA 95201-0844
Office: (209) 946-0268
Faxes: (209) 946-0296
E-mail: KSN@ksninc.com

**GRANTOR: JOHN FERRIS
GRANTEE: NILS HOLMQUIST**
**GRANT DEED - 12/29/1898
CONVEYANCE EXHIBIT**

Design
Drawn
SLB
Check
BAS

Scale
1" = 2000'
Original Drawing Scale
0 1/4" 1/2"

Date
6/10/03
Sheet Number
6 Of **9**
Project File No.
1084-1000

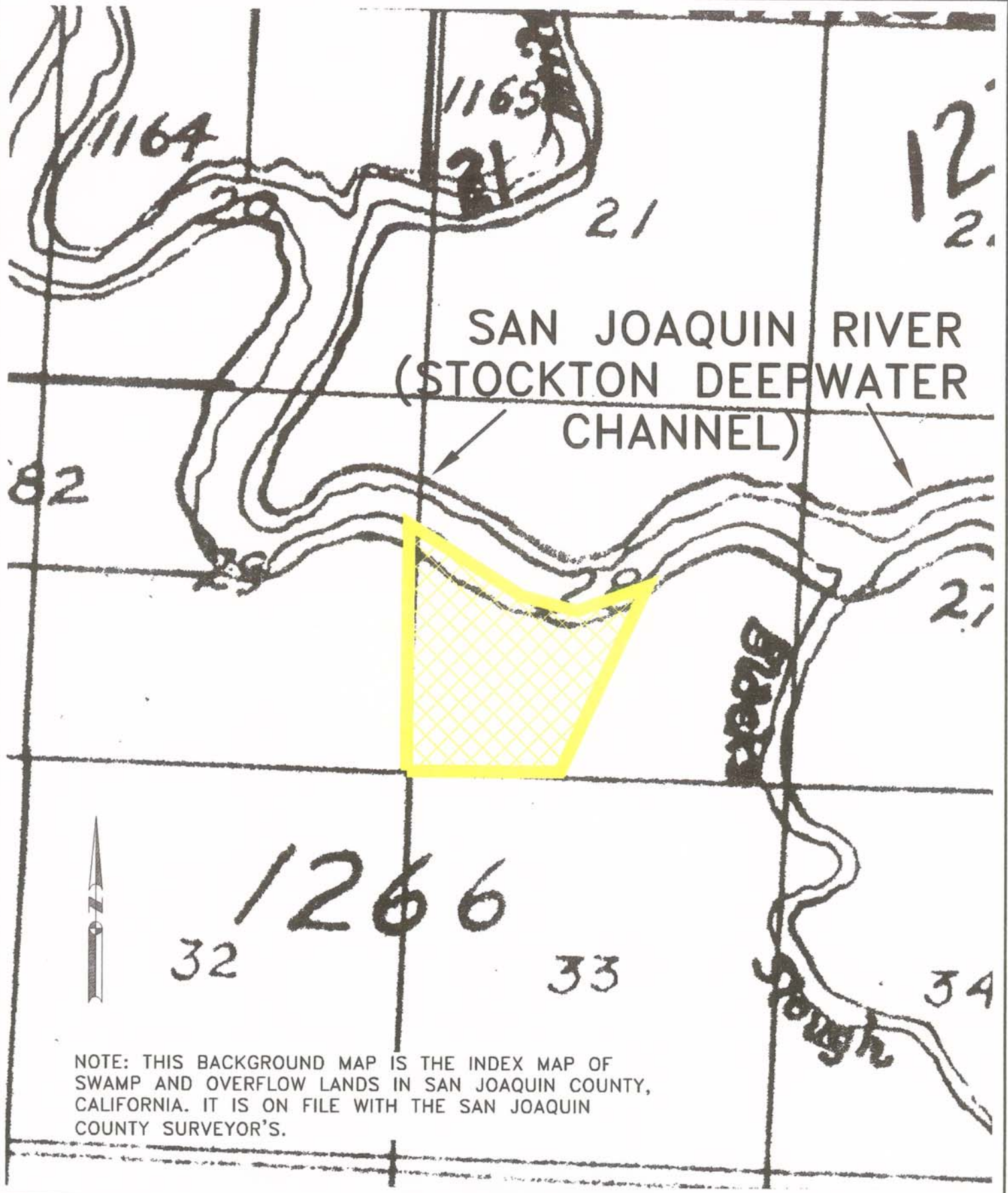

NOTE: THIS BACKGROUND MAP IS THE INDEX MAP OF SWAMP AND OVERFLOW LANDS IN SAN JOAQUIN COUNTY, CALIFORNIA. IT IS ON FILE WITH THE SAN JOAQUIN COUNTY SURVEYOR'S.

K S N INC. **KJELDEN SINNOCK NEUDECK**
Consulting Engineers and Land Surveyors

Post Office Box 844
711 N. Pershing Avenue
Stockton, CA 95201-0844
Office: (209) 946-0268
Faxes: (209) 946-0296
E-mail: KSN@ksninc.com

**BOUNDARY LINE ADJUSTMENT
EAST BOUNDARY**

**QUITCLAIM DEEDS - 7/7/1954
CONVEYANCE EXHIBIT**

Design
Drawn SLB
Check BAS

Scale
1" = 2000'
Original Drawing Scale
0 1/4" 1/2"

Date
6/10/03
Sheet Number
7 Of 9
Project File No.
1084-1000

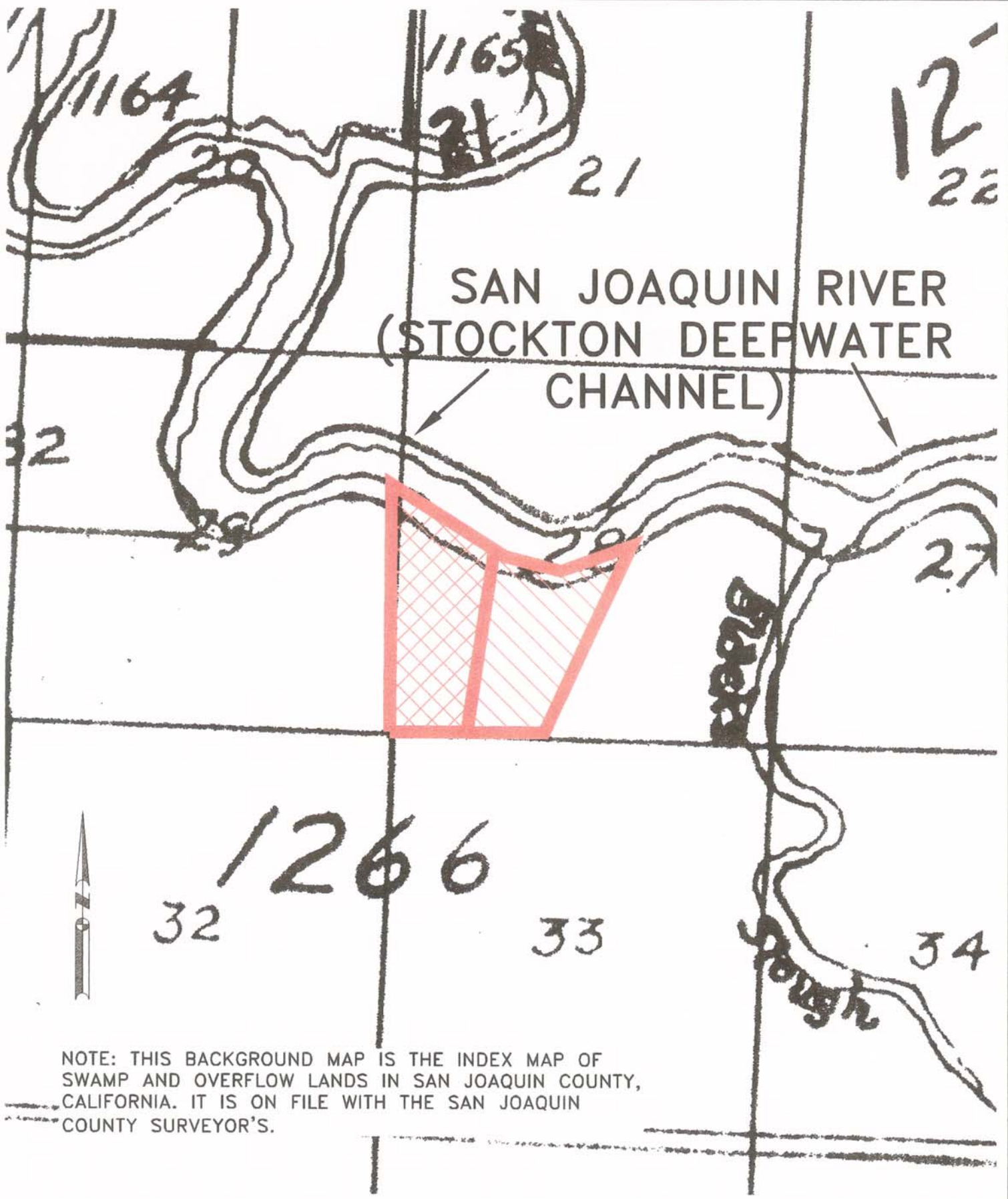

NOTE: THIS BACKGROUND MAP IS THE INDEX MAP OF SWAMP AND OVERFLOW LANDS IN SAN JOAQUIN COUNTY, CALIFORNIA. IT IS ON FILE WITH THE SAN JOAQUIN COUNTY SURVEYOR'S.

K KJELSDEN
S SINNOCK
N NEUDECK
 INC. Consulting Engineers and Land Surveyors
 Post Office Box 844
 711 N. Pershing Avenue
 Stockton, CA 95201-0844
 Office: (209) 946-0268
 Faxes: (209) 946-0296
 E-mail: KSN@ksninc.com

GRANTOR: FRANK WOLFINGER
 GRANTEE: HARRY WOLFINGER
 GRANT DEED - 6/20/1955
CONVEYANCE EXHIBIT

Design
 Drawn SLB
 Check BAS

Scale
 1" = 2000'
 Original Drawing Scale
 0 1/4" 1/2"

Date 6/10/03
 Sheet Number 8 Of 9
 Project File No. 1084-1000

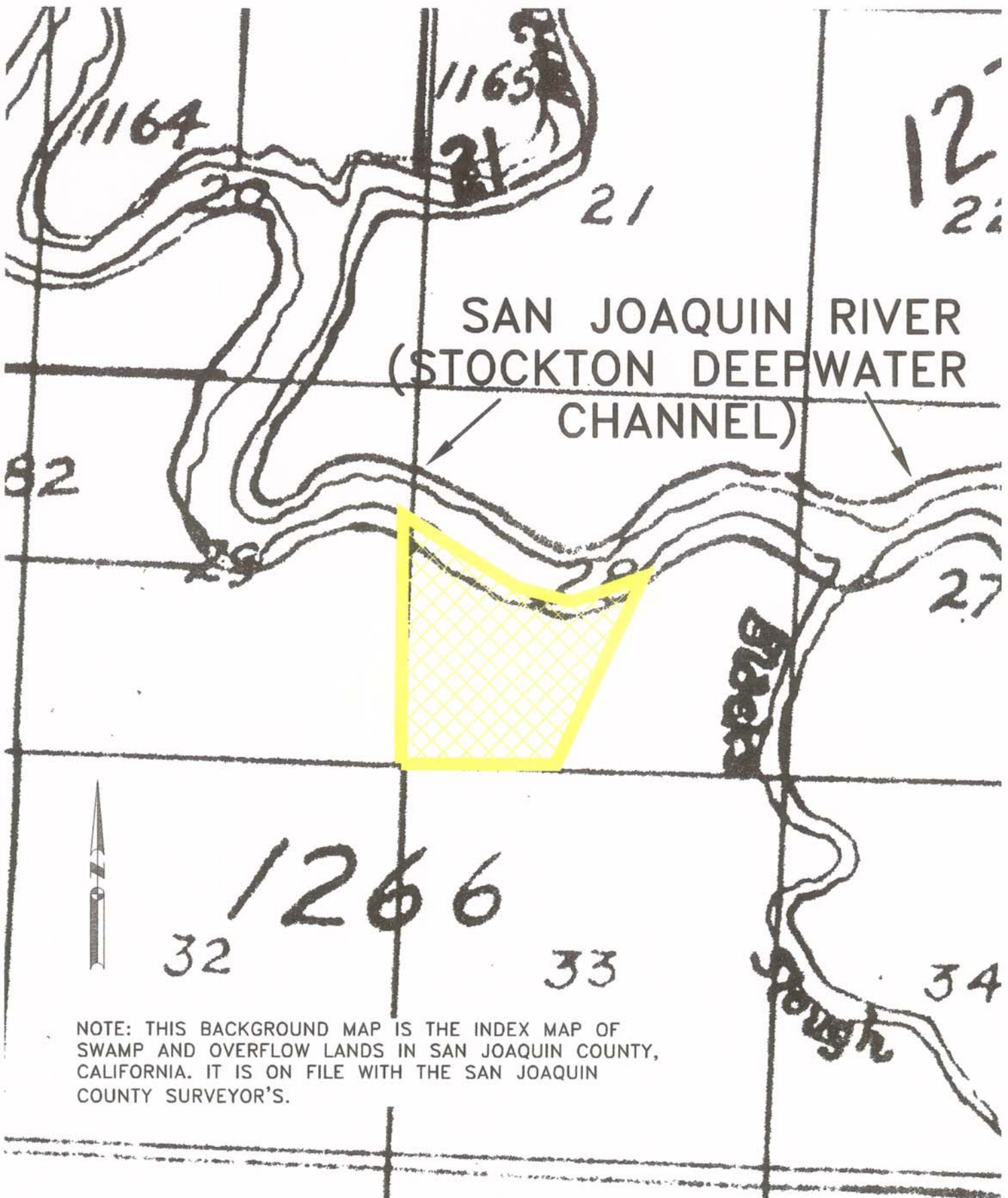

NOTE: THIS BACKGROUND MAP IS THE INDEX MAP OF SWAMP AND OVERFLOW LANDS IN SAN JOAQUIN COUNTY, CALIFORNIA. IT IS ON FILE WITH THE SAN JOAQUIN COUNTY SURVEYOR'S.

K KJELDSSEN
S SINNOCK
N NEUDECK
 INC. Consulting Engineers
 and Land Surveyors

Post Office Box 844
 711 N. Pershing Avenue
 Stockton, CA 95201-0844
 Office: (209) 946-0268
 Faxes: (209) 946-0296
 E-mail: KSN@ksninc.com

GRANTOR: LAWRENCE BUOL
 GRANTEE: ARMONDO BALDOCCHI

GRANT DEED - 10/3/1967
 CONVEYANCE EXHIBIT

Design
 Drawn
 SLB
 Check
 BAS

Scale
 1" = 2000'
 Original Drawing Scale
 0 1/4" 1/2"

Date 6/10/03
 Sheet Number 9 Of 9
 Project File No. 1084-1000