

PWM INC.

P.O. Box 1032, Eureka, CA 95502

Phone: (707) 442-8420

Fax: (707) 442-8499

Cell: (707) 499-2646

August 8, 2013

Ms. Vivian Gomez-Latino
State Water Resources Control Board
1001 I Street
P.O. Box 2231
Sacramento, CA 95812

Re: Proposed UST Case Closure: Case Number 12794.
Property Owner: Mr. Don Biasca, Don's Rent-All, 916 Broadway, Eureka, CA, County of Humboldt.

Dear Ms. Gomez-Latino:

In response to the above captioned proposed case closure, PWM Inc., as an adjacent property owner (AP No. 003-121-051), submits the attached SHN Consulting Engineers & Geologists, Inc. Boring Installation Report dated July 26, 2013 (Attachment A).

PWM requests that the State Water Resources Board respond to said report and the impact the findings have upon the proposed case closure.

PWM also requests that its classification as "Adjacent Property Owner" be changed to "Impacted Property Owner" as exemplified by the following documents which indicate that the plume includes a portion of PWM's parcel:

1. Findings of the SHN Report (Figure 2 & Table 2) dated July 26, 2013 (Attachments B1-B2).
2. The SWRCB Draft Order, "MTBE in Groundwater Map", page 10 (Attachment C).
3. SHN Request for Closure letter (Figures 9-11) dated February 17, 2010 (Attachments D1-D3).

Thank you for your consideration and response to our request.

Respectfully,



Thomas J. McMurray V
Vice President



Reference: 005287

July 26, 2013

Mr. Mark Verhey
Humboldt County Division of Environmental Health,
100 H Street, Suite 100
Eureka, CA 95501

Subject: Boring Installation Report, Don's Rent-All, 916 Broadway, Eureka, California; LOP Case No. 12794

Dear Mr. Verhey:

SHN Consulting Engineers & Geologists, Inc. (SHN) is providing you with the results of the subsurface investigation conducted for the Don's Rent-All site. This report includes a brief discussion on the background of the site, vicinity information, and a description of the work performed. This work was performed in general accordance with the work plan dated January 18, 2006. SHN performed this work on behalf of Mr. Don Biasca.

1.0 Introduction

The site is located at 916 Broadway Avenue, Eureka, in Humboldt County, California (Figure 1). The project site area is approximately 0.5 acres and is located within a portion of Assessor's Parcel Number 003-121-051, which is situated in Township 5 North, Range 1 West, Section 28 Humboldt Base and Meridian. West Washington Street borders the site to the north, Broadway Avenue to the east, a party supplies rental business to the south, and offices of Humboldt County to the west. A site plan is included as Figure 2.

1.1 Objective

The objective of this work was to install additional soil borings and well points to assess site conditions on the adjacent property with regard to the former underground storage tank at Don's Rent-All.

1.2 Scope of Work

The scope of work was designed to provide the information needed to meet the objectives of this investigation and included the following activities.

- Conduct project implementation, including drilling subcontractor and adjacent landowner coordination.
- Contact Underground Services Alert prior commencing field work.
- Install two soil borings.
- Convert two soil borings to temporary well points.
- Coordinate laboratory analyses of the soil and groundwater samples.
- Submit a report of findings.

2.0 Field Activities

2.1 Soil Borings

On July 16, 2013, SHN supervised the drilling of two soil borings (B-300 and B-301) on property adjacent to the subject site (Figure 2). Borings were advanced using a truck-mounted Geoprobe® 6600 equipped with the Geoprobe® Dual-Tube (DT-22) sampling system operated by Fisch Drilling. Borings were extended to a maximum depth of 12 feet below ground surface (BGS). All site work was performed in general accordance with SHN's January 2006 site investigation work plan (SHN, January 2006).

For each soil boring location, a hollow stainless steel sampler lined with a 1.25-inch inside diameter plastic liner was driven into the soil. Following the retrieval of each core, the plastic liner was removed from the sampler, and selected samples were cut from the desired depth and sealed on both ends with Teflon® sheets and plastic caps. Soils in the remaining core tubes were used for lithologic descriptions. Each soil sample was labeled with the project name, project number, sample number, sample depth, sample time, and sample date. All of the samples were placed in Ziploc® bags and stored in an iced cooler. Each soil sample was analyzed for constituents described in "Section 2.3: Laboratory Analysis." Sample handling, transport, and delivery to the analytical laboratory were documented using proper chain-of-custody procedures.

Three soil samples were collected from each boring. Field notes and soil boring logs are included in Attachment 1.

2.2 Groundwater Sampling

Following completion of soil borings B-300 and B-301, each boring was converted to a temporary well point for the collection of a groundwater sample. The well points were constructed using a 3/4-inch inside-diameter polyvinyl chloride (PVC) casing and a 0.010-inch slotted well screen.

Well points B-300 and B-301 were purged and sampled using a peristaltic pump and new disposable tubing. The groundwater samples were decanted directly into laboratory-supplied sample containers, placed in an iced cooler, and transported under chain-of-custody documentation to a State of California-certified analytical laboratory for chemical analysis of constituents described in the "Laboratory Analysis" section.

Following groundwater sample collection, the well point materials were removed from each boring. Each borehole was backfilled with neat cement and completed at grade to match existing site conditions.

2.3 Laboratory Analysis

Each soil and groundwater sample was analyzed for:

- total petroleum hydrocarbons as motor oil (TPHMO) and as diesel (TPHD) in general accordance with United States Environmental Protection Agency (EPA) Method No. 8015B.;

- total petroleum hydrocarbons as gasoline TPHG in general accordance with EPA Method No. 8260B.; and
- benzene, toluene, ethylbenzene, total xylenes (BTEX) and methyl tertiary-butyl ether (MTBE) in general accordance with EPA Method No. 8260B.

North Coast Laboratories, Inc., a State of California-certified analytical laboratory located in Arcata, California, conducted all analyses.

2.5 Equipment Decontamination Procedures

All boring and well installation equipment was cleaned prior to bringing it onsite. All drilling equipment and small equipment that required onsite cleaning was cleaned using the triple wash system. The equipment was first washed in a water solution containing Liquinox® cleaner, followed by a two distilled water rinses.

2.6 Investigation-Derived Waste Management

Water used in the decontamination of equipment, tools, and purge water was temporarily contained in five-gallon buckets and transported to SHN's purge water storage facility and will be discharged, under permit, to the City of Eureka wastewater collection system. Approximately two gallons of decontamination and purge water was generated during well point installation and sampling. A Discharge receipt will be included in a future report.

No soil cuttings are generated using the Geoprobe® Dual-Tube (DT-22) sampling system.

3.0 Results of the Investigation

3.1 Soil Sample Analytical Results

Soil sample analytical results for the July 16, 2013, drilling activities are summarized in Table 1.

Table 1 Soil Analytical Results, July 16, 2013 Don's Rent-All, Eureka, California (in mg/kg)¹								
Sample Location & Depth (feet BGS) ²	TPHD ³	TPHMO ³	TPHG ⁴	Benzene ⁴	Toluene ⁴	Ethylbenzene ⁴	Total xylenes ⁴	MTBE ⁴
B-300@4 ft	<1.0 ⁵	<10	<1.0	<0.0050	<0.0050	<0.0050	<0.015	<0.025
B-300@8 ft	<1.0	<10	<1.0	<0.0050	<0.0050	<0.0050	<0.015	<0.025
B-300@12 ft	<1.0	<10	<1.0	<0.0050	<0.0050	<0.0050	<0.015	<0.025
B-301@4 ft	<1.0	13 ⁶	<1.0	<0.0050	<0.0050	<0.0050	<0.015	<0.025
B-301@8 ft	<1.0	<10	<1.0	<0.0050	<0.0050	<0.0050	<0.015	<0.025
B-301@12 ft	<1.0	<10	<1.0	<0.0050	<0.0050	<0.0050	<0.015	<0.025

Table 1 Soil Analytical Results, July 16, 2013 Don's Rent-All, Eureka, California (in mg/kg)¹								
Sample Location & Depth (feet BGS) ²	TPHD ³	TPHMO ³	TPHG ⁴	Benzene ⁴	Toluene ⁴	Ethylbenzene ⁴	Total xylenes ⁴	MTBE ⁴
1. mg/kg: milligrams per kilogram 2. BGS: below ground surface 3. Total petroleum hydrocarbons as diesel (TPHD) and motor oil (TPHMO), analyzed in general accordance with EPA Method No. 8015B 4. Total petroleum hydrocarbons as gasoline (TPHG), benzene (B), toluene (T), ethylbenzene (E), total xylenes (X), and methyl tertiary-butyl ether (MTBE) analyzed in general accordance with EPA Method No. 8260B or 8260B Modified 5. <: "less than" the stated method reporting limit 6. The sample does not have the typical pattern of fresh motor oil. However, the result reported represents the amount of material in the motor oil range.								

Historical soil analytical data is presented in Attachment 2. The complete analytical reports, chain-of-custody, and laboratory quality control data are included in Attachment 3.

3.2 Temporary Well Point Analytical Results

The laboratory analytical results for the temporary well point samples collected on July 16, 2013, are summarized in Table 2.

Table 2 Temporary Well-Point Groundwater Analytical Results, July 16, 2013 Don's Rent-All, Eureka, California (in ug/L)¹								
Sample Location	TPHD ²	TPHMO ²	TPHG ³	Benzene ³	Toluene ³	Ethylbenzene ³	Total xylenes ³	MTBE
B-300	<50 ⁴	<170	<50	<0.50	<0.50	<0.50	<1.0	2.6
B-301	<50	<170	<50	<0.50	<0.50	<0.50	<1.0	24
1. ug/L: micrograms per liter 2. Total petroleum hydrocarbons as diesel (TPHD) and motor oil (TPHMO), analyzed in general accordance with EPA Method No. 8015B 3. Total petroleum hydrocarbons as gasoline (TPHG), benzene, toluene, ethylbenzene, m,p and -o-xylenes, analyzed in general accordance with EPA Method No. 8260B or 8260B Modified 4. <: "less than" the stated method reporting limit								

Historical groundwater analytical data is presented in Attachment 2. The complete laboratory test results and corresponding chain-of-custody documentation are included in Attachment 3.

Mark Verhey

Boring Installation Report, Don's Rent-All, 916 Broadway, Eureka, California; LOP Case No. 12794

July 26, 2013

Page 5

If you have any questions regarding the work completed, please call me at 707-441-8855.

Sincerely,

SHN Consulting Engineers & Geologists, Inc.

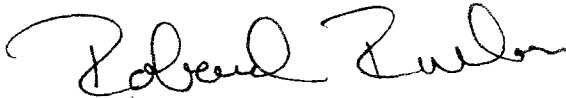

Roland Rueber, PG
Project Manager

RMR/BGH:dla

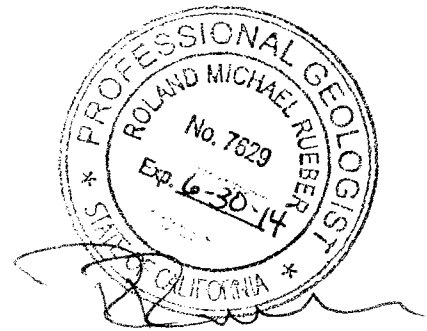

- Attachments:
1. Field Notes and Boring Logs
 2. Historical Data
 3. Laboratory Analytical Report

c. w/attach: Russ Biasca, Don's Rent-All
Tom McMurray, PWM Inc.
Ben Heningburg, State Water Resources Control Board

References Cited

City of Eureka Department of Public Works. (NR). Map of City of Eureka, California Showing Original Water Courses and Filled Areas (1854-1955). Eureka: City of Eureka Public Works Department.

SHN Consulting Engineers & Geologists, Inc. (January 2006). (January 2006). *UST Removal Report of Findings and Site Investigation Work Plan, Don's Rent-All, 916 Broadway, Eureka, California, Case No. 12794*. Eureka: SHN

United States Geological Survey. (NR). "Eureka 7.5-Minute Quadrangle." NR: USGS.

LA 2005\005287\DCONS.SAVED: 7/22/2013 10:09 AM, NATHAN DOWNEY

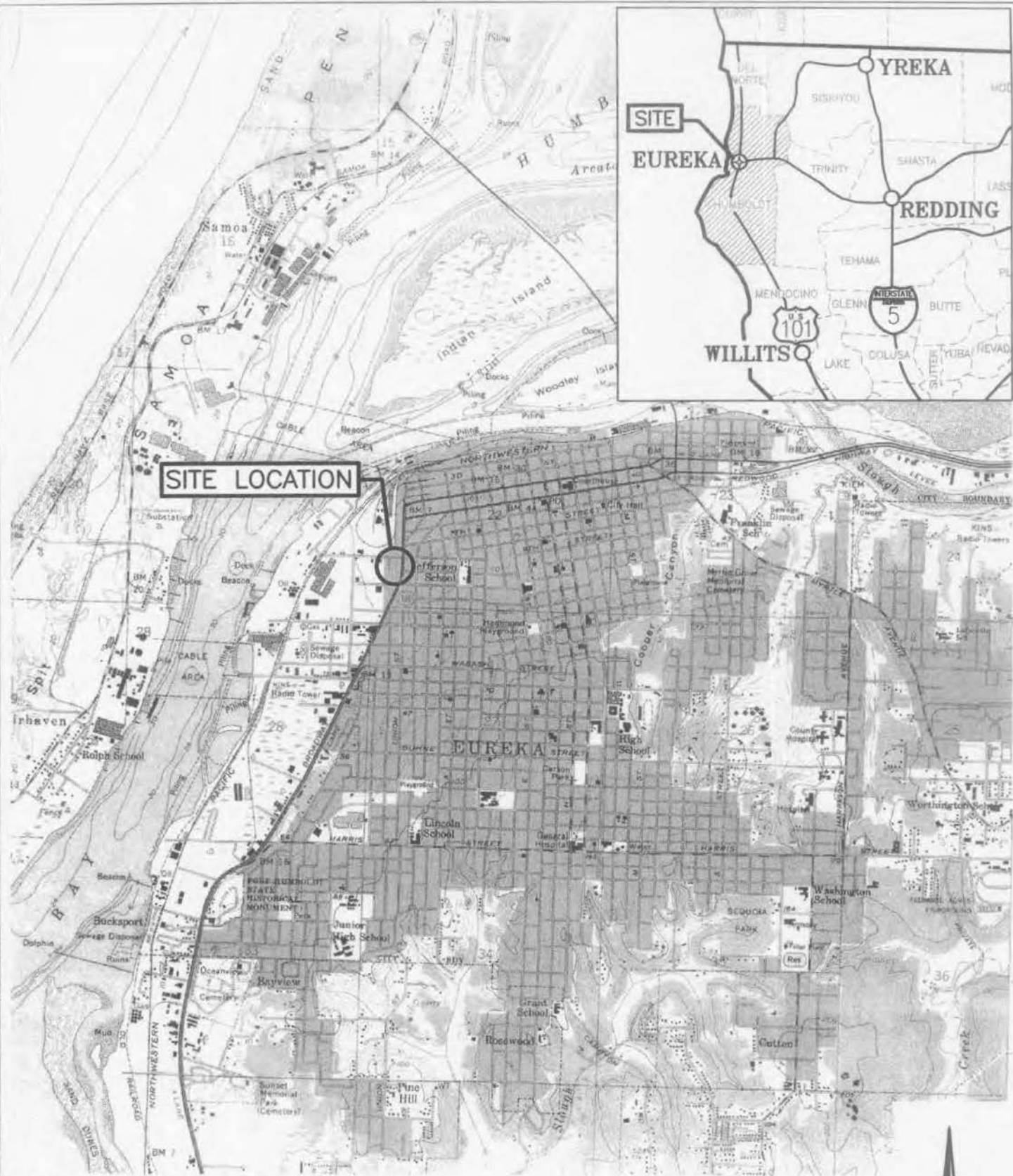

SOURCE: EUREKA USGS
7.5 MINUTE QUADRANGLE

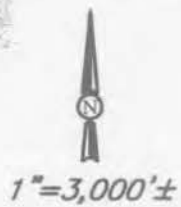

Consulting Engineers
& Geologists, Inc.

Don's Rent-All
916 Broadway Ave
Eureka, California

July 2013

005287-SITE-LCTN

Site Location Map

SHN 005287

Figure 1

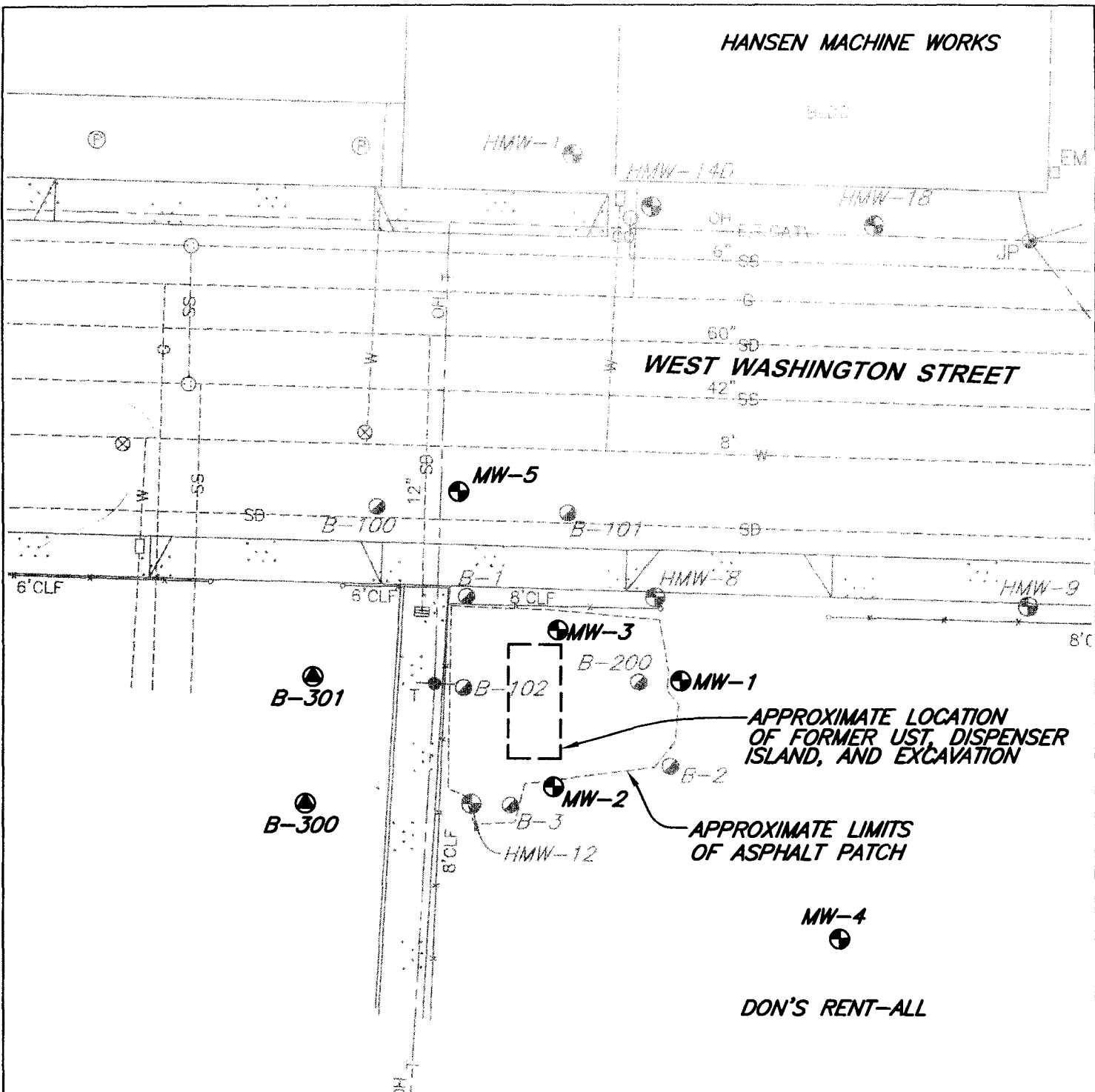

EXPLANATION

-  **HANSEN MONITORING WELL LOCATION AND DESIGNATION**
HMW-8
-  **DON'S RENT-ALL MONITORING WELL LOCATION AND DESIGNATION**
MW-2
-  **SOIL BORING LOCATION AND DESIGNATION (LOCATION APPROXIMATE)**
B-101
-  **SOIL BORING/ TEMPORARY WELL POINT LOCATION AND DESIGNATION**
B-300

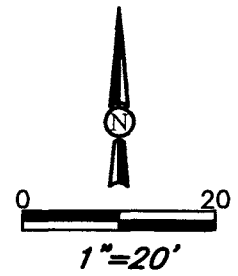

 Consulting Engineers & Geologists, Inc.	Don's Rent-All 916 Broadway Ave Eureka, California	Site Plan SHN 005287
	July 2013	005287-SITE



PROJ. NAME: Don's Rent All
 PROJ. NUMBER: 005287
 DRILLER: Fisch Environmental
 DRILLING METHOD: GeoProbe
 SAMPLER TYPE: DT-22
 LOGGED BY: B Howell

LOCATION: Eureka
 GROUND ELEV.: --
 DEPTH OF BORING/WELLPOINT: 12 Feet
 INITIAL WATER LEVEL: 6.25 Feet
 STABILIZED WATER LEVEL: --
 DATE: 7/16/13

SOIL BORING LOG
B-300

ELEVATION (ft) DEPTH (FT.)	WATER LEVEL	SAMPLE % RECOVERY DRILLING LABORATORY	OVA	LITHOLOGY	USCS	SOIL DESCRIPTION	REMARKS	WELLPOINT CONSTRUCTION
-------------------------------	-------------	--	-----	-----------	------	------------------	---------	---------------------------

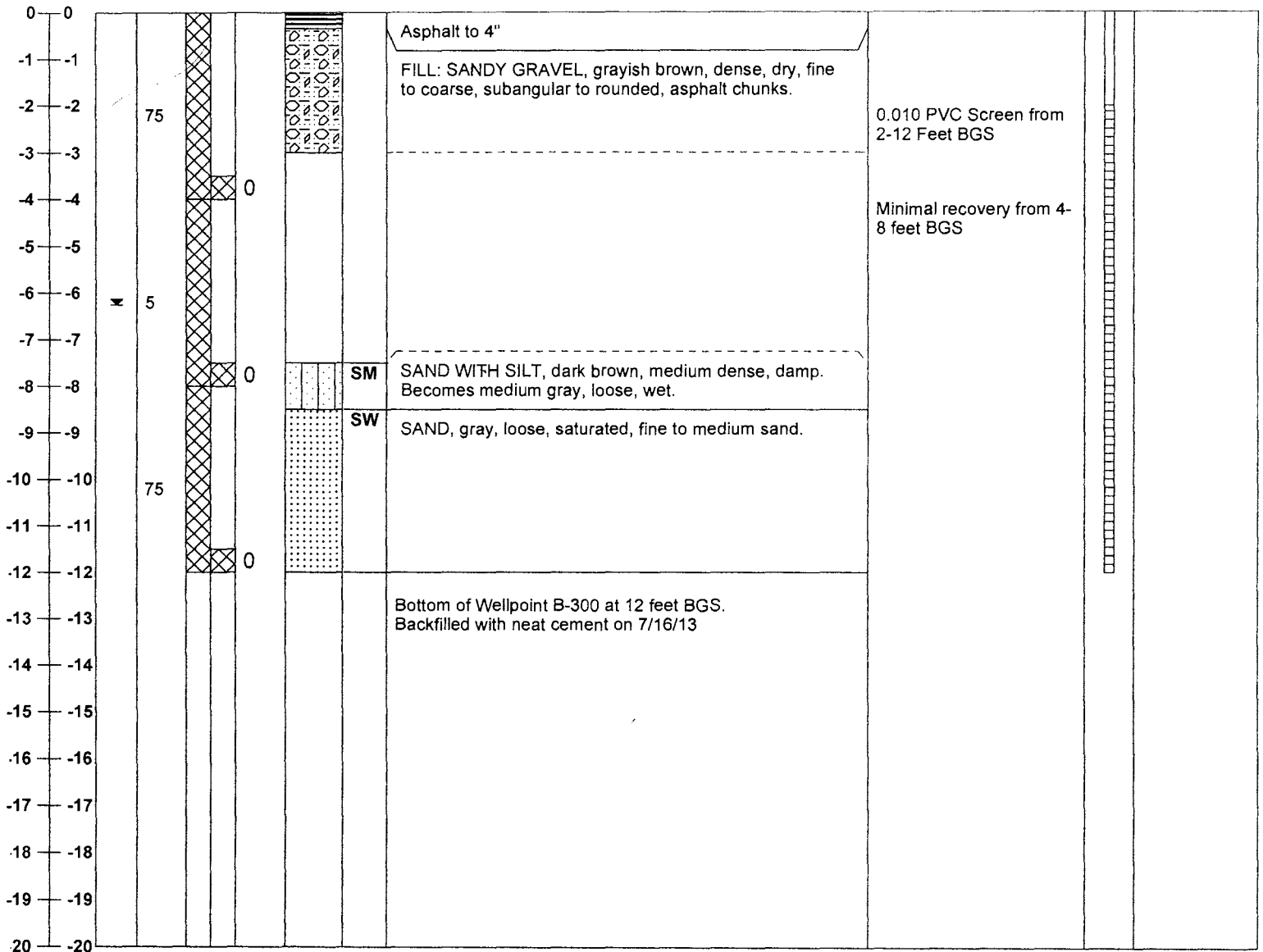



PROJ. NAME: Don's Rent All
 PROJ. NUMBER: 005287
 DRILLER: Fisch Environmental
 DRILLING METHOD: GeoProbe
 SAMPLER TYPE: DT-22
 LOGGED BY: B Howell

LOCATION: Eureka
 GROUND ELEV.: --
 DEPTH OF BORING/WELLPOINT: 12 Feet
 INITIAL WATER LEVEL: 5.6 Feet
 STABILIZED WATER LEVEL: --
 DATE: 7/16/13

SOIL BORING LOG
B-301

ELEVATION (ft) DEPTH (FT.)	WATER LEVEL	SAMPLE % RECOVERY DRILLING LABORATORY	OVA	LITHOLOGY	USCS	SOIL DESCRIPTION	REMARKS	WELLPOINT CONSTRUCTION
-------------------------------	-------------	--	-----	-----------	------	------------------	---------	---------------------------

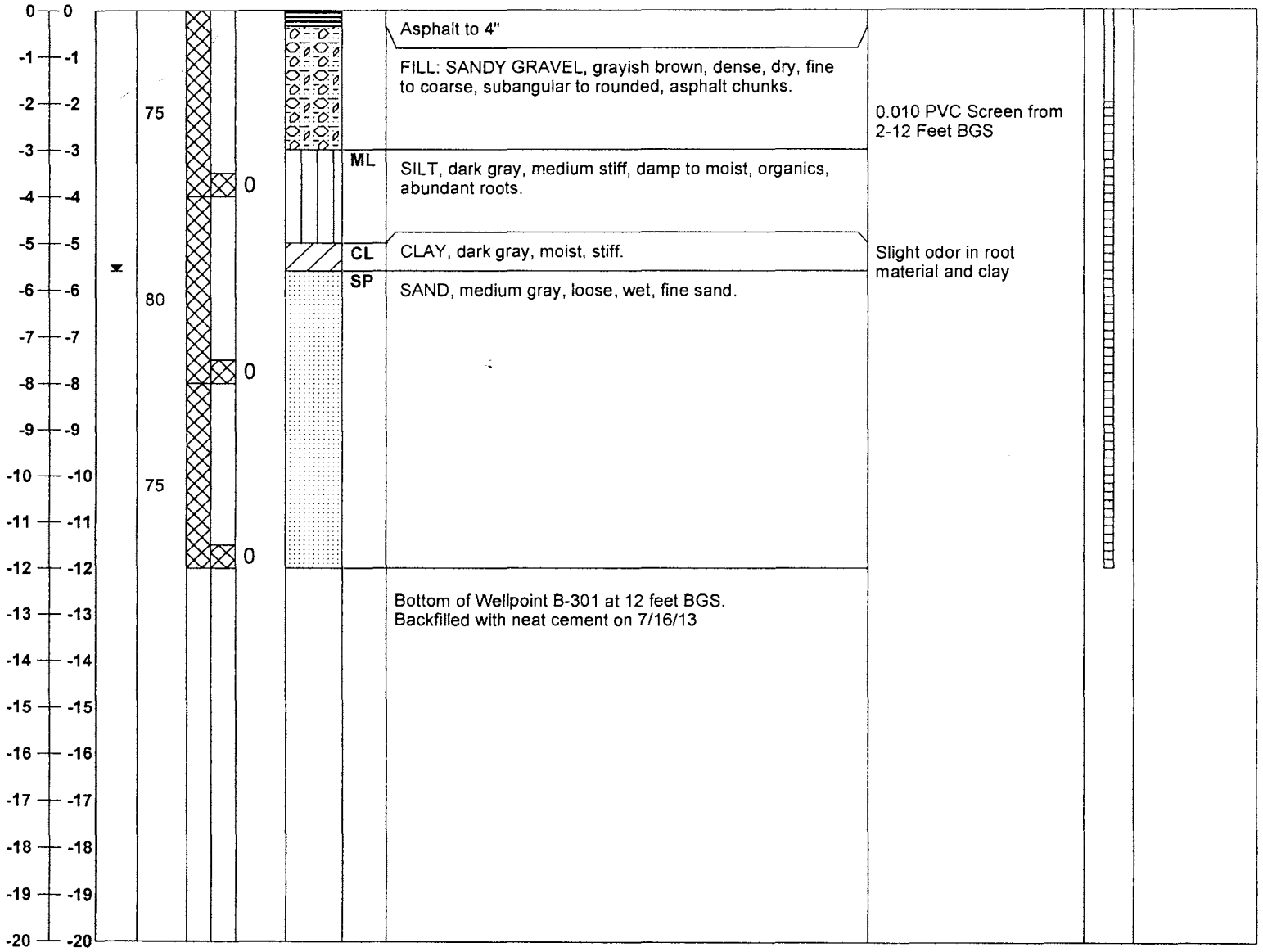



Equipment Calibration Sheet

Name: B. Howell

Project Name: Don's Rent-All

Reference No.: 005287

Date: 7/16/13

Equipment: ~~pH & EC~~ PID GTCO₂ GTLEL
 Turbidity ~~Other Dissolved Oxygen Meter~~

Description of Calibration Procedure and Results:

~~pH & EC meter calibrated using a 2 buffer method with a pH 7.00 and 4.01. Meter was set exactly to 7.00 and 4.01~~

~~Dissolved Oxygen Meter is self calibrating with the Altimeter set at~~

Calibrated PID w/ 100 ppm gas standard

Table 2-1
Soil Analytical Results, April 16, 2004
Don's Rent-All, Eureka, California
(in mg/kg)¹

Sample Location@ Depth (feet BGS) ²	TPHMO ³	TPHD ³	TPHG ³	B ⁴	T ⁴	E ⁴	X ⁴	MTBE ⁴
B-1 @ 3.0'	300	67	3.6	<0.0050 ⁵	<0.0050	<0.0050	<0.0050	<0.0050
B-2 @ 4.0'	420	71	12	<0.0050	<0.0050	<0.0050	0.0063	0.018
B-3 @ 5.5'	5.5	42	5.1	<0.0050	<0.0050	<0.0050	0.0056	0.086

1. mg/kg: milligrams per kilogram
2. BGS: below ground surface
3. Total petroleum hydrocarbons as motor oil (TPHMO), as diesel (TPHD), as gasoline (TPHG) analyzed in general accordance with EPA Method No. 8015M
4. Benzene (B), toluene (T), ethylbenzene (E), total xylenes (X), and methyl tertiary-butyl ether (MTBE) analyzed in general accordance with EPA Method No. 8260B
5. <: "less than" the stated method reporting limit

Table 2-2
Groundwater Analytical Results, April 16, 2004
Don's Rent-All, Eureka, California
(in ug/L)¹

Sample Location	TPHMO ²	TPHD ²	TPHG ²	B ³	T ³	E ³	X ³	MTBE ³	FO ⁴
B-1	230	290	5,800	230	<30 ⁵	100	590	350	ND ⁶
B-2	270	370	9,400	74	16	530	2,100	140	ND
B-3	2,700	600	450	13	4.1	12	71	140	ND
HMW-9 ⁷	240	5,000	73,000	3,100	1,600	2,200	11,000	2,800	ND
HMW-12 ⁷	<100	<50	490	74	130	<50	<50	3,800	ND

1. ug/L: micrograms per liter
2. Total petroleum hydrocarbons as motor oil (TPHMO), as diesel (TPHD), as gasoline (TPHG) analyzed in general accordance with EPA Method No. 8015M
3. Benzene (B), toluene (T), ethylbenzene (E), total xylenes (X), and methyl tertiary-butyl ether (MTBE) analyzed in general accordance with EPA Method No. 8260
4. FO: fuel oxygenates, analyzed in general accordance with EPA Method No. 8260
5. <: "less than" the stated method reporting limit
6. ND: not detected
7. HMW: Hansen Machine Works well. HMW-9 sample actually from HMW-8.

Table 2-3
Excavation Sidewall Soil Analytical Results, August 10, 2005
Don's Rent-All, Eureka, California
(in mg/kg)¹

Sample Location	Oil & Grease ²	TPHD ³	TPHG ³	B ⁴	T ⁴	E ⁴	X ⁴	Cd ⁵	Cr ⁵	Pb ⁵	Ni ⁵	Zn ⁵
Tank Pit North	250	99	550	1.8	6.3	11	44	<1.0 ⁶	50	<5.0	58	85
Tank Pit South	200	10	13	<0.0050	<0.0050	<0.0050	0.0098	<1.0	76	<5.0	70	53
Tank Pit East	150	36	87	0.68	1.1	4.3	12	<1.0	42	<5.0	42	33
Tank Pit West	180	58	300	0.9	0.23	6.9	26	<1.0	57	<5.0	57	60

1. mg/kg: milligrams per kilogram
2. Oil and grease analyzed in general accordance with EPA Method 9071B
3. Total petroleum hydrocarbons as diesel (TPHD) and as gasoline (TPHG) analyzed in general accordance with EPA Method No. 8015M
4. Benzene (B), toluene (T), ethylbenzene (E), and total xylenes (X) analyzed in general accordance with EPA Method No. 8260B
5. Cd: cadmium, Cr: chromium, Pb: lead, Ni: nickel, and Zn: zinc analyzed in general accordance with EPA Method No. 6010
6. <: "less than" the stated method reporting limit

Table 2-4
Water Holding Tank Analytical Results, August 11, 2005
Don's Rent-All, Eureka, California
(in mg/kg)¹

Sample Location	Oil & Grease ²	TPHD ³	TPHG ³	B ⁴	T ⁴	E ⁴	X ⁴	Cd ⁵	Cr ⁵	Pb ⁵	Ni ⁵	Zn ⁵
Holding Tank #4	<5.0 ⁶	1,400	47,000	180	920	110	8,700	<0.010	<0.050	<0.050	<0.10	<0.10

1. mg/kg: milligrams per kilogram

2. Oil and grease analyzed in general accordance with EPA Method 9071B

3. Total petroleum hydrocarbons as diesel (TPHD) and as gasoline (TPHG) analyzed in general accordance with EPA Method No. 8015M

4. Benzene (B), toluene (T), ethylbenzene (E), and total xylenes (X) analyzed in general accordance with EPA Method No. 8260B

5. Cd: cadmium, Cr: chromium, Pb: lead, Ni: nickel, and Zn: zinc analyzed in general accordance with EPA Method No. 6010

6. <: "less than" the stated method reporting limit

Table 2-5
Soil Analytical Results, July 20, 2006
Don's Rent-All, Eureka, California
(in ug/g)¹

Sample Location @ Depth (feet BGS) ²	TPHMO ³	TPHD ³	TPHG ³	B ⁴	T ⁴	E ⁴	X ⁴	MTBE ⁴
B-100@ 3-3.5'	510 ⁵	260 ⁵	54	<0.0050 ⁶	0.0095	<0.0050	<0.020	<0.050
B-100@ 6.8-7.3'	31 ⁵	4.2 ⁵	4.4	<0.0050	<0.010	<0.0050	<0.015	<0.050
B-100@ 11-12'	<10	<1.0	<1.0	<0.0050	<0.0050	<0.0050	<0.0050	<0.050
B-101@ 2-2.5'	83 ⁵	13 ⁵	15	0.031	0.11	<0.020	0.029	0.15
B-101@ 7-8'	<10	<1.0	3.9	0.012	0.025	<0.0050	0.062	0.76
B-102 @ 3-3.5'	<10	<1.0	<1.0	<0.0050	<0.0050	<0.0050	<0.0050	<0.050
B-102@ 7-7.5'	<10	<1.0	4.2	0.0071	0.019	0.015	0.0961	<0.050
MW-1@ 3-3.5'	4,400 ⁵	570 ⁵	180	0.09	0.76	1.1	1.38	<0.050
MW-1@ 7.5-8.0'	39 ⁵	14 ⁵	240	0.17	3.4	3.7	20.7	1.2
MW-2@ 3-3.5'	650 ⁵	190 ⁵	3.4	<0.0050	0.015	0.014	0.055	<0.050
MW-2@ 7-7.5'	<10	<1.0	11	0.09	0.066	0.14	0.423	0.16
MW-3@ 3-3.5'	<10 ⁵	3.0 ⁵	<1.0	<0.0050	<0.0050	<0.0050	<0.0050	<0.050
MW-3@ 7-7.5'	<10 ⁵	<1.0 ⁵	1,000	0.97	11	25	99	3.9

1. ug/g: micrograms per gram
2. BGS: below ground surface
3. Total petroleum hydrocarbons as motor oil (TPHMO), as diesel (TPHD), and as gasoline (TPHG) analyzed in general accordance with EPA Method No. 8015B
4. Benzene (B), toluene (T), ethylbenzene (E), xylenes (X), and methyl tertiary-butyl ether (MTBE) analyzed in general accordance with EPA Method 8021B
5. Sample subjected to silica gel cleanup.
6. <: "less than" the stated method reporting limit

Table 2-6
Groundwater Analytical Results, July 20, 2006
Don's Rent-All, Eureka, California
(in ug/L)¹

Sample Location	TPHMO²	TPHD²	TPHG³	B³	T³	E³	X³	MTBE³
B-100	190 ⁴	<50 ^{4,5}	2,200	<0.50	<0.50	<0.50	1.45	2,700
B-101	<170 ⁴	170 ⁴	4,400	55	4.8	20	21.9	190
B-102	<170	<50	160	1.0	<0.50	<0.50	0.91	15
MW-3 ⁶	<170 ⁴	210 ⁴	14,000	35	420	380	2,220	<30

1. ug/L: micrograms per liter
2. Total petroleum hydrocarbons as motor oil (TPHMO) and as diesel (TPHD) analyzed in general accordance with EPA Method No. 8015B
3. Total petroleum hydrocarbons as gasoline (TPHG), benzene (B), toluene (T), ethylbenzene (E), xylenes (X), and methyl tertiary-butyl ether (MTBE) analyzed in general accordance with EPA Method No. 8260B
4. Sample subjected to silica gel cleanup.
5. <: "less than" the stated method reporting limit
6. Groundwater sample obtained from temporary wellpoint advanced within the MW-3 boring and screened from 18-20 feet below ground surface.

Table 2-7
Soil Analytical Results, October 31 and November 1, 2007
Don's Rent-All, Eureka, California
(in ug/g)¹

Sample Location @ Depth (feet BGS) ²	TPHMO ³		TPHD ³		TPHG ³	B ⁶	T ⁶	E ⁶	X ⁶	MTBE ⁶
	Pre ⁴	Post ⁵	Pre ⁴	Post ⁵						
MW-4@ 3.5-4.0'	410	690	110	58	1.7	0.013	0.063	0.016	0.063	<0.050 ⁷
MW-4@ 7.5-8.0'	<10	<10	2.2	<1.0	<1.0	<0.0050	0.013	<0.0050	0.0078	<0.050
MW-4@ 11.5-12.0'	<10	<10	1.6	<1.0	<1.0	<0.0050	<0.0050	<0.0050	<0.0050	<0.050
MW-4@ 15.5-16.0'	<10	<10	1.3	<1.0	<1.0	<0.0050	0.0092	<0.0050	<0.0050	<0.050
MW-5@ 7.5-8.0'	<10	<10	1.6	<1.0	3.3	0.017	0.030	0.023	0.054	<0.050
MW-5@ 11.5-12.0'	<10	<10	1.7	<1.0	<1.0	<0.0050	0.011	<0.0050	0.017	<0.050
MW-5@ 15.5-16.0'	<10	<10	1.9	<1.0	<1.0	<0.0050	0.017	<0.0050	0.0082	<0.050
B-200@ 10.0-11.0'	<10	<10	2.3	<1.0	4.4	0.0061	0.041	0.021	0.065	<0.050
B-200@ 17.0-18.0'	11	<10	3.8	<1.0	<1.0	<0.0050	0.0053	<0.0050	0.012	<0.050
B-200@ 25.0-26.0'	11	<10	3.4	<1.0	<1.0	<0.0050	<0.0050	<0.0050	<0.0050	<0.050

1. ug/g: micrograms per gram
2. BGS: below ground surface
3. Total petroleum hydrocarbons as motor oil (TPHMO), as diesel (TPHD), and as gasoline (TPHG) analyzed in general accordance with EPA Method No. 8015B
4. Sample not subjected to silica gel cleanup.
5. Sample subjected to silica gel cleanup.
6. Benzene (B), toluene (T), ethylbenzene (E), xylenes (X), and methyl tertiary-butyl ether (MTBE) analyzed in general accordance with EPA Method No. 8021B
7. <: "less than" the stated method reporting limit

Table 2-8
Groundwater Analytical Results, November 1, 2007
Don's Rent-All, Eureka, California
(in ug/L)¹

Sample Location @ Depth (feet BGS) ²	TPHMO ³		TPHD ³		TPHG ³	B ⁶	T ⁶	E ⁶	X ⁶	MTBE ⁶
	Pre ⁴	Post ⁵	Pre ⁴	Post ⁵						
B-200@ 5.0-6.0'	<170 ⁷	<170	67	76	470	2.5	2.3	0.60	2.8	130
B-200@ 10.0-11.0'	<170	<170	260	<50	2,200	10	12	3.2	8.8	78
B-200@ 17.0-18.0'	<170	NA ⁸	<50	NA	<50	<0.50	<0.50	<0.50	<0.50	3.3
B-200@ 25.0-26.0'	<170	NA	<50	NA	<50	<0.50	0.70	<0.50	0.71	11

1. ug/L: micrograms per liter
2. BGS: below ground surface
3. Total petroleum hydrocarbons as motor oil (TPHMO) and as diesel (TPHD) analyzed in general accordance with EPA Method No. 8015B
4. Sample not subjected to silica gel cleanup.
5. Sample subjected to silica gel cleanup.
6. Total petroleum hydrocarbons as gasoline (TPHG), benzene (B), toluene (T), ethylbenzene (E), xylenes (X), and methyl tertiary-butyl ether (MTBE) analyzed in general accordance with EPA Method No. 8260B
7. <: "less than" the stated method reporting limit
8. NA : not analyzed

Table 2-9
Soil Analytical Results, July 16, 2013
Don's Rent-All, Eureka, California
(in mg/kg)¹

Sample Location @ Depth (feet BGS) ²	TPHMO ³	TPHD ³	TPHG ⁴	B ⁴	T ⁴	E ⁴	X ⁴	MTBE ⁴
B-300@ 4	<1.0 ⁵	<10	<1.0	<0.0050	<0.0050	<0.0050	<0.015	<0.025
B-300@ 8	<1.0	<10	<1.0	<0.0050	<0.0050	<0.0050	<0.015	<0.025
B-300@ 12	<1.0	<10	<1.0	<0.0050	<0.0050	<0.0050	<0.015	<0.025
B-301@ 4	<1.0	13⁶	<1.0	<0.0050	<0.0050	<0.0050	<0.015	<0.025
B-301@ 8	<1.0	<10	<1.0	<0.0050	<0.0050	<0.0050	<0.015	<0.025
B-301@ 12	<1.0	<10	<1.0	<0.0050	<0.0050	<0.0050	<0.015	<0.025

1. mg/kg: milligrams per kilogram
2. BGS: below ground surface
3. Total petroleum hydrocarbons as motor oil (TPHMO), as diesel (TPHD) analyzed in general accordance with EPA Method No. 8015B
4. Total petroleum hydrocarbons as gasoline (TPHG), benzene (B), toluene (T), ethylbenzene (E), xylenes (X), and methyl tertiary-butyl ether (MTBE) analyzed in general accordance with EPA Method 8260B
5. <: "less than" the stated method reporting limit
6. The sample does not have the typical pattern of fresh motor oil. However, the result reported represents the amount of material in the motor oil range.

Table 2-10
Groundwater Analytical Results, July 16, 2013
Don's Rent-All, Eureka, California
(in ug/L)¹

Sample Location	TPHD ²	TPHMO ²	TPHG ³	B ³	T ³	E ³	X ³	MTBE ³
B-300	<50 ⁴	<170	<50	<0.50	<0.50	<0.50	<1.0	2.6
B-301	<50	<170	<50	<0.50	<0.50	<0.50	<1.0	24

1. ug/L: micrograms per liter
2. Total petroleum hydrocarbons as motor oil (TPHMO) and as diesel (TPHD) analyzed in general accordance with EPA Method No. 8015B
3. Total petroleum hydrocarbons as gasoline (TPHG), benzene (B), toluene (T), ethylbenzene (E), xylenes (X), and methyl tertiary-butyl ether (MTBE) analyzed in general accordance with EPA Method No. 8260B
4. <: "less than" the stated method reporting limit

**Table 2-11
Well Construction Details
Don's Rent-All, Eureka, California**

Sample Location	Date Installed	Total Depth (feet BGS) ¹	Casing Material	Screen Slot Size (Inches)	Screened Interval (feet BGS)	Sand Interval (feet BGS)	Sanitary Seal (feet BGS)
MW-1	7/20/06	13	2 inch Schedule 40 Polyvinyl Chloride	0.010	3.0-13.0	2.0-13.0	0.5-2.0
MW-2	7/20/06	13		0.010	3.0-13.0	2.0-13.0	0.5-2.0
MW-3	7/20/06	13		0.010	3.0-13.0	2.0-13.0	0.5-2.0
MW-4	10/31/07	13		0.010	3.0-13.0	2.0-13.0	0.5-2.0
MW-5	10/31/07	13		0.010	3.0-13.0	2.0-13.0	0.5-2.0

1. BGS: below ground surface

Table 2-12
Historical Groundwater Elevations
Don's Rent-All, Eureka, California

Sample Location	Sample Date	Top of Casing Elevation (feet) ¹	Depth-to-Water ² (feet)	Groundwater Elevation (feet) ¹		
MW-1	07/27/06	9.35	5.17	4.18		
	10/20/06		5.38	3.97		
	01/15/07		4.71	4.64		
	04/06/07		4.99	4.36		
	07/03/07		5.31	4.04		
	10/02/07		5.38	3.97		
	11/09/07	9.34	5.24	4.10		
	01/04/08		3.66	5.68		
	04/28/08		5.08	4.26		
	07/01/08		5.33	4.01		
	10/15/08		5.55	3.79		
	01/09/09		4.88	4.46		
	04/03/09		4.89	4.45		
	07/01/09		5.23	4.11		
	MW-2		07/27/06	9.15	4.97	4.18
			10/20/06		5.16	3.99
01/15/07		4.46	4.69			
04/06/07		4.77	4.38			
07/03/07		5.11	4.04			
10/02/07		5.16	3.99			
11/09/07		9.14	5.02	4.12		
01/04/08			3.48	5.66		
04/28/08			4.86	4.28		
07/01/08			5.13	4.01		
10/15/08			5.33	3.81		
01/09/09			4.66	4.48		
04/03/09			4.67	4.47		
07/01/09			5.02	4.12		
MW-3	07/27/06	9.33	5.18	4.15		
	10/20/06		5.38	3.95		
	01/15/07		4.70	4.63		
	04/06/07		5.02	4.31		
	07/03/07		5.34	3.99		
	10/02/07		5.39	3.94		
	11/09/07		5.24	4.09		
	01/04/08		3.48	5.85		

**Table 2-12
Historical Groundwater Elevations
Don's Rent-All, Eureka, California**

Sample Location	Sample Date	Top of Casing Elevation (feet)¹	Depth-to-Water² (feet)	Groundwater Elevation (feet)¹
MW-3 cont'd	04/28/08	9.33	5.09	4.24
	07/01/08		5.33	4.00
	10/15/08		5.54	3.79
	01/09/09		4.88	4.45
	04/03/09		4.90	4.43
	07/01/09		5.23	4.10
MW-4	11/09/07	9.42	5.23	4.19
	01/04/08		3.76	5.66
	04/28/08		5.06	4.36
	07/01/08		5.32	4.10
	10/15/08		5.55	3.87
	01/09/09		4.88	4.54
	04/03/09		4.87	4.55
	07/01/09		5.24	4.18
MW-5	11/09/07	8.51	4.47	4.04
	01/04/08		2.90	5.61
	04/28/08		4.34	4.17
	07/01/08		4.61	3.90
	10/15/08		4.79	3.72
	01/09/09		4.12	4.39
	04/03/09		4.12	4.39
	07/01/09		4.48	4.03

1. Referenced to North American Vertical Datum 1988
2. Below top of casing

Table 2-13
Historical Groundwater Analytical Results
Don's Rent-All, Eureka, California
(in ug/L)¹

Sample Location	Sample Date	TPHMO ²	TPHD ²	TPHG ³	B ³	T ³	E ³	X ³	MTBE ³
MW-1	07/27/06	<170 ^{4,5}	240 ⁵	13,000	140	490	340	1,880	1,300
	10/20/06	180 ⁵	340 ⁵	8,800	290	320	230	1,030	1,200
	01/15/07	NA ⁶	NA	11,000	100	170	220	1,260	560
	04/06/07	NA	NA	14,000	93	380	270	2,440	760
	07/03/07	NA	NA	10,000	170	210	250	1,090	780
	10/02/07	NA	NA	9,300	160	92	220	1,040	870
	01/04/08	NA	NA	5,100	57	28	140	575	<350
	04/28/08	NA	NA	9,200	99	130	210	1,110	430
	07/01/08	NA	NA	6,600	110	57	150	810	410
	10/15/08	NA	NA	6,900	110	11	160	640	560
	01/09/09	NA	NA	6,300	48	40	140	667	430
	04/03/09	NA	NA	12,000	62	62	190	1,080	500
07/01/09	NA	NA	6,900	91	12	86	315	820	
MW-2	07/27/06	<170 ⁵	<50 ⁵	220	5.2	2.5	1.2	4.3	22
	10/20/06	<170	<50	260	2.5	<0.50	<0.50	0.76	39
	01/15/07	NA	NA	690	2.9	0.52	<0.50	2.19	41
	04/06/07	NA	NA	570	2.0	<0.50	<0.50	1.86	44
	07/03/07	NA	NA	510	2.3	<0.50	<0.50	3.68	44
	10/02/07	NA	NA	320	1.1	<0.50	<0.50	1.3	28
	01/04/08	NA	NA	870	5.3	0.61	<0.50	4.03	48
	04/28/08	NA	NA	570	2.5	<0.50	<0.50	2.0	43
	07/01/08	NA	NA	340	1.3	<0.50	<0.50	<1.0	28
	10/15/08	NA	NA	190	<0.50	<0.50	<0.50	0.52	24
	01/09/09	NA	NA	350	0.83	<0.50	<0.50	<1.0	42
	04/03/09	NA	NA	290	<0.50	<0.50	<0.50	<1.0	28
MW-3	07/27/06	<170 ⁵	270 ⁵	15,000	140	150	300	1,760	1,100
	10/20/06	<170 ⁵	400 ⁵	7,400	120	41	98	630	770
	01/15/07	NA	NA	5,600	45	<25	36	162	430
	04/06/07	NA	NA	15,000	27	2.2	19	114	380
	07/03/07	NA	NA	4,700	70	4.0	34	201	610
	10/02/07	NA	NA	4,500	62	<25	<25	110	570
	01/04/08	NA	NA	<50	<0.50	<0.50	<0.50	<1.0	15
	04/28/08	NA	NA	3,000	31	1.3	3.6	39.2	300
	07/01/08	NA	NA	2,300	30	1.4	2.5	26.82	190

Table 2-13
Historical Groundwater Analytical Results
Don's Rent-All, Eureka, California
(in ug/L)¹

Sample Location	Sample Date	TPHMO ²	TPHD ²	TPHG ³	B ³	T ³	E ³	X ³	MTBE ³
MW-3 cont'd	10/15/08	NA	NA	1,600	25	1.2	1.1	6.1	160
	01/09/09	NA	NA	2,200	17	0.80	1.2	6.04	320
	04/03/09	NA	NA	1,500	9.4	<0.50	<0.50	5.2	160
	07/01/09	NA	NA	2,000	31	0.91	1.2	20	200
MW-4	11/09/07	NA	NA	56	<0.50	<0.50	<0.50	<1.0	10
	01/04/08	NA	NA	<50	<0.50	<0.50	<0.50	<1.0	6.0
	04/28/08	NA	NA	<50	<0.50	<0.50	<0.50	<1.0	3.7
	07/01/08	NA	NA	<50	<0.50	<0.50	<0.50	<1.0	3.9
	10/15/08	NA	NA	<50	<0.50	<0.50	<0.50	<1.0	5.4
	01/09/09	NA	NA	<50	<0.50	<0.50	<0.50	<1.0	4.0
	04/03/09	NA	NA	<50	<0.50	<0.50	<0.50	<1.0	4.2
MW-5	11/09/07	NA	NA	160	<0.50	<0.50	1.4	3.9	14
	01/04/08	NA	NA	290	<0.50	<0.50	2.9	3.4	11
	04/28/08	NA	NA	<50	<0.50	<0.50	<0.50	<1.0	18
	07/01/08	NA	NA	<50	<0.50	<0.50	<0.50	<1.0	13
	10/15/08	NA	NA	64	<0.50	<0.50	<0.50	<1.0	13
	01/09/09	NA	NA	<50	<0.50	<0.50	<0.50	<1.0	8.0
	04/03/09	NA	NA	<50	<0.50	<0.50	<0.50	<1.0	3.4
	07/01/09	NA	NA	53	<0.50	<0.50	<0.50	<1.0	24

1. ug/L: micrograms per liter
2. Total petroleum hydrocarbons as motor oil (TPHMO) and total petroleum hydrocarbons as diesel (TPHD), analyzed in general accordance with EPA Method No. 8015B
3. Total petroleum hydrocarbons as gasoline (TPHG), benzene (B), toluene (T), ethylbenzene (E), total xylenes (X), and methyl tertiary-butyl ether (MTBE) analyzed in general accordance with EPA Method No. 8260B or 8260B Modified.
4. <: "less than" the stated method reporting limit
5. Sample subjected to silica gel cleanup.
6. NA: not analyzed

Table 2-14
Historical DO, DCO₂, and ORP Measurement Results
Don's Rent-All, Eureka, California

Sample Location	Sample Date	DO ¹ (ppm) ²	DCO ₂ ³ (ppm)	ORP ⁴ (mV) ⁵
MW-1	10/20/06	2.10	450	-179
	01/15/07	0.10	550	-88
	04/06/07	0.38	400	-90
	07/03/07	0.11	400	-129
	10/02/07	0.33	325	-97
	01/04/08	0.02	135	-35
	04/28/08	0.93	350	-80
	07/01/08	8.00	275	-100
	10/15/08	0.33	350	-177
	01/09/09	0.47	500	-127
	04/03/09	0.43	375	-79
	07/01/09	0.40	350	-118
MW-2	10/20/06	2.18	215	-160
	01/15/07	0.40	400	-72
	04/06/07	0.36	275	-106
	07/03/07	0.10	250	-94
	10/02/07	0.30	100	86
	01/04/08	0.07	195	-156
	04/28/08	1.59	200	-45
	07/01/08	7.40	150	-105
	10/15/08	0.32	150	-116
	01/09/09	0.52	350	-62
	04/03/09	0.48	175	22
	MW-3	10/20/06	1.87	200
01/15/07		0.00	125	-54
04/06/07		0.32	100	-35
07/03/07		0.12	230	-90
10/02/07		0.31	250	-69
01/04/08		0.10	90	7
04/28/08		0.41	95	-42
07/01/08		7.97	110	-72
10/15/08		0.33	95	-144
01/09/09		0.42	100	-57
04/03/09		0.29	85	11
07/01/09		0.30	150	27

Table 2-14
Historical DO, DCO₂, and ORP Measurement Results
Don's Rent-All, Eureka, California

Sample Location	Sample Date	DO ¹ (ppm) ²	DCO ₂ ³ (ppm)	ORP ⁴ (mV) ⁵
MW-4	01/04/08	0.13	550	-87
	04/28/08	0.38	350	-88
	07/01/08	0.40	500	-123
	10/15/08	0.49	500	-202
	01/09/09	0.95	500	-68
	04/03/09	0.61	>500 ⁶	36
MW-5	01/04/08	0.10	55	-39
	04/28/08	0.65	25	189
	07/01/08	0.33	20	-66
	10/15/08	0.67	50	-143
	01/09/09	0.55	25	3
	04/03/09	0.47	15	-42
	07/01/09	0.40	25	113

1. DO: dissolved oxygen, field measured using portable instrumentation.
2. ppm: parts per million
3. DCO₂: dissolved carbon dioxide, field measured using a field test kit.
4. ORP: oxidation-reduction potential; field measured using portable instrumentation.
5. mV: millivolts
6. >: "greater than" the maximum value of the field measurement technique

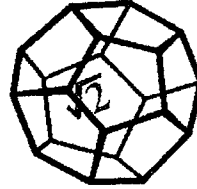

**NORTH COAST
LABORATORIES LTD.**

July 24, 2013

SHN Consulting Engineers and Geologists
812 West Wabash Avenue
Eureka, CA 95501

Order No.: 1307271
Invoice No.: 110553
PO No.:
ELAP No.1247-Expires July 2014

Attn: Roland Rueber

RE: 005287 Don' s Rent All

SAMPLE IDENTIFICATION

Fraction	Client Sample Description
01A	B-300 @ 4 ft
02A	B-300 @ 8 ft
03A	B-300 @ 12 ft
04A	B-300
04D	B-300
05A	B-301 @ 4 ft
06A	B-301 @ 8 ft
07A	B-301 @ 12 ft
08A	B-301
08D	B-301

ND = Not Detected at the Reporting Limit
Limit = Reporting Limit
Flag = Explanation in Case Narrative
All solid results are expressed on a wet-weight basis unless otherwise noted.

REPORT CERTIFIED BY

Laboratory Supervisor(s)

QA Unit

Jesse G. Chaney, Jr.
Laboratory Director

CLIENT: SHN Consulting Engineers and Geologists
Project: 005287 Don's Rent All
Lab Order: 1307271

CASE NARRATIVE

M3: The sample does not have the typical pattern of fresh motor oil. However, the result reported represents the amount of material in the motor oil range.

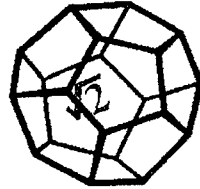

**NORTH COAST
LABORATORIES LTD.**

July 24, 2013

SHN Consulting Engineers and Geologists
812 West Wabash Avenue
Eureka, CA 95501

Order No.: 1307271
Invoice No.: 110553
PO No.:
ELAP No.1247-Expires July 2014

Attn: Roland Rueber

RE: 005287 Don' s Rent All

SAMPLE IDENTIFICATION

Fraction	Client Sample Description
01A	B-300 @ 4 ft
02A	B-300 @ 8 ft
03A	B-300 @ 12 ft
04A	B-300
04D	B-300
05A	B-301 @ 4 ft
06A	B-301 @ 8 ft
07A	B-301 @ 12 ft
08A	B-301
08D	B-301

ND = Not Detected at the Reporting Limit
Limit = Reporting Limit
Flag = Explanation in Case Narrative
All solid results are expressed on a wet-weight basis unless otherwise noted.

REPORT CERTIFIED BY

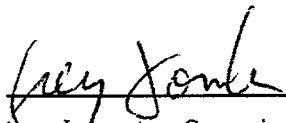

Laboratory Supervisor(s)



QA Unit

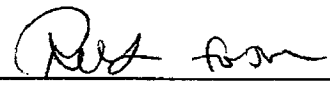

Jesse G. Chaney, Jr.
Laboratory Director

CLIENT: SHN Consulting Engineers and Geologists
Project: 005287 Don' s Rent All
Lab Order: 1307271

CASE NARRATIVE

M3: The sample does not have the typical pattern of fresh motor oil. However, the result reported represents the amount of material in the motor oil range.

Date: 24-Jul-2013

WorkOrder: 1307271

ANALYTICAL REPORT

Client Sample ID: B-300 @ 4 ft

Received: 7/17/2013

Lab ID: 1307271-01A

Collected: 7/16/2013 18:00

Test Name: Gasoline Components/Additives

Reference: EPA 5035/EPA 8260B

<u>Parameter</u>	<u>Result</u>	<u>Flag</u>	<u>Limit</u>	<u>Units</u>	<u>DF</u>	<u>Extracted</u>	<u>Analyzed</u>
Methyl tert-butyl ether (MTBE)	ND		0.025	mg/kg	1.0	7/18/2013	7/18/2013
Benzene	ND		0.0050	mg/kg	1.0	7/18/2013	7/18/2013
Toluene	ND		0.0050	mg/kg	1.0	7/18/2013	7/18/2013
Ethylbenzene	ND		0.0050	mg/kg	1.0	7/18/2013	7/18/2013
m,p-Xylene	ND		0.010	mg/kg	1.0	7/18/2013	7/18/2013
o-Xylene	ND		0.0050	mg/kg	1.0	7/18/2013	7/18/2013
Surrogate: Toluene-d8	79.0		70-130	% Rec	1.0	7/18/2013	7/18/2013

Test Name: TPH as Diesel/Motor Oil

Reference: EPA 3550/EPA 8015B

<u>Parameter</u>	<u>Result</u>	<u>Flag</u>	<u>Limit</u>	<u>Units</u>	<u>DF</u>	<u>Extracted</u>	<u>Analyzed</u>
TPHC Diesel (C12-C22)	ND		1.0	mg/kg	1.0	7/18/2013	7/18/2013
TPHC Motor Oil	ND		10	mg/kg	1.0	7/18/2013	7/18/2013

Test Name: TPH as Gasoline

Reference: LUFT/EPA 8260B Modified

<u>Parameter</u>	<u>Result</u>	<u>Flag</u>	<u>Limit</u>	<u>Units</u>	<u>DF</u>	<u>Extracted</u>	<u>Analyzed</u>
TPHC Gasoline	ND		1.0	mg/kg	1.0	7/18/2013	7/18/2013

Client Sample ID: B-300 @ 8 ft

Received: 7/17/2013

Lab ID: 1307271-02A

Collected: 7/16/2013 18:05

Test Name: Gasoline Components/Additives

Reference: EPA 5035/EPA 8260B

<u>Parameter</u>	<u>Result</u>	<u>Flag</u>	<u>Limit</u>	<u>Units</u>	<u>DF</u>	<u>Extracted</u>	<u>Analyzed</u>
Methyl tert-butyl ether (MTBE)	ND		0.025	mg/kg	1.0	7/18/2013	7/18/2013
Benzene	ND		0.0050	mg/kg	1.0	7/18/2013	7/18/2013
Toluene	ND		0.0050	mg/kg	1.0	7/18/2013	7/18/2013
Ethylbenzene	ND		0.0050	mg/kg	1.0	7/18/2013	7/18/2013
m,p-Xylene	ND		0.010	mg/kg	1.0	7/18/2013	7/18/2013
o-Xylene	ND		0.0050	mg/kg	1.0	7/18/2013	7/18/2013
Surrogate: Toluene-d8	90.7		70-130	% Rec	1.0	7/18/2013	7/18/2013

Test Name: TPH as Diesel/Motor Oil

Reference: EPA 3550/EPA 8015B

<u>Parameter</u>	<u>Result</u>	<u>Flag</u>	<u>Limit</u>	<u>Units</u>	<u>DF</u>	<u>Extracted</u>	<u>Analyzed</u>
TPHC Diesel (C12-C22)	ND		1.0	mg/kg	1.0	7/18/2013	7/18/2013
TPHC Motor Oil	ND		10	mg/kg	1.0	7/18/2013	7/18/2013

Test Name: TPH as Gasoline

Reference: LUFT/EPA 8260B Modified

<u>Parameter</u>	<u>Result</u>	<u>Flag</u>	<u>Limit</u>	<u>Units</u>	<u>DF</u>	<u>Extracted</u>	<u>Analyzed</u>
TPHC Gasoline	ND		1.0	mg/kg	1.0	7/18/2013	7/18/2013

Date: 24-Jul-2013
WorkOrder: 1307271

ANALYTICAL REPORT

Client Sample ID: B-300 @ 8 ft
Lab ID: 1307271-02A

Received: 7/17/2013
Collected: 7/16/2013 18:05

Client Sample ID: B-300 @ 12 ft
Lab ID: 1307271-03A

Received: 7/17/2013
Collected: 7/16/2013 18:10

Test Name: Gasoline Components/Additives

Reference: EPA 5035/EPA 8260B

<u>Parameter</u>	<u>Result</u>	<u>Flag</u>	<u>Limit</u>	<u>Units</u>	<u>DF</u>	<u>Extracted</u>	<u>Analyzed</u>
Methyl tert-butyl ether (MTBE)	ND		0.025	mg/kg	1.0	7/18/2013	7/18/2013
Benzene	ND		0.0050	mg/kg	1.0	7/18/2013	7/18/2013
Toluene	ND		0.0050	mg/kg	1.0	7/18/2013	7/18/2013
Ethylbenzene	ND		0.0050	mg/kg	1.0	7/18/2013	7/18/2013
m,p-Xylene	ND		0.010	mg/kg	1.0	7/18/2013	7/18/2013
o-Xylene	ND		0.0050	mg/kg	1.0	7/18/2013	7/18/2013
Surrogate: Toluene-d8	72.5		70-130	% Rec	1.0	7/18/2013	7/18/2013

Test Name: TPH as Diesel/Motor Oil

Reference: EPA 3550/EPA 8015B

<u>Parameter</u>	<u>Result</u>	<u>Flag</u>	<u>Limit</u>	<u>Units</u>	<u>DF</u>	<u>Extracted</u>	<u>Analyzed</u>
TPHC Diesel (C12-C22)	ND		1.0	mg/kg	1.0	7/18/2013	7/18/2013
TPHC Motor Oil	ND		10	mg/kg	1.0	7/18/2013	7/18/2013

Test Name: TPH as Gasoline

Reference: LUFT/EPA 8260B Modified

<u>Parameter</u>	<u>Result</u>	<u>Flag</u>	<u>Limit</u>	<u>Units</u>	<u>DF</u>	<u>Extracted</u>	<u>Analyzed</u>
TPHC Gasoline	ND		1.0	mg/kg	1.0	7/18/2013	7/18/2013

Client Sample ID: B-300
Lab ID: 1307271-04A

Received: 7/17/2013
Collected: 7/16/2013 18:30

Test Name: EPA 8260B

Reference: EPA 8260B

<u>Parameter</u>	<u>Result</u>	<u>Flag</u>	<u>Limit</u>	<u>Units</u>	<u>DF</u>	<u>Extracted</u>	<u>Analyzed</u>
Methyl tert-butyl ether (MTBE)	2.6		0.50	µg/L	1.0		7/20/2013
Benzene	ND		0.50	µg/L	1.0		7/20/2013
Toluene	ND		0.50	µg/L	1.0		7/20/2013
Ethylbenzene	ND		0.50	µg/L	1.0		7/20/2013
m,p-Xylene	ND		0.50	µg/L	1.0		7/20/2013
o-Xylene	ND		0.50	µg/L	1.0		7/20/2013
Surrogate: 1,2-Dichloroethane-d4	108		68.8-126	% Rec	1.0		7/20/2013
Surrogate: Dibromofluoromethane	107		72.3-120	% Rec	1.0		7/20/2013
Surrogate: Toluene-d8	102		77.6-137	% Rec	1.0		7/20/2013

Date: 24-Jul-2013
WorkOrder: 1307271

ANALYTICAL REPORT

Client Sample ID: B-300
Lab ID: 1307271-04A

Received: 7/17/2013
Collected: 7/16/2013 18:30

Test Name: TPH as Gasoline

Reference: LUFT/EPA 8260B Modified

<u>Parameter</u>	<u>Result</u>	<u>Flag</u>	<u>Limit</u>	<u>Units</u>	<u>DF</u>	<u>Extracted</u>	<u>Analyzed</u>
TPHC Gasoline	ND		50	µg/L	1.0		7/24/2013

Client Sample ID: B-300
Lab ID: 1307271-04D

Received: 7/17/2013
Collected: 7/16/2013 18:30

Test Name: TPH as Diesel/Motor Oil

Reference: LUFT/EPA 3511/EPA 8015B

<u>Parameter</u>	<u>Result</u>	<u>Flag</u>	<u>Limit</u>	<u>Units</u>	<u>DF</u>	<u>Extracted</u>	<u>Analyzed</u>
TPHC Diesel (C12-C22)	ND		50	µg/L	1.0	7/18/2013	7/19/2013
TPHC Motor Oil	ND		170	µg/L	1.0	7/18/2013	7/19/2013

Client Sample ID: B-301 @ 4 ft
Lab ID: 1307271-05A

Received: 7/17/2013
Collected: 7/16/2013 18:50

Test Name: Gasoline Components/Additives

Reference: EPA 5035/EPA 8260B

<u>Parameter</u>	<u>Result</u>	<u>Flag</u>	<u>Limit</u>	<u>Units</u>	<u>DF</u>	<u>Extracted</u>	<u>Analyzed</u>
Methyl tert-butyl ether (MTBE)	ND		0.025	mg/kg	1.0	7/18/2013	7/18/2013
Benzene	ND		0.0050	mg/kg	1.0	7/18/2013	7/18/2013
Toluene	ND		0.0050	mg/kg	1.0	7/18/2013	7/18/2013
Ethylbenzene	ND		0.0050	mg/kg	1.0	7/18/2013	7/18/2013
m,p-Xylene	ND		0.010	mg/kg	1.0	7/18/2013	7/18/2013
o-Xylene	ND		0.0050	mg/kg	1.0	7/18/2013	7/18/2013
Surrogate: Toluene-d8	76.1		70-130	% Rec	1.0	7/18/2013	7/18/2013

Test Name: TPH as Diesel/Motor Oil

Reference: EPA 3550/EPA 8015B

<u>Parameter</u>	<u>Result</u>	<u>Flag</u>	<u>Limit</u>	<u>Units</u>	<u>DF</u>	<u>Extracted</u>	<u>Analyzed</u>
TPHC Diesel (C12-C22)	ND		1.0	mg/kg	1.0	7/18/2013	7/18/2013
TPHC Motor Oil	13	M3	10	mg/kg	1.0	7/18/2013	7/18/2013

Test Name: TPH as Gasoline

Reference: LUFT/EPA 8260B Modified

<u>Parameter</u>	<u>Result</u>	<u>Flag</u>	<u>Limit</u>	<u>Units</u>	<u>DF</u>	<u>Extracted</u>	<u>Analyzed</u>
TPHC Gasoline	ND		1.0	mg/kg	1.0	7/18/2013	7/18/2013

Date: 24-Jul-2013
WorkOrder: 1307271

ANALYTICAL REPORT

Client Sample ID: B-301 @ 8 ft
Lab ID: 1307271-06A

Received: 7/17/2013
Collected: 7/16/2013 18:55

Test Name: Gasoline Components/Additives

Reference: EPA 5035/EPA 8260B

<u>Parameter</u>	<u>Result</u>	<u>Flag</u>	<u>Limit</u>	<u>Units</u>	<u>DF</u>	<u>Extracted</u>	<u>Analyzed</u>
Methyl tert-butyl ether (MTBE)	ND		0.025	mg/kg	1.0	7/18/2013	7/18/2013
Benzene	ND		0.0050	mg/kg	1.0	7/18/2013	7/18/2013
Toluene	ND		0.0050	mg/kg	1.0	7/18/2013	7/18/2013
Ethylbenzene	ND		0.0050	mg/kg	1.0	7/18/2013	7/18/2013
m,p-Xylene	ND		0.010	mg/kg	1.0	7/18/2013	7/18/2013
o-Xylene	ND		0.0050	mg/kg	1.0	7/18/2013	7/18/2013
Surrogate: Toluene-d8	80.5		70-130	% Rec	1.0	7/18/2013	7/18/2013

Test Name: TPH as Diesel/Motor Oil

Reference: EPA 3550/EPA 8015B

<u>Parameter</u>	<u>Result</u>	<u>Flag</u>	<u>Limit</u>	<u>Units</u>	<u>DF</u>	<u>Extracted</u>	<u>Analyzed</u>
TPHC Diesel (C12-C22)	ND		1.0	mg/kg	1.0	7/18/2013	7/18/2013
TPHC Motor Oil	ND		10	mg/kg	1.0	7/18/2013	7/18/2013

Test Name: TPH as Gasoline

Reference: LUFT/EPA 8260B Modified

<u>Parameter</u>	<u>Result</u>	<u>Flag</u>	<u>Limit</u>	<u>Units</u>	<u>DF</u>	<u>Extracted</u>	<u>Analyzed</u>
TPHC Gasoline	ND		1.0	mg/kg	1.0	7/18/2013	7/18/2013

Client Sample ID: B-301 @ 12 ft
Lab ID: 1307271-07A

Received: 7/17/2013
Collected: 7/16/2013 19:00

Test Name: Gasoline Components/Additives

Reference: EPA 5035/EPA 8260B

<u>Parameter</u>	<u>Result</u>	<u>Flag</u>	<u>Limit</u>	<u>Units</u>	<u>DF</u>	<u>Extracted</u>	<u>Analyzed</u>
Methyl tert-butyl ether (MTBE)	ND		0.025	mg/kg	1.0	7/18/2013	7/18/2013
Benzene	ND		0.0050	mg/kg	1.0	7/18/2013	7/18/2013
Toluene	ND		0.0050	mg/kg	1.0	7/18/2013	7/18/2013
Ethylbenzene	ND		0.0050	mg/kg	1.0	7/18/2013	7/18/2013
m,p-Xylene	ND		0.010	mg/kg	1.0	7/18/2013	7/18/2013
o-Xylene	ND		0.0050	mg/kg	1.0	7/18/2013	7/18/2013
Surrogate: Toluene-d8	81.8		70-130	% Rec	1.0	7/18/2013	7/18/2013

Test Name: TPH as Diesel/Motor Oil

Reference: EPA 3550/EPA 8015B

<u>Parameter</u>	<u>Result</u>	<u>Flag</u>	<u>Limit</u>	<u>Units</u>	<u>DF</u>	<u>Extracted</u>	<u>Analyzed</u>
TPHC Diesel (C12-C22)	ND		1.0	mg/kg	1.0	7/18/2013	7/18/2013
TPHC Motor Oil	ND		10	mg/kg	1.0	7/18/2013	7/18/2013

Test Name: TPH as Gasoline

Reference: LUFT/EPA 8260B Modified

<u>Parameter</u>	<u>Result</u>	<u>Flag</u>	<u>Limit</u>	<u>Units</u>	<u>DF</u>	<u>Extracted</u>	<u>Analyzed</u>
TPHC Gasoline	ND		1.0	mg/kg	1.0	7/18/2013	7/18/2013

Page 4 of 5

Date: 24-Jul-2013
WorkOrder: 1307271

ANALYTICAL REPORT

Client Sample ID: B-301 @ 12 ft
Lab ID: 1307271-07A

Received: 7/17/2013
Collected: 7/16/2013 19:00

Client Sample ID: B-301
Lab ID: 1307271-08A

Received: 7/17/2013
Collected: 7/16/2013 19:30

Test Name: EPA 8260B

Reference: EPA 8260B

<u>Parameter</u>	<u>Result</u>	<u>Flag</u>	<u>Limit</u>	<u>Units</u>	<u>DF</u>	<u>Extracted</u>	<u>Analyzed</u>
Methyl tert-butyl ether (MTBE)	24		0.50	µg/L	1.0		7/20/2013
Benzene	ND		0.50	µg/L	1.0		7/20/2013
Toluene	ND		0.50	µg/L	1.0		7/20/2013
Ethylbenzene	ND		0.50	µg/L	1.0		7/20/2013
m,p-Xylene	ND		0.50	µg/L	1.0		7/20/2013
o-Xylene	ND		0.50	µg/L	1.0		7/20/2013
Surrogate: 1,2-Dichloroethane-d4	98.8		68.8-126	% Rec	1.0		7/20/2013
Surrogate: Dibromofluoromethane	105		72.3-120	% Rec	1.0		7/20/2013
Surrogate: Toluene-d8	101		77.6-137	% Rec	1.0		7/20/2013

Test Name: TPH as Gasoline

Reference: LUFT/EPA 8260B Modified

<u>Parameter</u>	<u>Result</u>	<u>Flag</u>	<u>Limit</u>	<u>Units</u>	<u>DF</u>	<u>Extracted</u>	<u>Analyzed</u>
TPHC Gasoline	ND		50	µg/L	1.0		7/24/2013

Client Sample ID: B-301
Lab ID: 1307271-08D

Received: 7/17/2013
Collected: 7/16/2013 19:30

Test Name: TPH as Diesel/Motor Oil

Reference: LUFT/EPA 3511/EPA 8015B

<u>Parameter</u>	<u>Result</u>	<u>Flag</u>	<u>Limit</u>	<u>Units</u>	<u>DF</u>	<u>Extracted</u>	<u>Analyzed</u>
TPHC Diesel (C12-C22)	ND		50	µg/L	1.0	7/18/2013	7/19/2013
TPHC Motor Oil	ND		170	µg/L	1.0	7/18/2013	7/19/2013

CLIENT: SHN Consulting Engineers and Geologists
 Work Order: 1307271
 Project: 005287 Don' s Rent All

QC SUMMARY REPORT

Method Blank

Sample ID: MB 071913	Batch ID: R75166	Test Code: 8260EW	Units: µg/L	Analysis Date 7/20/2013 12:39:00 AM	Prep Date:						
Client ID:	Run ID: ORGCMS2_130719B	SeqNo: 1091083									
Analyte	Result	Limit	SPK value	SPK Ref Val	% Rec	LowLimit	HighLimit	RPD Ref Val	%RPD	RPDLimit	Qual
Methyl tert-butyl ether (MTBE)	ND	0.50									
Benzene	ND	0.50									
Toluene	ND	0.50									
Ethylbenzene	ND	0.50									
m,p-Xylene	ND	0.50									
o-Xylene	ND	0.50									
Surrogate: Dibromofluoromethane	1.00	0.10	1.00	0	100%	72	120	0			
Surrogate: 1,2-Dichloroethane-d4	0.980	0.10	1.00	0	98.0%	69	126	0			
Surrogate: Toluene-d8	0.994	0.10	1.00	0	99.4%	78	137	0			

Sample ID: MB-29307	Batch ID: 29307	Test Code: 8260OXYS	Units: mg/kg	Analysis Date 7/18/2013 5:30:00 PM	Prep Date: 7/18/2013						
Client ID:	Run ID: ORGCMS2_130718B	SeqNo: 1090690									
Analyte	Result	Limit	SPK value	SPK Ref Val	% Rec	LowLimit	HighLimit	RPD Ref Val	%RPD	RPDLimit	Qual
Methyl tert-butyl ether (MTBE)	ND	0.025									
Benzene	ND	0.0050									
Toluene	ND	0.0050									
Ethylbenzene	ND	0.0050									
m,p-Xylene	ND	0.010									
o-Xylene	ND	0.0050									
Surrogate: Toluene-d8	91.7	0.10	100	0	91.7%	70	130	0			

Sample ID: MB-29307	Batch ID: 29307	Test Code: GASS-MS	Units: mg/kg	Analysis Date 7/18/2013 2:51:00 PM	Prep Date: 7/18/2013						
Client ID:	Run ID: ORGCMS3_130718A	SeqNo: 1090666									
Analyte	Result	Limit	SPK value	SPK Ref Val	% Rec	LowLimit	HighLimit	RPD Ref Val	%RPD	RPDLimit	Qual
TPHC Gasoline	ND	1.0									

Qualifiers: ND - Not Detected at the Reporting Limit S - Spike Recovery outside accepted recovery limits B - Analyte detected in the associated Method Blank
 J - Analyte detected below quantitation limits R - RPD outside accepted recovery limits

CLIENT: SHN Consulting Engineers and Geologists
 Work Order: 1307271
 Project: 005287 Don's Rent All

QC SUMMARY REPORT
 Sample Matrix Spike

Sample ID: 1307271-04AMS Batch ID: R75166 Test Code: 8260EW Units: µg/L Analysis Date 7/19/2013 11:43:00 PM Prep Date:
 Client ID: B-300 Run ID: ORGCMS2_130719B SeqNo: 1091082

Analyte	Result	Limit	SPK value	SPK Ref Val	% Rec	LowLimit	HighLimit	RPD Ref Val	%RPD	RPDLimit	Qual
Methyl tert-butyl ether (MTBE)	20.75	0.50	20.0	2.63	90.6%	60	136	0			
Benzene	19.86	0.50	20.0	0	99.3%	74	118	0			
Toluene	19.33	0.50	20.0	0	96.7%	76	133	0			
Ethylbenzene	19.52	0.50	20.0	0.166	96.8%	77	129	0			
m,p-Xylene	38.89	0.50	40.0	0.487	96.0%	82	129	0			
o-Xylene	18.92	0.50	20.0	0.225	93.5%	84	126	0			
Surrogate: Dibromofluoromethane	0.858	0.10	1.00	0	85.8%	72	120	0			
Surrogate: 1,2-Dichloroethane-d4	1.00	0.10	1.00	0	100%	69	126	0			
Surrogate: Toluene-d8	0.995	0.10	1.00	0	99.5%	78	137	0			

Sample ID: 1307271-01AMS Batch ID: 29307 Test Code: 8260OXYS Units: mg/kg Analysis Date 7/18/2013 4:33:00 PM Prep Date: 7/18/2013
 Client ID: B-300 @ 4 ft Run ID: ORGCMS2_130718B SeqNo: 1090689

Analyte	Result	Limit	SPK value	SPK Ref Val	% Rec	LowLimit	HighLimit	RPD Ref Val	%RPD	RPDLimit	Qual
Methyl tert-butyl ether (MTBE)	0.3576	0.025	0.400	0	89.4%	42	181	0			
Benzene	0.3574	0.0050	0.400	0	89.4%	71	142	0			
Toluene	0.4706	0.0050	0.400	0	118%	65	138	0			
Ethylbenzene	0.4228	0.0050	0.400	0.00270	105%	84	140	0			
m,p-Xylene	0.8802	0.010	0.800	0	110%	86	133	0			
o-Xylene	0.4178	0.0050	0.400	0.00330	104%	69	134	0			
Surrogate: Toluene-d8	102	0.10	100	0	102%	70	130	0			

Sample ID: 1307271-01AMS Batch ID: 29307 Test Code: GASS-MS Units: mg/kg Analysis Date 7/18/2013 2:24:00 PM Prep Date: 7/18/2013
 Client ID: B-300 @ 4 ft Run ID: ORGCMS3_130718A SeqNo: 1090655

Analyte	Result	Limit	SPK value	SPK Ref Val	% Rec	LowLimit	HighLimit	RPD Ref Val	%RPD	RPDLimit	Qual
TPHC Gasoline	19.08	1.0	20.0	0	95.4%	20	156	0			

Qualifiers: ND - Not Detected at the Reporting Limit S - Spike Recovery outside accepted recovery limits B - Analyte detected in the associated Method Blank
 J - Analyte detected below quantitation limits R - RPD outside accepted recovery limits

CLIENT: SHN Consulting Engineers and Geologists
Work Order: 1307271
Project: 005287 Don's Rent All

QC SUMMARY REPORT
Sample Matrix Spike

Sample ID: 1307271-01AMS Batch ID: 29308 Test Code: TPHDMS Units: mg/kg Analysis Date: 7/18/2013 6:54:58 PM Prep Date: 7/18/2013
Client ID: B-300 @ 4 ft Run ID: ORGC14_130718A SeqNo: 1090742

Analyte	Result	Limit	SPK value	SPK Ref Val	% Rec	LowLimit	HighLimit	RPD Ref Val	%RPD	RPDLimit	Qual
TPHC Diesel (C12-C22)	9.892	1.0	10.0	0.647	92.4%	83	122	0			
TPHC Motor Oil	27.21	10	20.0	3.97	116%	78	131	0			

Qualifiers: ND - Not Detected at the Reporting Limit S - Spike Recovery outside accepted recovery limits B - Analyte detected in the associated Method Blank
 J - Analyte detected below quantitation limits R - RPD outside accepted recovery limits

CLIENT: SHN Consulting Engineers and Geologists
Work Order: 1307271
Project: 005287 Don's Rent All

QC SUMMARY REPORT
 Laboratory Control Spike

Sample ID:	Batch ID:	Test Code:	Units:	Analysis Date:	Prep Date:						
LCS-13207	R75166	8260EW	µg/L	7/19/2013 10:46:00 PM							
Client ID:	Run ID:	ORGCMS2_130719B	SeqNo:	1091080							
Analyte	Result	Limit	SPK value	SPK Ref Val	% Rec	LowLimit	HighLimit	RPD Ref Val	%RPD	RPDLimit	Qual
Methyl tert-butyl ether (MTBE)	20.69	0.50	20.0	0	103%	60	136	0			
Benzene	19.77	0.50	20.0	0	98.9%	74	118	0			
Toluene	18.32	0.50	20.0	0	91.6%	76	133	0			
Ethylbenzene	18.66	0.50	20.0	0	93.3%	77	129	0			
m,p-Xylene	36.72	0.50	40.0	0	91.8%	82	129	0			
o-Xylene	18.21	0.50	20.0	0	91.0%	84	126	0			
Surrogate: Dibromofluoromethane	0.966	0.10	1.00	0	96.6%	72	120	0			
Surrogate: 1,2-Dichloroethane-d4	1.06	0.10	1.00	0	106%	69	126	0			
Surrogate: Toluene-d8	0.994	0.10	1.00	0	99.4%	78	137	0			

Sample ID:	Batch ID:	Test Code:	Units:	Analysis Date:	Prep Date:						
LCSD-13207	R75166	8260EW	µg/L	7/19/2013 11:14:00 PM							
Client ID:	Run ID:	ORGCMS2_130719B	SeqNo:	1091081							
Analyte	Result	Limit	SPK value	SPK Ref Val	% Rec	LowLimit	HighLimit	RPD Ref Val	%RPD	RPDLimit	Qual
Methyl tert-butyl ether (MTBE)	17.28	0.50	20.0	0	86.4%	60	136	20.7	18.0%	30	
Benzene	19.39	0.50	20.0	0	97.0%	74	118	19.8	1.92%	30	
Toluene	17.74	0.50	20.0	0	88.7%	76	133	18.3	3.25%	30	
Ethylbenzene	21.18	0.50	20.0	0	106%	77	129	18.7	12.7%	30	
m,p-Xylene	42.36	0.50	40.0	0	106%	82	129	36.7	14.3%	30	
o-Xylene	20.61	0.50	20.0	0	103%	84	126	18.2	12.4%	30	
Surrogate: Dibromofluoromethane	0.983	0.10	1.00	0	98.3%	72	120	0.966	1.78%	30	
Surrogate: 1,2-Dichloroethane-d4	0.998	0.10	1.00	0	99.9%	69	126	1.06	5.52%	30	
Surrogate: Toluene-d8	1.00	0.10	1.00	0	100%	78	137	0.994	0.772%	30	

Qualifiers: ND - Not Detected at the Reporting Limit S - Spike Recovery outside accepted recovery limits B - Analyte detected in the associated Method Blank
 J - Analyte detected below quantitation limits R - RPD outside accepted recovery limits

CLIENT: SHN Consulting Engineers and Geologists
Work Order: 1307271
Project: 005287 Don' s Rent All

QC SUMMARY REPORT
 Laboratory Control Spike

Sample ID:	Batch ID:	Test Code:	Units:	Analysis Date	Prep Date:						
LCS-29307	29307	8260OXYS	mg/kg	7/18/2013 3:36:00 PM	7/18/2013						
Client ID:		Run ID:		SeqNo:							
		ORGCMS2_130718B		1090687							
Analyte	Result	Limit	SPK value	SPK Ref Val	% Rec	LowLimit	HighLimit	RPD Ref Val	%RPD	RPDLimit	Qual
Methyl tert-butyl ether (MTBE)	0.3222	0.025	0.400	0	80.5%	42	181	0			
Benzene	0.3298	0.0050	0.400	0	82.4%	71	142	0			
Toluene	0.4381	0.0050	0.400	0	110%	65	138	0			
Ethylbenzene	0.3712	0.0050	0.400	0	92.8%	84	140	0			
m,p-Xylene	0.7770	0.010	0.800	0	97.1%	86	133	0			
o-Xylene	0.3514	0.0050	0.400	0	87.8%	69	134	0			
Surrogate: Toluene-d8	108	0.10	100	0	108%	70	130	0			

Sample ID:	Batch ID:	Test Code:	Units:	Analysis Date	Prep Date:						
LCSD-29307	29307	8260OXYS	mg/kg	7/18/2013 4:04:00 PM	7/18/2013						
Client ID:		Run ID:		SeqNo:							
		ORGCMS2_130718B		1090688							
Analyte	Result	Limit	SPK value	SPK Ref Val	% Rec	LowLimit	HighLimit	RPD Ref Val	%RPD	RPDLimit	Qual
Methyl tert-butyl ether (MTBE)	0.4191	0.025	0.400	0	105%	42	181	0.322	26.1%	30	
Benzene	0.3968	0.0050	0.400	0	99.2%	71	142	0.330	18.4%	30	
Toluene	0.5131	0.0050	0.400	0	128%	65	138	0.438	15.8%	30	
Ethylbenzene	0.4333	0.0050	0.400	0	108%	84	140	0.371	15.4%	30	
m,p-Xylene	0.9091	0.010	0.800	0	114%	86	133	0.777	15.7%	30	
o-Xylene	0.4289	0.0050	0.400	0	107%	69	134	0.351	19.9%	30	
Surrogate: Toluene-d8	116	0.10	100	0	116%	70	130	108	7.26%	30	

Sample ID:	Batch ID:	Test Code:	Units:	Analysis Date	Prep Date:						
LCSG-29307	29307	GASS-MS	mg/kg	7/18/2013 1:31:00 PM	7/18/2013						
Client ID:		Run ID:		SeqNo:							
		ORGCMS3_130718A		1090653							
Analyte	Result	Limit	SPK value	SPK Ref Val	% Rec	LowLimit	HighLimit	RPD Ref Val	%RPD	RPDLimit	Qual
TPHC Gasoline	25.96	1.0	20.0	0	130%	75	138	0			

Qualifiers: ND - Not Detected at the Reporting Limit S - Spike Recovery outside accepted recovery limits B - Analyte detected in the associated Method Blank
 J - Analyte detected below quantitation limits R - RPD outside accepted recovery limits

CLIENT: SHN Consulting Engineers and Geologists
Work Order: 1307271
Project: 005287 Don' s Rent All

QC SUMMARY REPORT
 Laboratory Control Spike Duplicate

Sample ID: LCSDG-29307 Batch ID: 29307 Test Code: GASS-MS Units: mg/kg Analysis Date 7/18/2013 1:57:00 PM Prep Date: 7/18/2013
 Client ID: Run ID: ORGCMS3_130718A SeqNo: 1090654

Analyte	Result	Limit	SPK value	SPK Ref Val	% Rec	LowLimit	HighLimit	RPD Ref Val	%RPD	RPDLimit	Qual
TPHC Gasoline	26.07	1.0	20.0	0	130%	75	138	26.0	0.427%	20	

Sample ID: LCS-13211 Batch ID: R75168 Test Code: GASW-MS Units: µg/L Analysis Date 7/23/2013 11:50:00 PM Prep Date:
 Client ID: Run ID: ORGCMS3_130723C SeqNo: 1091100

Analyte	Result	Limit	SPK value	SPK Ref Val	% Rec	LowLimit	HighLimit	RPD Ref Val	%RPD	RPDLimit	Qual
TPHC Gasoline	1,017	50	1,000	0	102%	72	124	0			

Sample ID: LCSD-13211 Batch ID: R75168 Test Code: GASW-MS Units: µg/L Analysis Date 7/24/2013 12:17:00 AM Prep Date:
 Client ID: Run ID: ORGCMS3_130723C SeqNo: 1091101

Analyte	Result	Limit	SPK value	SPK Ref Val	% Rec	LowLimit	HighLimit	RPD Ref Val	%RPD	RPDLimit	Qual
TPHC Gasoline	1,035	50	1,000	0	103%	72	124	1,020	1.72%	20	

Sample ID: LCS-29308 Batch ID: 29308 Test Code: TPHDMS Units: mg/kg Analysis Date 7/18/2013 5:51:25 PM Prep Date: 7/18/2013
 Client ID: Run ID: ORGC14_130718A SeqNo: 1090740

Analyte	Result	Limit	SPK value	SPK Ref Val	% Rec	LowLimit	HighLimit	RPD Ref Val	%RPD	RPDLimit	Qual
TPHC Diesel (C12-C22)	9.997	1.0	10.0	0	100%	83	122	0			
TPHC Motor Oil	20.61	10	20.0	0	103%	78	131	0			

Sample ID: LCSD-29308 Batch ID: 29308 Test Code: TPHDMS Units: mg/kg Analysis Date 7/18/2013 6:23:11 PM Prep Date: 7/18/2013
 Client ID: Run ID: ORGC14_130718A SeqNo: 1090741

Analyte	Result	Limit	SPK value	SPK Ref Val	% Rec	LowLimit	HighLimit	RPD Ref Val	%RPD	RPDLimit	Qual
TPHC Diesel (C12-C22)	10.01	1.0	10.0	0	100%	83	122	10.0	0.125%	30	
TPHC Motor Oil	20.63	10	20.0	0	103%	78	131	20.6	0.107%	30	

Qualifiers: ND - Not Detected at the Reporting Limit S - Spike Recovery outside accepted recovery limits B - Analyte detected in the associated Method Blank
 J - Analyte detected below quantitation limits R - RPD outside accepted recovery limits

CLIENT: SHN Consulting Engineers and Geologists
Work Order: 1307271
Project: 005287 Don' s Rent All

QC SUMMARY REPORT
 Laboratory Control Spike

Sample ID: LCS-29305	Batch ID: 29305	Test Code: TPHDMW	Units: µg/L	Analysis Date: 7/18/2013 11:03:24 PM	Prep Date: 7/18/2013						
Client ID:	Run ID: ORGC14_130718B	SeqNo: 1090752									
Analyte	Result	Limit	SPK value	SPK Ref Val	% Rec	LowLimit	HighLimit	RPD Ref Val	%RPD	RPDLimit	Qual
TPHC Diesel (C12-C22)	475.1	50	500	0	95.0%	75	126	0			
TPHC Motor Oil	1,034	170	1,000	0	103%	80	130	0			

Sample ID: LCSD-29305	Batch ID: 29305	Test Code: TPHDMW	Units: µg/L	Analysis Date: 7/18/2013 11:34:03 PM	Prep Date: 7/18/2013						
Client ID:	Run ID: ORGC14_130718B	SeqNo: 1090753									
Analyte	Result	Limit	SPK value	SPK Ref Val	% Rec	LowLimit	HighLimit	RPD Ref Val	%RPD	RPDLimit	Qual
TPHC Diesel (C12-C22)	470.4	50	500	0	94.1%	75	126	475	1.01%	30	
TPHC Motor Oil	1,018	170	1,000	0	102%	80	130	1,030	1.55%	30	

Qualifiers: ND - Not Detected at the Reporting Limit S - Spike Recovery outside accepted recovery limits B - Analyte detected in the associated Method Blank
 J - Analyte detected below quantitation limits R - RPD outside accepted recovery limits

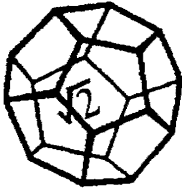

NORTH COAST LABORATORIES LTD.

5680 West End Road • Arcata • CA 95521-9202
707-822-4649 Fax 707-822-6831

Chain of Custody

P. 1 of 1

Attention: Roland Rucher
 Results & Invoice to: 812 W. Wabash SHN
 Address: 812 W. Wabash Ave
Forty CA 95501
 Phone: 707-441-8855
 Copies of Report to: _____
 Sampler (Sign & Print): Brenda Howell

PROJECT INFORMATION
 Project Number: 005287
 Project Name: Pon's Rent All
 Purchase Order Number: _____

LAB ID	SAMPLE ID	DATE	TIME	MATRIX
	B-300@4ft	7/16/13	18:00	S
	B-300 @ 8ft		18:05	S
	B-300@12ft		18:10	S
	B-300		18:30	GW
	B-301 @ 4ft		18:50	S
	B-301 @ 8ft		18:55	S
	B-301 @ 12ft		19:00	S
	B-301	↓	19:30	GW

CONTAINER PRESERVATIVE ANALYSIS	HCL																					
	None																					
	B																					
	9																					
	BTEX/MIBX																					
	TPH/D/TPHMO																					

LABORATORY NUMBER: 150701
 TAT: STD (3-5 Wk) Other: 5 day turnaround
 PRIOR AUTHORIZATION IS REQUIRED FOR RUSH SAMPLES.

REPORTING REQUIREMENTS:
 State Forms
 Geotracker SWAMP Other EDD:
 Final Report PDF FAX By:

CONTAINER CODES: 1—½ gal. pl; 2—250 ml pl; 3—500 ml pl; 4—1 L Nalgene; 5—250 ml BG; 6—500 ml BG; 7—1 L BG; 8—40 ml VOA; 9—60 ml VOA; 10—125 ml VOA; 11—4 oz glass jar; 12—8 oz glass jar; 13—brass tube; 14—other
PRESERVATIVE CODES: a—HNO₃; b—HCl; c—H₂SO₄; d—Na₂S₂O₃; e—NaOH; f—C₂H₅O₂Cl; g—other

SPECIAL INSTRUCTIONS	SAMPLE CONDITION
	Temperature <u>2.4 °C</u>
	Received On Ice? <u>Y/N</u>
	Samples Intact? <u>Y/N</u>
	Preserved? <u>Y/N</u>
	Preserved @ NCL? <u>Y/N/NA</u>

RELINQUISHED BY (Sign & Print)	DATE/TIME	RECEIVED BY (Sign)	DATE/TIME
<u>Brenda Howell</u>	7/17/13 8:50	<u>RG</u>	7/17/13 0850

SAMPLE DISPOSAL
 NCL Disposal of Non-Contaminated
 Return Pickup

CHAIN OF CUSTODY SEALS Y/N/NA _____
 SHIPPED VIA: UPS Fed-Ex Hand

*MATRIX: DW=Drinking Water; Eff=Effluent; Inf=Influent; SW=Surface Water; GW=Ground Water; WW=Waste Water; S=Soil; O=Other.

ALL CONTAMINATED NON-AQUEOUS SAMPLES WILL BE RETURNED TO CLIENT

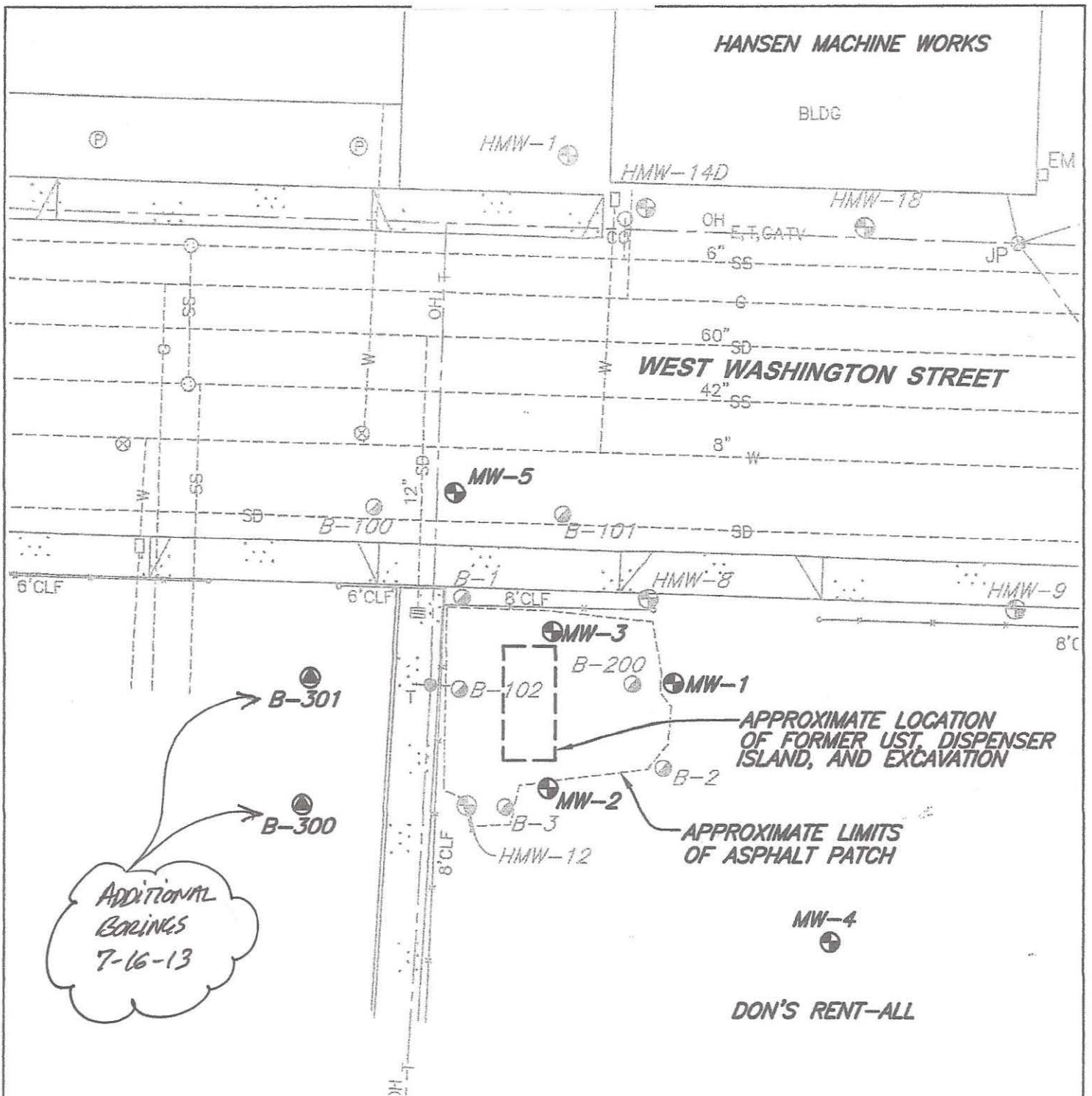

EXPLANATION

- 
HANSEN MONITORING WELL LOCATION AND DESIGNATION
 HMW-8
- 
DON'S RENT-ALL MONITORING WELL LOCATION AND DESIGNATION
 MW-2
- 
SOIL BORING LOCATION AND DESIGNATION (LOCATION APPROXIMATE)
 B-101
- 
SOIL BORING/ TEMPORARY WELL POINT LOCATION AND DESIGNATION
 B-300

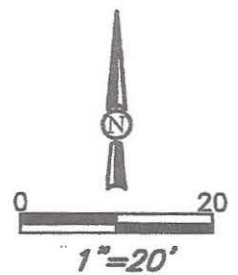

 Consulting Engineers & Geologists, Inc.	Don's Rent-All 916 Broadway Ave Eureka, California	Site Plan SHN 005287
	July 2013	005287-SITE

Mark Verhey

Boring Installation Report, Don's Rent-All, 916 Broadway, Eureka, California; LOP Case No. 12794

July 26, 2013

Page 4

Table 1
Soil Analytical Results, July 16, 2013
Don's Rent-All, Eureka, California
(in mg/kg)¹

Sample Location & Depth (feet BGS) ²	TPHD ³	TPHMO ³	TPHG ⁴	Benzene ⁴	Toluene ⁴	Ethylbenzene ⁴	Total xylenes ⁴	MTBE ⁴
1. mg/kg: milligrams per kilogram 2. BGS: below ground surface 3. Total petroleum hydrocarbons as diesel (TPHD) and motor oil (TPHMO), analyzed in general accordance with EPA Method No. 8015B 4. Total petroleum hydrocarbons as gasoline (TPHG), benzene (B), toluene (T), ethylbenzene (E), total xylenes (X), and methyl tertiary-butyl ether (MTBE) analyzed in general accordance with EPA Method No. 8260B or 8260B Modified 5. <: "less than" the stated method reporting limit 6. The sample does not have the typical pattern of fresh motor oil. However, the result reported represents the amount of material in the motor oil range.								

Historical soil analytical data is presented in Attachment 2. The complete analytical reports, chain-of-custody, and laboratory quality control data are included in Attachment 3.

3.2 Temporary Well Point Analytical Results

The laboratory analytical results for the temporary well point samples collected on July 16, 2013, are summarized in Table 2.

Table 2
Temporary Well-Point Groundwater Analytical Results, July 16, 2013
Don's Rent-All, Eureka, California
(in ug/L)¹

Sample Location	TPHD ²	TPHMO ²	TPHG ³	Benzene ³	Toluene ³	Ethylbenzene ³	Total xylenes ³	MTBE
B-300	<50 ⁴	<170	<50	<0.50	<0.50	<0.50	<1.0	2.6
B-301	<50	<170	<50	<0.50	<0.50	<0.50	<1.0	24
1. ug/L: micrograms per liter 2. Total petroleum hydrocarbons as diesel (TPHD) and motor oil (TPHMO), analyzed in general accordance with EPA Method No. 8015B 3. Total petroleum hydrocarbons as gasoline (TPHG), benzene, toluene, ethylbenzene, m,p and -o-xylenes, analyzed in general accordance with EPA Method No. 8260B or 8260B Modified 4. <: "less than" the stated method reporting limit								

Historical groundwater analytical data is presented in Attachment 2. The complete laboratory test results and corresponding chain-of-custody documentation are included in Attachment 3.

Don's Rent-All
 916 Broadway Avenue, Eureka

- Residual Petroleum Constituents Pose Significant Direct Contact and Outdoor Air Exposure to Human Health: No – There are no soil samples results in the case record for naphthalene. However, the relative concentration of naphthalene in soil can be conservatively estimated using the published relative concentrations of naphthalene and benzene in gasoline. Taken from Potter and Simmons (1998), gasoline mixtures contain approximately 2% benzene and 0.25% naphthalene. Therefore, benzene concentrations can be directly substituted for naphthalene concentrations with a safety factor of eight. Benzene concentrations from the Site are below the naphthalene thresholds in Table 1 of the Policy. Therefore, estimated naphthalene concentrations meet the thresholds in Table 1 and the Policy criteria for direct contact by a factor of eight. It is highly unlikely that naphthalene concentrations in the soil, if any, exceed the threshold.

MTBE in Groundwater Map

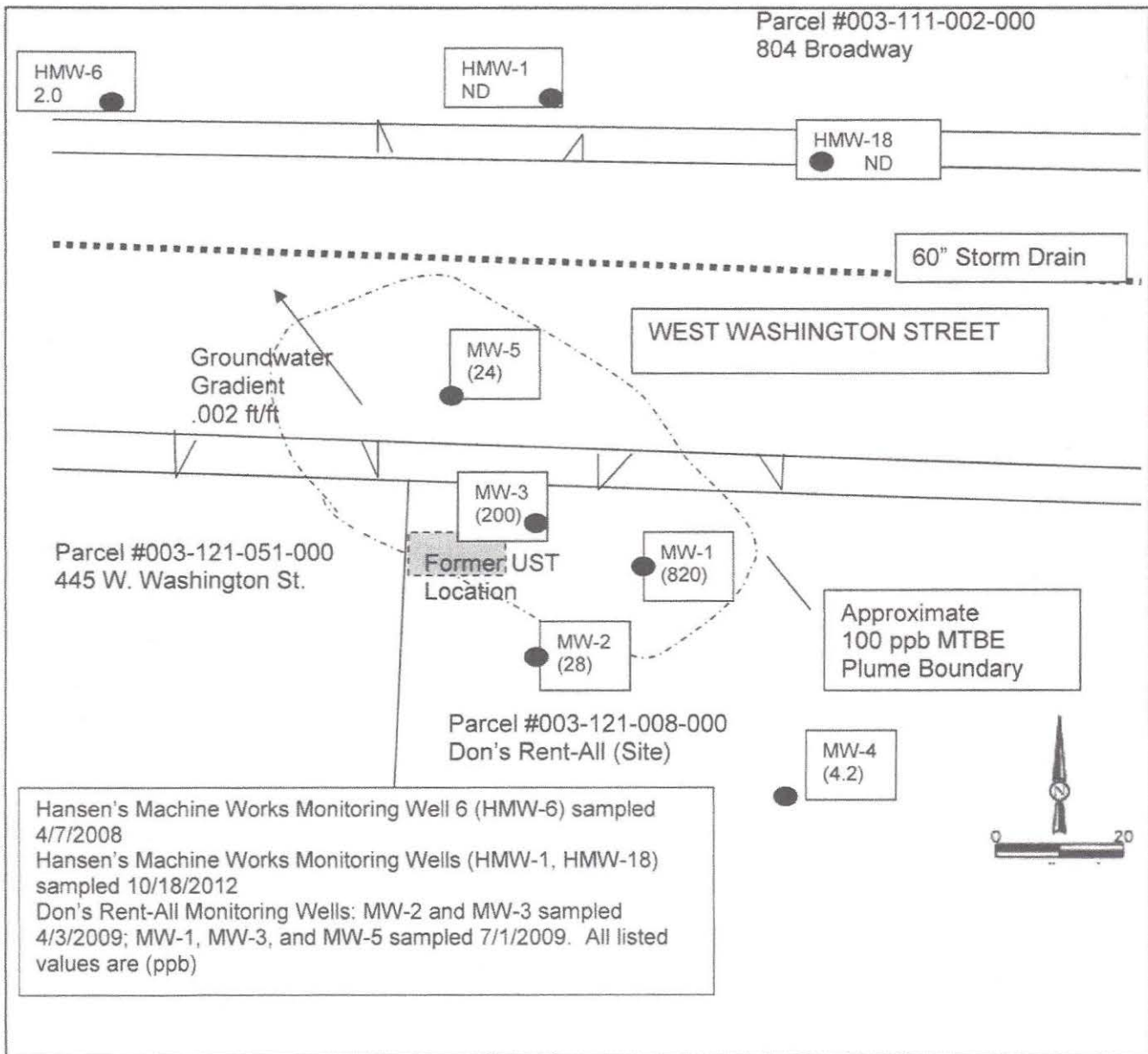

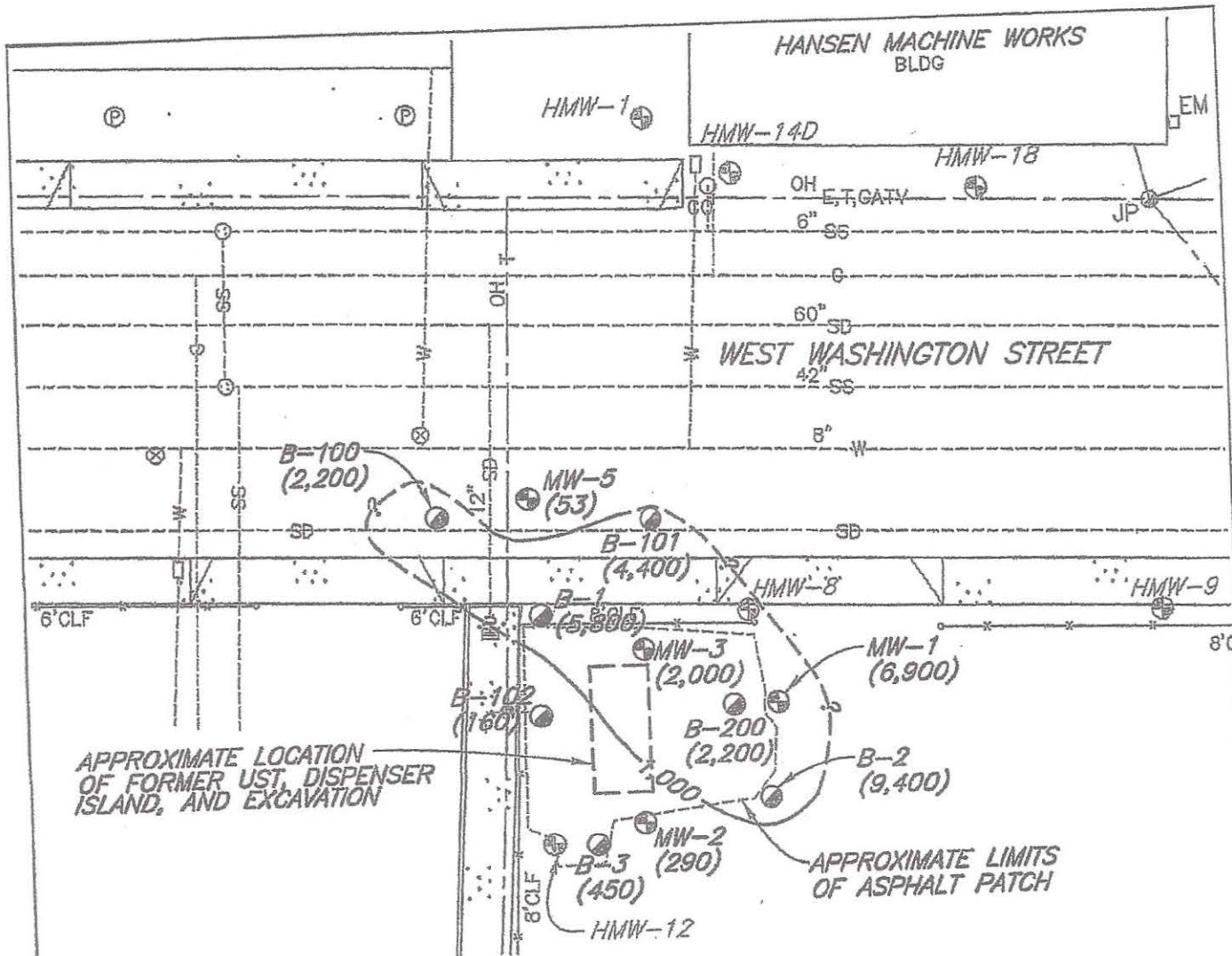

EXPLANATION

- HANSEN MONITORING WELL LOCATION AND DESIGNATION
- DON'S RENT-ALL MONITORING WELL LOCATION AND DESIGNATION
- SOIL BORING LOCATION AND DESIGNATION (LOCATION APPROXIMATE)
- TPHG RESULTS IN ug/L
- TPHG CONCENTRATION IN ug/L
- APPROXIMATE RANGE OF HISTORIC GROUNDWATER FLOW DIRECTION

MW-4 (<50)
DON'S RENT-ALL

NOTE: THE FIGURE INCLUDES GROUNDWATER ANALYTICAL RESULTS FOR WELLS MW-1, MW-3, & MW-5 FROM THE 7/1/09 MONITORING EVENT & FOR WELLS MW-2 & MW-4 FROM THE 4/3/09 MONITORING EVENT RESULTS FROM B-200 FROM DISCRETE WATER SAMPLE COLLECTED AT 10-11' BGS

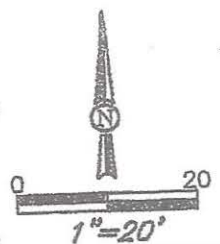

I:\2005\005287\DWG\SAVED: 10/19/2009 8:42 AM KRUEBER, PLOTTED: 10/19/2009 8:43 AM, ROLAND M. KRUEBER

SHW
Consulting Engineers
& Geologists, Inc.

Don's Rent-All
916 Broadway Ave.
Eureka, California
May 2009

TPHG Concentrations in Groundwater
SHN 005287

005287-GW-TPHG

Figure 9

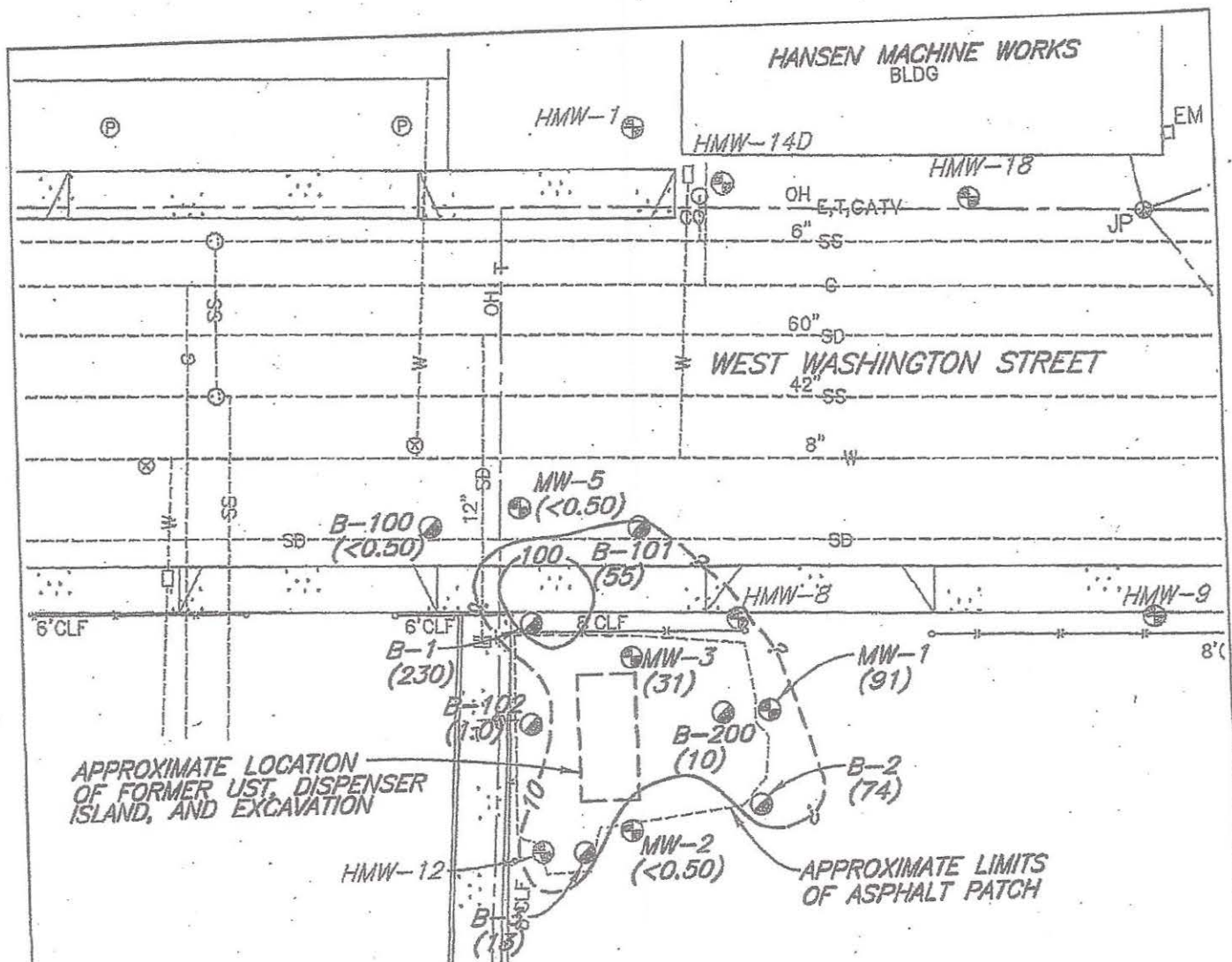

EXPLANATION

- ⊕ HMW-8 HANSEN MONITORING WELL LOCATION AND DESIGNATION
- ⊕ MW-2 DON'S RENT-ALL MONITORING WELL LOCATION AND DESIGNATION
- B-101 SOIL BORING LOCATION AND DESIGNATION (LOCATION APPROXIMATE)
- (99) BENZENE RESULTS IN ug/L
- 10- BENZENE CONCENTRATION IN ug/L
- APPROXIMATE RANGE OF HISTORIC GROUNDWATER FLOW DIRECTION

⊕ MW-4 (<0.50)
DON'S RENT-ALL

NOTE: THE FIGURE INCLUDES GROUNDWATER ANALYTICAL RESULTS FOR WELLS MW-1, MW-3, & MW-5 FROM THE 7/1/09 MONITORING EVENT & FOR WELLS MW-2 & MW-4 FROM THE 4/3/09 MONITORING EVENT RESULTS FROM B-200 FROM DISCRETE WATER SAMPLE COLLECTED AT 10-11' BGS

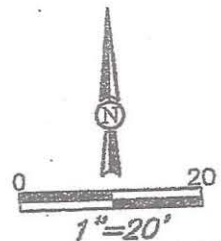

SHW
Consulting Engineers
& Geologists, Inc.

Don's Rent-All
916 Broadway Ave.
Eureka, California

Benzene Concentrations in Groundwater

SHN 005287

May 2009

005287-GW-BZENE

Figure 10

P:\2005\005287\DWG, SAVED: 7/20/2009 11:29 AM CNEWELL, PLOTTED: 9/23/2009 4:49 PM, CHRIS D. NEWELL

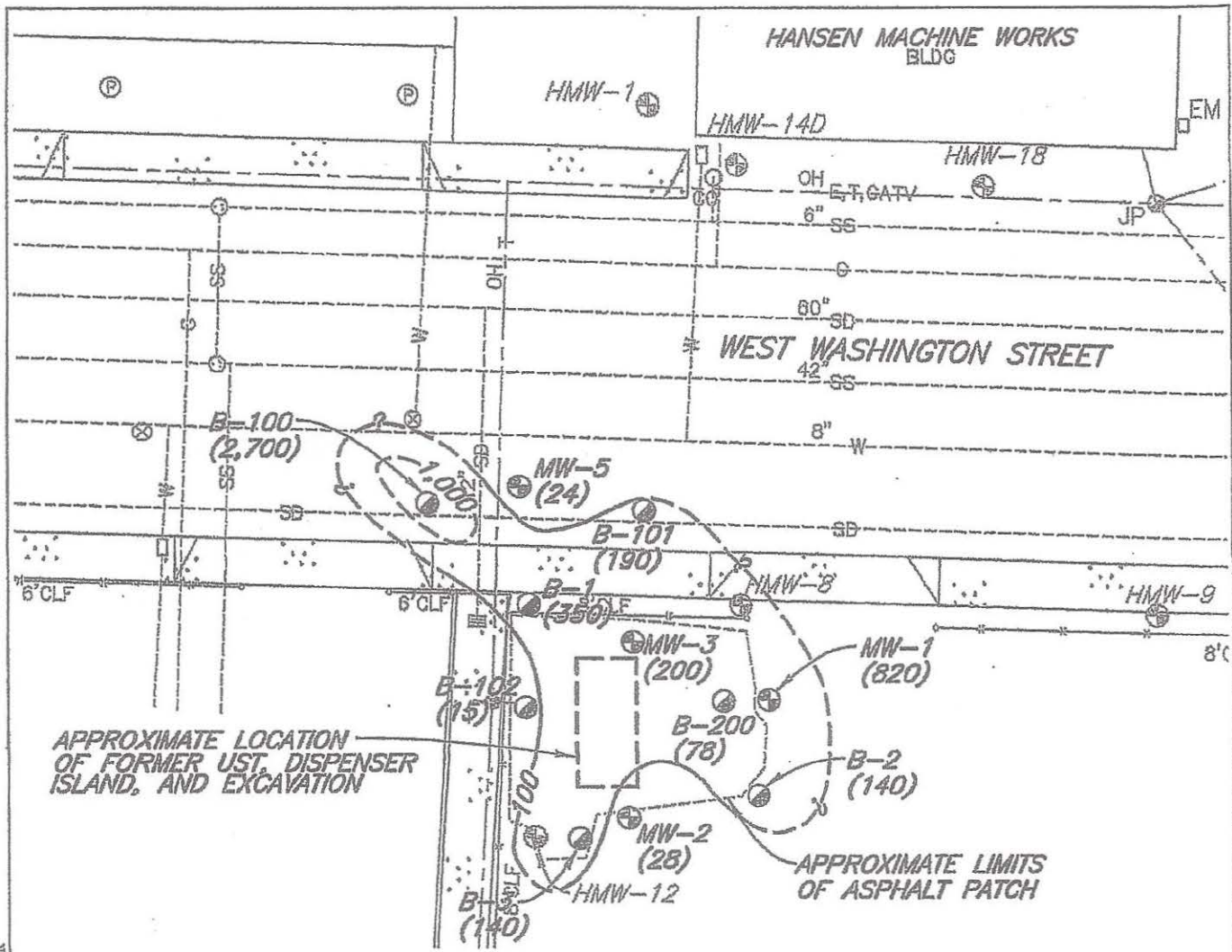

EXPLANATION

- HANSEN MONITORING WELL LOCATION AND DESIGNATION
- DON'S RENT-ALL MONITORING WELL LOCATION AND DESIGNATION
- SOIL BORING LOCATION AND DESIGNATION (LOCATION APPROXIMATE)
- (140) MTBE RESULTS IN ug/L
- 1,000- MTBE CONCENTRATION IN ug/L
- APPROXIMATE RANGE OF HISTORIC GROUNDWATER FLOW DIRECTION
- MW-4 (4.2)
- DON'S RENT-ALL

NOTE: THE FIGURE INCLUDES GROUNDWATER ANALYTICAL RESULTS FOR WELLS MW-1, MW-3, & MW-5 FROM THE 7/1/09 MONITORING EVENT & FOR WELLS MW-2 & MW-4 FROM THE 4/3/09 MONITORING EVENT RESULTS FROM B-200 FROM DISCRETE WATER SAMPLE COLLECTED AT 10-11' BGS

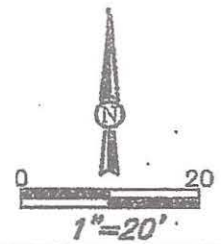

E:\JOHN\09057\JOHN.DWG, SAVED: 10/19/2009 8:47 AM, PLOTTED: 10/19/2009 8:47 AM, ROLAND M. RUBBER

	Don's Rent-All 916 Broadway Ave. Eureka, California	MTBE Concentrations in Groundwater	
	May 2009	SHN 005287	005287-GW-MTBE

Figure 11