

**CALIFORNIA REGIONAL WATER QUALITY CONTROL BOARD
SAN DIEGO REGION**

2375 Northside Drive, Suite.100, San Diego, CA 92108
Phone (619) 516-1990 • Fax (619) 516-1994
<http://www.waterboards.ca.gov/sandiego/>

**Clean Water Act Section 401 Water Quality Certification
and Waste Discharge Requirements
for Discharge of Dredged and/or Fill Materials**

**PROJECT: Lakeside Fire Station No. 1 Project
Certification Number R9-2018-0064
WDID: 9 000003283**

Reg. Meas. ID: 420310
Place ID: 845905
Party ID: 575098
Person ID: 575099

**APPLICANT: Lakeside Fire Protection District
1566 Melvin Lane
San Diego, CA 92021**

ACTION:

<input type="checkbox"/> Order for Low Impact Certification	<input type="checkbox"/> Order for Denial of Certification
<input checked="" type="checkbox"/> Order for Technically-conditioned Certification	<input type="checkbox"/> Waiver of Waste Discharge Requirements
<input checked="" type="checkbox"/> Enrollment in SWRCB GWDR Order No. 2003-017-DWQ	<input type="checkbox"/> Enrollment in Isolated Waters Order No. 2004-004-DWQ

PROJECT DESCRIPTION

An application dated March 23, 2018 was submitted by the Lakeside Fire Protection District (hereinafter Applicant), for Water Quality Certification pursuant to section 401 of the Clean Water Act (33 U.S.C. § 1341) for the proposed Lakeside Fire Station No. 1 Project (Project). The Applicant has also applied for Clean Water Act section 404 Nationwide Permit No. 39 from the United States Army Corps of Engineers for the Project (USACE File Nos. SPL-2018-00199-JDR).

The Project is located within the City of El Cajon, San Diego County, California at 8335 Winter Gardens Boulevard. The Project's center reading is located at latitude 32.823380 and longitude -116.9325420. The Applicant has paid all required fees for this Certification in the amount of \$1,500.00. On June 8, 2018, the San Diego Water Board provided public notice of the Project application pursuant to California Code of Regulations, title 23, section 3858 by posting information describing the Project on the San Diego Water Board's web site and providing a period of twenty-one days for public review and comment. No comments were received.

The Applicant proposes to fill the 0.01 acre (273 linear feet) of existing ephemeral stream channel and convey the surface water in two 54-inch diameter underground pipes for the purpose of constructing a permanent driveway to provide secondary access for emergency vehicles to the fire station. The new driveway would extend from Royal Road to the rear of the temporary fire station to allow fire trucks to enter from Royal Road to the station and exit to Winter Gardens Boulevard. These improvements are expected to improve fire personnel

readiness, response times, and public safety. The Applicant reports that the Project purpose cannot be practically accomplished in a manner which would avoid or result in less adverse impacts to aquatic resources considering all potential practicable alternatives, such as the potential for alternate available locations, designs, reductions in size, configuration or density.

Receiving waters potentially affected by the Project are protected in accordance with water quality standards in the *Water Quality Control Plan for the San Diego Basin (9)* (Basin Plan). This Certification authorizes permanent impacts to waters of the United States and/or State affected by the Project and requires compensatory mitigation to offset adverse impacts as described in section IV of the Certification. Compensatory mitigation to offset the permanent loss of jurisdictional waters will be achieved through the Applicant's purchase of mitigation bank credits from the San Luis Rey Mitigation Bank (Bank) in advance of Project construction. Mitigation credit parcels, purchased from the Bank to satisfy compensatory mitigation requirements, are required to be protected, monitored and maintained in perpetuity by the Bank pursuant to a federal and State approved bank enabling instrument and a recorded conservation easement. Based on all of these considerations, the Applicant's compliance with the terms and conditions of this Certification will ensure that the water quality standards for all waters of the United States and/or State impacted by the Project are met.

TABLE OF CONTENTS

I.	STANDARD CONDITIONS	4
II.	GENERAL CONDITIONS.....	4
III.	PROJECT IMPACTS AND COMPENSATORY MITIGATION	7
IV.	MONITORING AND REPORTING REQUIREMENTS.....	9
V.	NOTIFICATION REQUIREMENTS	11
VI.	CALIFORNIA ENVIRONMENTAL QUALITY ACT COMPLIANCE	12
VII.	SAN DIEGO WATER BOARD CONTACT PERSON.....	13
VIII.	WATER QUALITY CERTIFICATION	13

Attachments:

- 1. Definitions**
- 2. Project Figures and Plans**
- 3. CEQA Mitigation Monitoring and Reporting Program**

The San Diego Water Board has independently reviewed the record of the Project to analyze the extent and nature of proposed Project impacts to the water quality and beneficial uses of waters of the United States and/or State and associated compensatory mitigation required to offset impacts attributed to the Project. In accordance with this Certification, the Applicant may proceed with the Project under the following terms and conditions:

I. STANDARD CONDITIONS

Pursuant to section 3860 of title 23 of the California Code of Regulations, the following three standard conditions apply to all water quality certification actions:

- A. This Certification action is subject to modification or revocation upon administrative or judicial review, including review and amendment pursuant to section 13330 of the Water Code and chapter 28, article 6 (commencing with title 23, section 3867), of the California Code of Regulations.
- B. This Certification action is not intended and shall not be construed to apply to any discharge from any activity involving a hydroelectric facility and requiring a Federal Energy Regulatory Commission (FERC) license or an amendment to a FERC license unless the pertinent Certification application was filed pursuant to California Code of Regulations title 23, section 3855 subdivision (b), and that application specifically identified that a FERC license or amendment to a FERC license for a hydroelectric facility was being sought.
- C. This Certification action is conditioned upon total payment of any fee required under title 23, chapter 28 (commencing with section 3830) of California Code of Regulations and owed by the applicant.

II. GENERAL CONDITIONS

- A. **Term of Certification.** Water Quality Certification No. R9-2018-0064 (Certification) shall expire upon a) the expiration or retraction of the Clean Water Act section 404 (33 U.S.C. §1344) permit issued by the U.S. Army Corps of Engineers for this Project, or b) five (5) years from the date of issuance of this Certification, whichever occurs first.
- B. **Duty to Comply.** The Applicant must comply with all conditions and requirements of this Certification. Any Certification noncompliance constitutes a violation of the Water Code and is grounds for enforcement action or Certification termination, revocation and reissuance, or modification.
- C. **General Waste Discharge Requirements.** The requirements of this Certification are enforceable through Water Quality Order No. 2003-0017-DWQ, *Statewide General Waste Discharge Requirements for Discharges of Dredged or Fill Material that have Received State Water Quality Certification* (Water Quality Order No. 2003-0017-DWQ). This provision shall apply irrespective of whether a) the federal permit for which the Certification was obtained is subsequently retracted or is expired, or b) the Certification is expired. Water Quality Order No. 2003-0017-DWQ is accessible at:

http://www.waterboards.ca.gov/water_issues/programs/cwa401/docs/generalorders/go_wdr401regulated_projects.pdf.

- D. Project Conformance with Application.** All water quality protection measures and BMPs described in the application and supplemental information for water quality certification are incorporated by reference into this Certification as if fully stated herein. Notwithstanding any more specific conditions in this Certification, the Applicant shall construct, implement and comply with all water quality protection measures and BMPs described in the application and supplemental information. The conditions within this Certification shall supersede conflicting provisions within the application and supplemental information submitted as part of this Certification action.
- E. Project Conformance with Water Quality Control Plans or Policies.** Notwithstanding any more specific conditions in this Certification, the Project shall be constructed in a manner consistent with the Basin Plan and any other applicable water quality control plans or policies adopted or approved pursuant to the Porter Cologne Water Quality Act (Division 7, commencing with Water Code Section 13000) or section 303 of the Clean Water Act (33 U.S.C §1313.). The Basin Plan is accessible on-line at:
- http://www.waterboards.ca.gov/sandiego/water_issues/programs/basin_plan/index.shtml
!
- F. Project Modification.** The Applicant must submit any changes to the Project, including Project operation, which would have a significant or material effect on the findings, conclusions, or conditions of this Certification, to the San Diego Water for prior review and written approval. If the San Diego Water Board is not notified of a significant change to the Project, it will be considered a violation of this Certification
- G. Certification Distribution Posting.** During Project construction, the Applicant must maintain a copy of this Certification at the Project site. This Certification must be available at all times to site personnel and agencies. A copy of this Certification shall also be provided to any contractor or subcontractor performing construction work, and the copy shall remain in their possession at the Project site.
- H. Inspection and Entry.** The Applicant must allow the San Diego Water Board or the State Water Resources Control Board, and/or their authorized representative(s) (including an authorized contractor acting as their representative), upon the presentation of credentials and other documents as may be required under law, to:
1. Enter upon the Project or Compensatory Mitigation site(s) premises where a regulated facility or activity is located or conducted, or where records must be kept under the conditions of this Certification;
 2. Have access to and copy, at reasonable times, any records that must be kept under the conditions of this Certification;

3. Inspect, at reasonable times, any facilities, equipment (including monitoring and control equipment), practices, or operations regulated or required under this Certification; and
 4. Sample or monitor, at reasonable times, for the purposes of assuring Certification compliance, or as otherwise authorized by the Clean Water Act or Water Code, any substances or parameters at any location.
- I. **Enforcement Notification.** In the event of any violation or threatened violation of the conditions of this Certification, the violation or threatened violation shall be subject to any remedies, penalties, process or sanctions as provided for under State law. For purposes of section 401(d) of the Clean Water Act, the applicability of any State law authorizing remedies, penalties, process or sanctions for the violation or threatened violation constitutes a limitation necessary to assure compliance with the water quality standards and other pertinent requirements incorporated into this Certification.
- J. **Certification Actions.** This Certification may be modified, revoked and reissued, or terminated for cause including but not limited to the following:
1. Violation of any term or condition of this Certification;
 2. Monitoring results indicate that continued Project activities could violate water quality objectives or impair the beneficial uses of the unnamed tributary of Forester Creek, Forester Creek, the San Diego River, or their tributaries;
 3. Obtaining this Certification by misrepresentation or failure to disclose fully all relevant facts;
 4. A change in any condition that requires either a temporary or permanent reduction or elimination of the authorized discharge; and
 5. Incorporation of any new or revised water quality standards and implementation plans adopted or approved pursuant to the Porter-Cologne Water Quality Control Act or section 303 of the Clean Water Act.
- The filing of a request by the Applicant for modification, revocation and reissuance, or termination, or a notification of planned changes or anticipated noncompliance does not stay any Certification condition.
- K. **Duty to Provide Information.** The Applicant shall furnish to the San Diego Water Board, within a reasonable time, any information which the San Diego Water Board may request to determine whether cause exists for modifying, revoking and reissuing, or terminating this Certification or to determine compliance with this Certification.
- L. **Property Rights.** This Certification does not convey any property rights of any sort, or any exclusive privilege.

M. **Petitions.** Any person aggrieved by this action of the San Diego Water Board may petition the State Water Resources Control Board (State Water Board) to review the action in accordance with the California Code of Regulations, title 23, sections 3867 and following. The State Water Board must receive the petition by 5:00 p.m., 30 days after the date of this Certification. Copies of the law and regulations applicable to filing petitions may be found on the Internet at: http://www.waterboards.ca.gov/public_notices/petitions/water_quality or will be provided upon request.

III. CONSTRUCTION AND POST CONSTRUCTION BEST MANAGEMENT PRACTICES

- A. **Approvals to Commence Construction.** The Applicant shall not commence Project construction until all necessary federal, State, and local approvals are obtained.
- B. **Construction Requirements.** Prior to start of Project construction, the Applicant must, as applicable, obtain coverage under, and comply with, the requirements of State Water Resources Control Board Water Quality Order No. 2009-0009-DWQ, the General Permit for Storm Water Discharges Associated with Construction and Land Disturbance Activity (General Construction Storm Water Permit) and any reissuance. If Project construction activities do not require coverage under the General Construction Storm Water Permit, the Applicant must develop and implement a pollution control plan, construction BMP plan, and/or erosion and sediment control plan to prevent the discharge of sediment and other pollutants during construction activities.
- C. **Post-Construction Requirements.** The Project must meet all the Post-Construction requirements of the San Diego Water Board Order No. R9-2013-0001, National Pollutant Discharge Elimination Systems Permit and Waste Discharge Requirements for Discharges from the Municipal Separate Storm Sewer Systems (MS4) Draining the Watersheds within the San Diego Region (Regional MS4 Permit).

IV. PROJECT IMPACTS AND COMPENSATORY MITIGATION

- A. **Project Impacts and Compensatory Mitigation.** Unavoidable Project impacts to an unnamed tributary to Forester Creek within the San Diego Watershed must not exceed the type and magnitude of impacts described in the table below. At a minimum, compensatory mitigation required to offset unavoidable temporary and permanent Project impacts to waters of the United States and/or State must be achieved as described in the table below:

	Impacts (acres)	Impacts (linear ft.)	Mitigation for Impacts (acres)	Mitigation Ratio (area mitigated :area impacted)	Mitigation for Impacts (linear ft.)	Mitigation Ratio (linear feet mitigated :linear feet impacted)
Permanent Impacts						
Stream Channel	0.01 ^a	273 ^a	0.06 ^b Re-establishment	6:1 ^b	c	c

- a. Permanent loss of ephemeral stream channel waters of the U.S. and/or State as a result of the installation of two 54-inch diameter underground pipes that will convey the existing surface water for the purpose of constructing a permanent driveway for the fire station.
- b. Permanent stream channel impacts will be mitigated through the purchase of 0.06 acre of re-established riverine credits (within OHWM) from the San Luis Rey Mitigation Bank in Oceanside, CA. Mitigation purchased from the San Luis Rey Mitigation Bank is required to be protected and maintained in perpetuity by Wildlands according to the conditions of Water Quality Certification No. R9-2013-0050. The mitigation provided for Project impacts contributes to the net gain of wetlands per the State of California Net Gain Policy (Executive Order W-59-93).
- c. Linear-foot compensatory mitigation is not required for this Project. Compensatory mitigation provided at the San Luis Rey Mitigation Bank (approximately 55.8 acres) is considered to be a large, contiguous restoration area that restores wetland and non-wetland water functions, services, and values, as well as a suite of beneficial uses (WARM, WILD, and RARE). Additionally, mitigation credits are not reported in terms of linear feet of mitigation.

B. Mitigation Credit Purchase. Prior to the start of construction, the Applicant must provide documentation to the San Diego Water Board verifying the purchase of at least 0.06 acre of credit applicable to the re-establishment of waters of the U.S. and/or State from the San Luis Rey Mitigation Bank. The use of an alternate mitigation bank to provide required compensatory mitigation must be approved by the San Diego Water Board before the credits are secured and is subject to the following conditions:

- a. The Applicant must identify the USACE approved mitigation bank and submit documentation demonstrating that:
 - a. The permitted Project impacts are located within the service area of the mitigation bank; and
 - b. The mitigation bank has the appropriate number and resource type of credits available.
- b. If San Diego Water Board approval of the use of the alternate mitigation bank is obtained, the Applicant must provide documentation verifying that the appropriate number and resource type of credits have been secured from the mitigation bank prior to the start of construction.

V. MONITORING AND REPORTING REQUIREMENTS

- A. **Annual Project Progress Reports.** The Applicant must submit annual Project progress reports describing compliance with all requirements of this Certification to the San Diego Water Board prior to **March 1** of each year following the issuance of this Certification, until the Project has reached completion. The report must include the following information:
1. The names, qualifications, and affiliations of the persons contributing to the report;
 2. The status, progress, and anticipated schedule for completion of Project construction activities;
 3. A description of Project construction delays encountered or anticipated that may affect the schedule for construction completion; and
 4. A description of each incident of noncompliance during the annual monitoring period and its cause, the period of the noncompliance including exact dates and times, and if the noncompliance has not been corrected, the anticipated time it is expected to continue; and the steps taken or planned to reduce, eliminate, and prevent reoccurrence of the noncompliance.
- H. **Final Project Completion Report.** The Applicant must submit a Final Project Completion Report to the San Diego Water Board **within 30 days of completion of the Project**. The final report must include the following information:
1. Date of construction initiation;
 2. Date of construction completion;
 3. As-built drawings of the Project, no bigger than 11”X17”; and
 4. Photo documentation of implemented post-construction BMPs and all areas of permanent and temporary impacts, prior to and after project construction. Photo documentation must be conducted in accordance with guidelines posted at http://www.waterboards.ca.gov/sandiego/water_issues/programs/401_certification/docs/401c/401PhotoDocRB9V713.pdf. In addition, photo documentation must include Global Positioning System (GPS) coordinates for each of the photo points referenced.
- I. **Reporting Authority.** The submittal of information required under this Certification, or in response to a suspected violation of any condition of this Certification, is required pursuant to Water Code section 13267 and 13383. Civil liability may be administratively imposed by the San Diego Water Board for failure to submit information pursuant to Water Code sections 13268 or 13385.

- J. **Electronic Document Submittal.** The Applicant must submit all reports and information required under this Certification in electronic format via e-mail to SanDiego@waterboards.ca.gov. Documents over 50 megabytes will not be accepted via e-mail and must be placed on a disc and delivered to:

California Regional Water Quality Control Board
San Diego Region
Attn: 401 Certification No. R9-2018-0064:845905:lhonma
2375 Northside Drive, Suite 100
San Diego, California 92108

Each electronic document must be submitted as a single file, in Portable Document Format (PDF), converted to text searchable format using Optical Character Recognition (OCR), and not be password protected. All electronic documents must include scanned copies of all signature pages; electronic signatures will not be accepted. Electronic documents submitted to the San Diego Water Board must include the following identification numbers in the header or subject line: Certification No. R9-2018-0064: 845905:lhonma.

- K. **Document Signatory Requirements.** All applications, reports, or information submitted to the San Diego Water Board must be signed as follows:

1. For a corporation, by a responsible corporate officer of at least the level of vice president.
2. For a partnership or sole proprietorship, by a general partner or proprietor, respectively.
3. For a municipality, or a state, federal, or other public agency, by either a principal executive officer or ranking elected official.
4. A duly authorized representative may sign applications, reports, or information if:
 - a. The authorization is made in writing by a person described above.
 - b. The authorization specifies either an individual or position having responsibility for the overall operation of the regulated activity.
 - c. The written authorization is submitted to the San Diego Water Board Executive Officer.

If such authorization is no longer accurate because a different individual or position has responsibility for the overall operation of the Project, a new authorization satisfying the above requirements must be submitted to the San Diego Water Board prior to or together with any reports, information, or applications, to be signed by an authorized representative.

- L. **Document Certification Requirements.** All applications, reports, or information submitted to the San Diego Water Board must be certified as follows:

"I certify under penalty of law that I have personally examined and am familiar with the information submitted in this document and all attachments and that, based on my inquiry of those individuals immediately responsible for obtaining the information, I believe that the information is true, accurate, and complete. I am aware that there are significant penalties for submitting false information, including the possibility of fine and imprisonment."

VI. NOTIFICATION REQUIREMENTS

- A. **Twenty-Four Hour Non-Compliance Reporting.** The Applicant shall report any noncompliance which may endanger health or the environment. Any such information shall be provided orally to the San Diego Water Board within **24 hours** from the time the Applicant becomes aware of the circumstances. A written submission shall also be provided within five days of the time the Applicant becomes aware of the circumstances. The written submission shall contain a description of the noncompliance and its cause; the period of noncompliance, including exact dates and times, and if the noncompliance has not been corrected; the anticipated time it is expected to continue; and steps taken or planned to reduce, eliminate, and prevent recurrence of the noncompliance. The San Diego Water Board, or an authorized representative, may waive the written report on a case-by-case basis if the oral report has been received within 24 hours.
- B. **Anticipated Noncompliance.** The Applicant shall give advance notice to the San Diego Water Board of any planned changes in the Project or the Compensatory Mitigation project which may result in noncompliance with Certification conditions or requirements.
- C. **Transfers.** This Certification is not transferable in its entirety or in part to any person or organization except after notice to the San Diego Water Board in accordance with the following terms:
1. **Transfer of Property Ownership:** The Applicant must notify the San Diego Water Board of any change in ownership of the Project area. Notification of change in ownership must include, but not be limited to, a statement that the Applicant has provided the purchaser with a copy of the Section 401 Water Quality Certification and that the purchaser understands and accepts the certification requirements and the obligation to implement them or be subject to liability for failure to do so; the seller and purchaser must sign and date the notification and provide such notification to the San Diego Water Board **within 10 days of the transfer of ownership.**

2. **Transfer of Mitigation Responsibility:** Any notification of transfer of responsibilities to satisfy the mitigation requirements set forth in this Certification must include a signed statement from an authorized representative of the new party (transferee) demonstrating acceptance and understanding of the responsibility to comply with and fully satisfy the mitigation conditions and agreement that failure to comply with the mitigation conditions and associated requirements may subject the transferee to enforcement by the San Diego Water Board under Water Code section 13385, subdivision (a). Notification of transfer of responsibilities meeting the above conditions must be provided to the San Diego Water Board **within 10 days of the transfer date.**
3. **Transfer of Post-Construction BMP Maintenance Responsibility:** The Applicant assumes responsibility for the inspection and maintenance of all post-construction structural BMPs until such responsibility is legally transferred to another entity. At the time maintenance responsibility for post-construction BMPs is legally transferred the Applicant must submit to the San Diego Water Board a copy of such documentation and must provide the transferee with a copy of a long-term BMP maintenance plan that complies with manufacturer specifications. The Applicant must provide such notification to the San Diego Water Board within **10 days** of the transfer of BMP maintenance responsibility.

Upon properly noticed transfers of responsibility, the transferee assumes responsibility for compliance with this Certification and references in this Certification to the Applicant will be interpreted to refer to the transferee as appropriate. Transfer of responsibility does not necessarily relieve the Applicant of this Certification in the event that a transferee fails to comply.

- D. **Discharge Commencement.** The Applicant must notify the San Diego Water Board in writing **at least 5 days prior to** the start of Project construction.

VII. CALIFORNIA ENVIRONMENTAL QUALITY ACT COMPLIANCE

- A. The Lakeside Fire Protection District is the Lead Agency under the California Environmental Quality Act (CEQA) (Public Resources Code section 21000, et seq.) section 21067, and CEQA Guidelines (California Code of Regulations, title 14, section 15000 et seq.) section 15367, and has filed a Notice of Determination dated September 30, 2015 for the Final Mitigated Negative Declaration (FMND) titled *Final Initial Study & Mitigated Negative Declaration for the Lakeside Fire State #1 Project*. The Lead Agency has determined the Project will not have a significant effect on the environment and mitigation measures were made a condition of the Project.
- B. The San Diego Water Board is a Responsible Agency under CEQA (Public Resources Code section 21069; CEQA Guidelines section 15381). The San Diego Water Board has considered the Lead Agency's FMND and finds that the Project as proposed will have a significant effect on resources within the San Diego Water Board's purview.
- C. The San Diego Water Board has required mitigation measures as a condition of this Certification to avoid or reduce the environmental effects of the Project to resources within the Board's purview to a less than significant level.

- D. The Lead Agency has adopted a mitigation monitoring and reporting program pursuant to Public Resources Code section 21081.6 and CEQA Guidelines section 15097 to ensure that mitigation measures and revisions to the Project identified in the FEIR are implemented. The Mitigation Monitoring and Reporting Program (MMRP) is included and incorporated by reference in Attachment 3 to this Certification. The Applicant shall implement the Lead Agency's MMRP described in the FEIR, as it pertains to resources within the San Diego Water Board's purview. The San Diego Water Board has imposed additional MMRP requirements as specified in sections IV and V of this Certification.
- E. As a Responsible Agency under CEQA, the San Diego Water Board will file a Notice of Determination in accordance with CEQA Guidelines section 15096 subdivision(i).

VIII. SAN DIEGO WATER BOARD CONTACT PERSON

Lisa Honma, Environmental Scientist
California Regional Water Quality Control Board, San Diego Region
2375 Northside Drive, Suite 100
San Diego, California 92108
Telephone: 619-521-3367
Email: Lisa.Honma@waterboards.ca.gov

IX. WATER QUALITY CERTIFICATION

I hereby certify that the proposed discharge from the **Lakeside Fire Station No. 1 Project** (Certification No. R9-2018-0064) will comply with the applicable provisions of sections 301 ("Effluent Limitations"), 302 ("Water Quality Related Effluent Limitations"), 303 ("Water Quality Standards and Implementation Plans"), 306 ("National Standards of Performance"), and 307 ("Toxic and Pretreatment Effluent Standards") of the Clean Water Act. This discharge is also regulated under State Water Board Order No. 2003-0017-DWQ, "*Statewide General Waste Discharge Requirements for Dredged or Fill Discharges that have Received State Water Quality Certification (General WDRs)*," which requires compliance with all conditions of this Water Quality Certification. Please note that enrollment under Order No. 2003-017-DWQ is conditional and, should new information come to our attention that indicates a water quality problem, the San Diego Water Board may issue individual waste discharge requirements at that time.

Except insofar as may be modified by any preceding conditions, all Certification actions are contingent on (a) the discharge being limited to, and all proposed mitigation being completed in strict compliance with, the applicants' Project description and/or the description in this Certification, and (b) compliance with all applicable requirements of the Basin Plan.

I, David W. Gibson, Executive Officer, do hereby certify the forgoing is a full, true, and correct copy of Certification No. R9-2018-0064 issued on August 2, 2018.



DAVID W. GIBSON
Executive Officer
San Diego Water Board

2 August 2018
Date

ATTACHMENT 1 DEFINITIONS

Activity - when used in reference to a permit means any action, undertaking, or project including, but not limited to, construction, operation, maintenance, repair, modification, and restoration which may result in any discharge to waters of the state.

Buffer - means an upland, wetland, and/or riparian area that protects and/or enhances aquatic resource functions associated with wetlands, rivers, streams, lakes, marine, and estuarine systems from disturbances associated with adjacent land uses.

California Rapid Assessment Method (CRAM) - is a wetland assessment method intended to provide a rapid, scientifically-defensible and repeatable assessment methodology to monitor status and trends in the conditions of wetlands for applications throughout the state. It can also be used to assess the performance of compensatory mitigation projects and restoration projects. CRAM provides an assessment of overall ecological condition in terms of four attributes: landscape context and buffer, hydrology, physical structure and biotic structure. CRAM also includes an assessment of key stressors that may be affecting wetland condition and a "field to PC" data management tool (eCRAM) to ensure consistency and quality of data produced with the method.

Compensatory Mitigation Project - means compensatory mitigation implemented by the Applicant as a requirement of this Certification (i.e., applicant -responsible mitigation), or by a mitigation bank or an in-lieu fee program.

Discharge of dredged material – means any addition of dredged material into, including redeposit of dredged material other than incidental fallback within, the waters of the United States and/or State.

Discharge of fill material – means the addition of fill material into waters of the United States and/or State.

Dredged material – means material that is excavated or dredged from waters of the United States and/or State.

Ecological Success Performance Standards – means observable or measurable physical (including hydrological), chemical, and/or biological attributes that are used to determine if a compensatory mitigation project meets its objectives.

Enhancement – means the manipulation of the physical, chemical, or biological characteristics of an aquatic resource to improve a specific aquatic resource function(s). Enhancement results in the gain of selected aquatic resource function(s), but may also lead to a decline in other aquatic resource function(s). Enhancement does not result in a gain in aquatic resource area.

Establishment – means the manipulation of the physical, chemical, or biological characteristics present to develop an aquatic resource that did not previously exist. Creation results in a gain in aquatic resource area.

Fill material – means any material used for the primary purpose of replacing an aquatic area with dry land or of changing the bottom elevation of a water body.

Isolated wetland – means a wetland with no surface water connection to other aquatic resources.

Mitigation Bank – means a site, or suite of sites, where resources (e.g., wetlands, streams, riparian areas) are restored, established, enhanced, and/or preserved for the purpose of providing mitigation for impacts authorized by this Certification.

Preservation - means the removal of a threat to, or preventing the decline of, aquatic resources by an action in or near those aquatic resources. This term includes activities commonly associated with the protection and maintenance of aquatic resources through the implementation of appropriate legal and physical mechanisms. Preservation does not result in a gain of aquatic resource area or functions.

Re-establishment - means the manipulation of the physical, chemical, or biological characteristics of a site with the goal of returning natural/ historic functions to a former aquatic resource. Re-establishment results in rebuilding a former aquatic resource and results in a gain in aquatic resource area and functions.

Rehabilitation - means the manipulation of the physical, chemical, or biological characteristics of a site with the goal of repairing natural/ historic functions to a degraded aquatic resource. Rehabilitation results in a gain in aquatic resource function, but does not result in a gain in aquatic resource area.

Restoration - means the manipulation of the physical, chemical, or biological characteristics of a site with the goal of returning natural/historic functions to a former or degraded aquatic resource. For the purpose of tracking net gains in aquatic resource area, restoration is divided into two categories: re-establishment and rehabilitation.

Start of Project Construction - For the purpose of this Certification, "start of Project construction" means to engage in a program of on-site construction, including site clearing, grading, dredging, landfilling, changing equipment, substituting equipment, or even moving the location of equipment specifically designed for a stationary source in preparation for the fabrication, erection or installation of the building components of the stationary source within waters of the United States and/or State.

Uplands - means non-wetland areas that lack any field-based indicators of wetlands or other aquatic conditions. Uplands are generally well-drained and occur above (i.e., up-slope) from nearby aquatic areas. Wetlands can, however, be entirely surrounded by uplands. For example, some natural seeps and constructed stock ponds lack aboveground hydrological connection to other aquatic areas. In the watershed context, uplands comprise the landscape matrix in which aquatic areas form. They are the primary sources of sediment, surface runoff, and associated chemicals that are deposited in aquatic areas or transported through them.

Water quality objectives and other appropriate requirements of state law – means the water quality objectives and beneficial uses as specified in the appropriate water quality control plan(s); the applicable provisions of sections 301, 302, 303, 306, and 307 of the Clean Water Act; and any other appropriate requirement of state law.

Waters of the State - means any surface water or groundwater, including saline waters, within the boundaries of the State. [Water Code section 13050, subd. (e)].

Lakeside Fire Protection District
Lakeside Fire Station No. 1 Project
Certification No. R9-2018-0064

**ATTACHMENT 2
PROJECT FIGURES AND PLANS**

Figure 1 – Regional Location
Figure 2 – Project Location on USGS Map
Figure 3 – Project Location on Aerial Photograph
Figure 4 – Jurisdictional Delineation and Proposed Impacts
Existing Hydrology Plan, Sheet 2
Grading Plan B, Sheet 8



***** Project Location

FIGURE 1
Regional Location

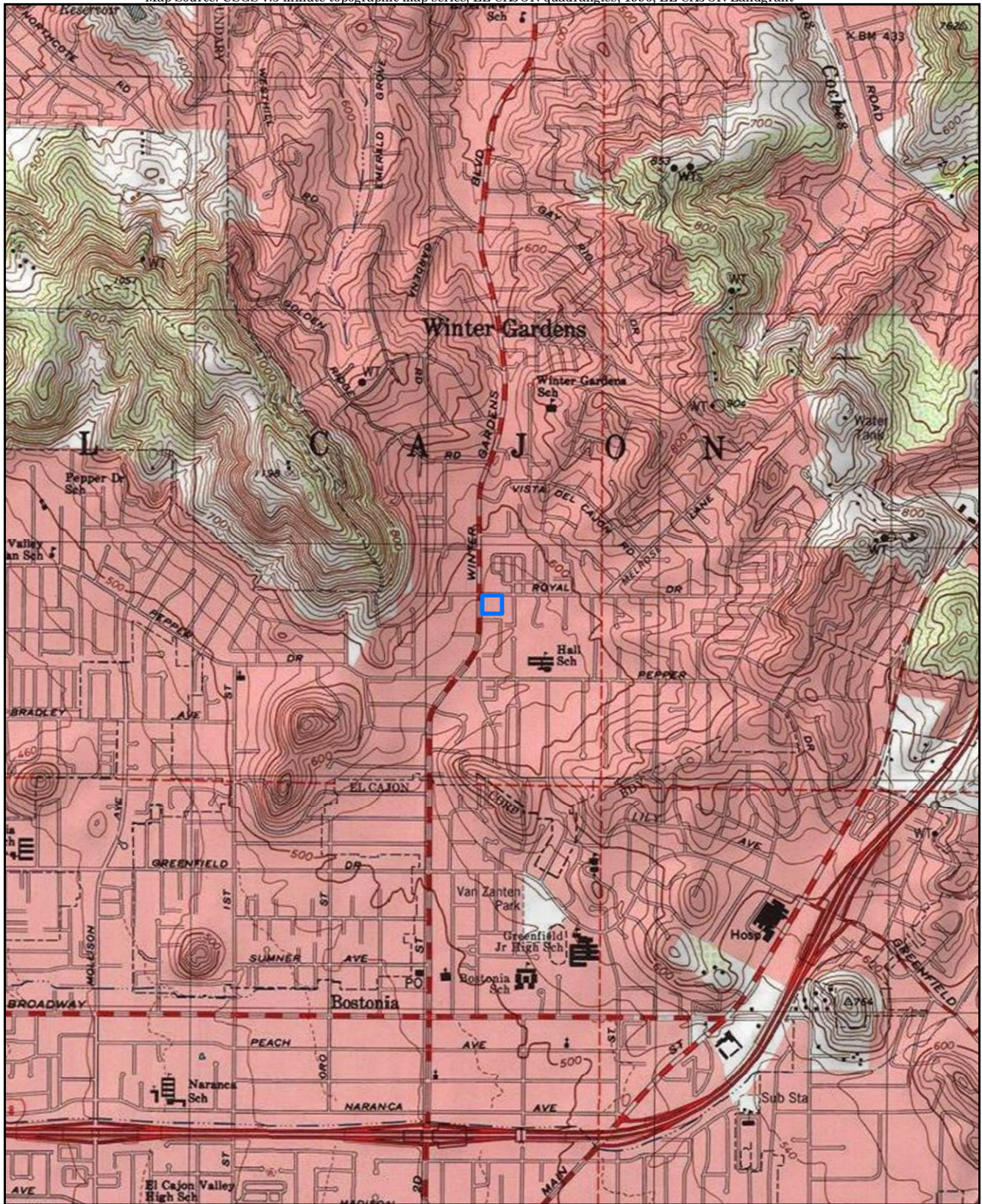

 Project Boundary

FIGURE 2

Project Location on USGS Map

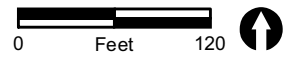

 Project Boundary

FIGURE 3

Project Location on Aerial Photograph



 Project Boundary

 Project Impacts

 ACOE Non-wetland Waters, CDFW Streambed and RWQCB Waters of the State

 Sample Point



FIGURE 4

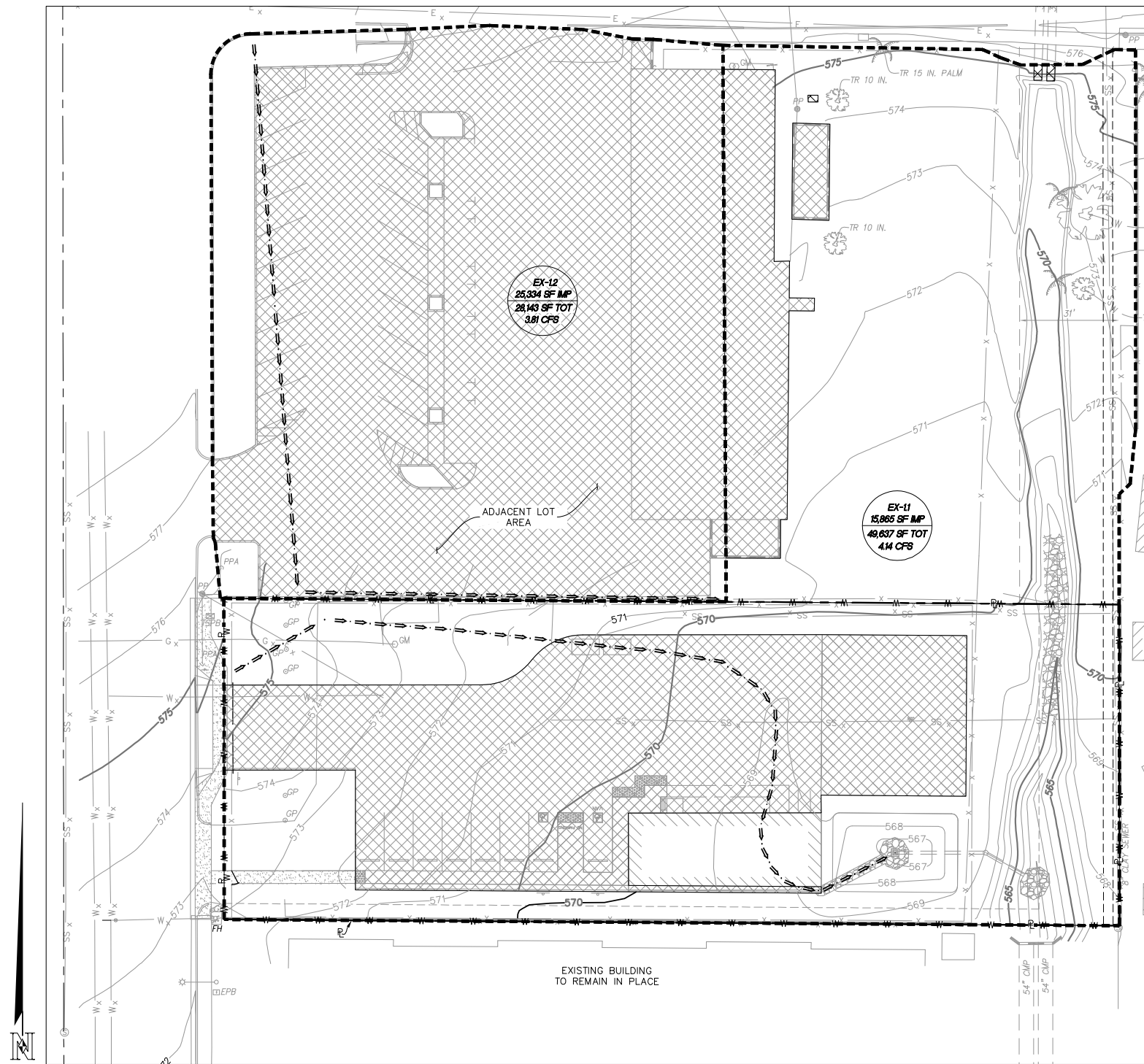

EXISTING HYDROLOGY

1" = 20'

LEGEND:

- BASIN NAME WITH IMPERVIOUS AREA/TOTAL AREA
- BOUNDARY OF BASIN
- FLOWLINE FOR THE TIME OF CONCENTRATION
- EXISTING IMPERVIOUS SURFACE

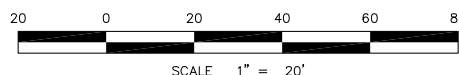
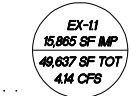

Nasland Civil Engineering
 Surveying
 Land Planning
 (858) 292-7770
 4740 Ruffer Street
 San Diego, CA 92111
 nasland.com

COUNTY APPROVED CHANGES

NO.	DESCRIPTION:	APPROVED BY:	DATE:

BENCH MARK
 DESCRIPTION: S.D. CO. 1967. C/L MON ON WINTERGARDENS BLVD. C/L MON BRASS DISC SET IN CONC. BELOW SURFACE.
 LOCATION: APPROX 187 FT NLY OF INT WITH PEPPER DRIVE.
 RECORD FROM: SAN DIEGO COUNTY VERTICAL CONTROL
 ELEVATION: 563.639' DATUM: M.S.L.

PRIVATE CONTRACT

SHEET 2	COUNTY OF SAN DIEGO DEPARTMENT OF PUBLIC WORKS	22 SHEETS
---------	--	-----------

EXISTING HYDROLOGY PLAN FOR:
LAKESIDE FIRE STATION
 CALIFORNIA COORDINATE INDEX 238-1785

APPROVED FOR SIRIUS DEVLAMAN COUNTY ENGINEER	ENGINEER OF WORK GREGORY M. KLUMP R.C.E. SEATE
BY: _____	DATE: _____
PDS-2015-LDGRMN-20068 GRADING PERMIT NO.	

NASLAND ENGINEERING 858-292-7770

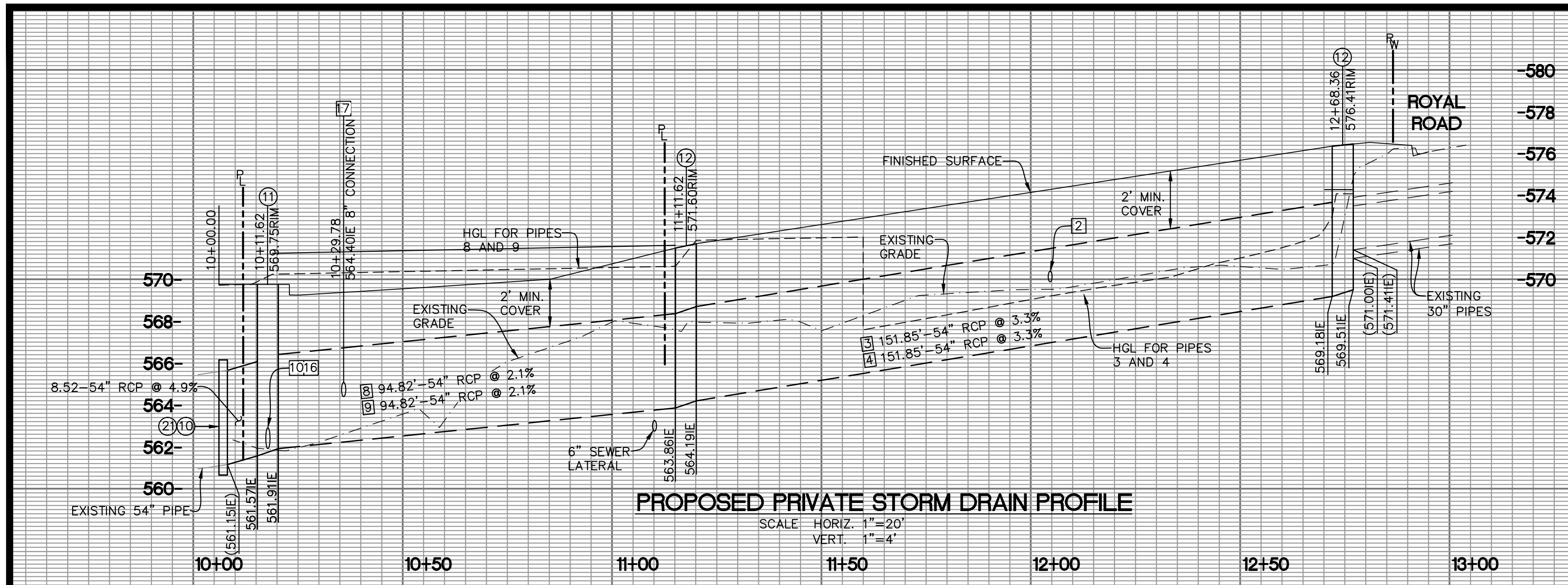

STORM DRAIN DATA

NO.	BEARING/Delta	LENGTH	SLOPE	NOTE
1	N00°01'49\"E	68.19'	1.0% MIN	6\" PVC PERFORATED PIPE (PRIVATE)
2	N89°21'36\"W	12.58'	9.5%	12\" PVC (SDR-35) PIPE (PRIVATE)
3	N00°20'00\"E	151.85'	3.3%	54\" RCP D-1350 PIPE (PRIVATE)
4	N00°20'00\"W	151.85'	3.3%	54\" RCP D-1350 PIPE (PRIVATE)
5	N00°01'49\"E	42.89'	1.0% MIN	6\" PVC PERFORATED PIPE (PRIVATE)
6	N00°01'49\"E	109.05'	1.0% MIN	6\" PVC PERFORATED PIPE (PRIVATE)
7	N01°57'44\"W	7.57'	1.0% MIN	24\" RCP D-1350 PIPE (PRIVATE)
8	N00°13'00\"E	94.81'	2.1%	54\" RCP D-1350 PIPE (PRIVATE)
9	N00°23'53\"W	94.82'	2.1%	54\" RCP D-1350 PIPE (PRIVATE)
10	N62°23'34\"E	7.25'	5.0%	24\" RCP D-1350 PIPE (PRIVATE)
11	N12°36'57\"E	8.52'	4.9%	54\" RCP D-1350 PIPE (PRIVATE)
12	N04°21'58\"E	8.03'	5.2%	54\" RCP D-1350 PIPE (PRIVATE)
13	N90°00'00\"E	10.82'	1.0% MIN	24\" RCP D-1350 PIPE (PRIVATE)
14				NOT USED
15	N89°35'53\"W	206.12'	1.3%	6\" PVC PERFORATED PIPE (PRIVATE)
16	N89°35'53\"W	2.53'	53.1%	24\" RCP D-1350 PIPE (PRIVATE)
17	N89°21'36\"W	63.00'	2.0%	8\" PVC (SDR-35) PIPE (PRIVATE)
18	N89°21'36\"W	49.86'	1.0% MIN	6\" PVC PERFORATED PIPE (PRIVATE)

CURB DATA

NO.	DELTA	LENGTH	RADIUS	NOTE
C1	90°25'21\"	14.20'	9.0'	0\" CURB
C2	89°34'39\"	4.69'	3.0'	0\" CURB
C3	90°25'21\"	6.31'	4.0'	0\" CURB
C4	90°00'00\"	7.85'	5.0'	0\" CURB

NO.	BEARING	LENGTH	NOTE
L1	N00°01'14\"W	196.36'	0\" CURB
L2	N00°01'14\"W	257.91'	0\" CURB
L3	N89°35'53\"W	0.58'	0\" CURB
L4	N89°35'53\"W	6.81'	0\" CURB
L5	N89°35'53\"W	45.82'	0\" CURB
L6	N89°35'53\"W	75.81'	6\" CURB AND GUTTER

EXISTING UTILITY LOCATION
CONTRACTOR SHALL PROVIDE UTILITY MARK-OUT PRIOR TO THE START OF CONSTRUCTION. EXISTING UTILITIES SHOULD BE LOCATED NEAR LOCATIONS INDICATED ON SHEET 6.

STORM DRAIN INSPECTION:
CONTRACTOR TO PROVIDE TELEVISION INSPECTION OF STORM DRAIN SYSTEMS FOR STORM DRAIN PIPES LESS THAN 48\" IN DIAMETER. CONTRACTOR TO PROVIDE A CD OR FLASH DRIVE WITH THE VIDEOS TO THE ENGINEER OF RECORD SHOWING SUFFICIENT COMPLETION OF WORK.

INFILTRATION SWALE MAINTENANCE:
MAINTENANCE OF BIO-RETENTION BASIN, INFILTRATION SWALES INCLUDING STORM DRAIN FACILITIES AND LANDSCAPING SHALL BE THE RESPONSIBILITY OF THE OWNER OR COUNTY DGS.

STORM DRAIN MAINTENANCE:
COUNTY FIELD OPERATIONS ARE RESPONSIBLE FOR MAINTENANCE WITHIN PUBLIC RIGHT-OF-WAY ONLY. STORM DRAIN PIPES SHOWN ON THE PRIVATE PROPERTIES SHOULD BE THE RESPONSIBILITY OF THE DEVELOPER AND/OR LANDOWNER.

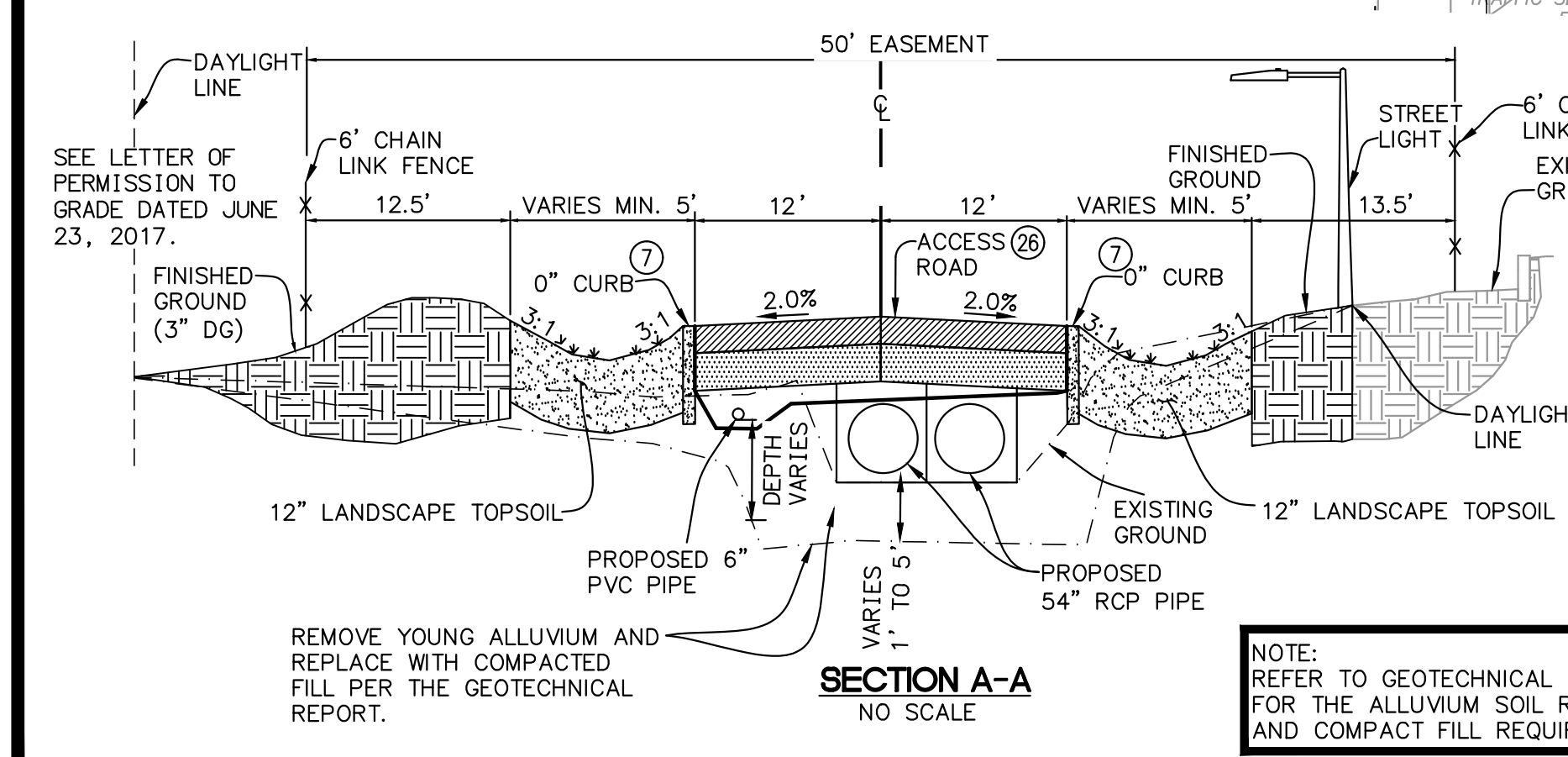

NOTE: REFER TO GEOTECHNICAL REPORT FOR THE ALLUVIUM SOIL REMOVAL AND COMPACT FILL REQUIREMENTS

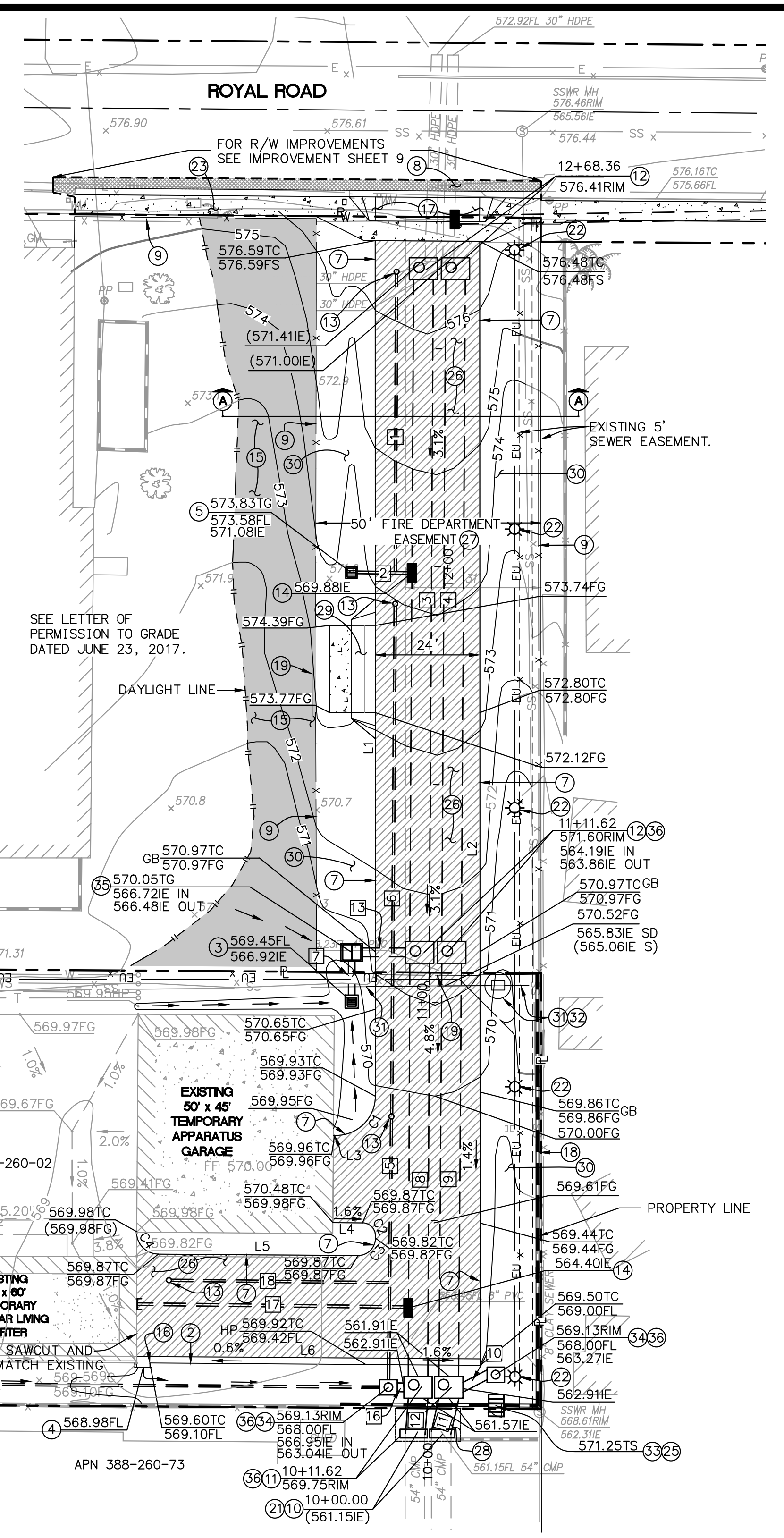
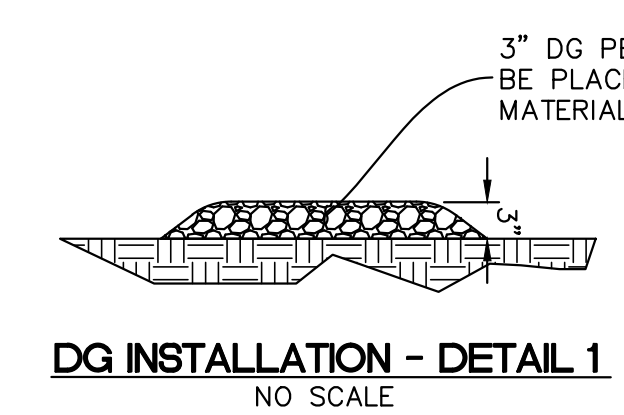

- CONSTRUCTION NOTES:**
- CONSTRUCT 6\" CURB PER RSD G-1.
 - CONSTRUCT CURB AND GUTTER PER RSD G-2.
 - INSTALL 24\"x24\" CATCH BASIN PER DETAIL ON SHEET 7. WITH STENCILING PER CASQA BMP SD-13.
 - CONSTRUCT CONCRETE FLUME PER DETAIL SHEET 7.
 - INSTALL 18\"x18\" CATCH BASIN PER DETAIL ON SHEET 7. WITH STENCILING PER CASQA BMP SD-13.
 - CONSTRUCT BIOFILTRATION WITH PARTIAL RETENTION PER DETAIL ON SHEET 7.
 - INSTALL 0\" CURB PER RSD G-1.
 - CONSTRUCT AC PAVING PER DETAIL ON SHEET 7.
 - INSTALL 6\" CHAIN LINK PEDESTRIAN FENCE.
 - INSTALL (2) PIPE COLLARS PER RSD D-62.
 - CONSTRUCT MODIFIED TYPE B MANHOLE (6.5\"x5\") PER RSD D-10 AND SOUTHERN CONNECTION DETAIL THIS SHEET.
 - CONSTRUCT (5\"x5\") TYPE B CLEANOUT PER RSD D-10
 - INSTALL STORM DRAIN CLEANOUT PER DETAIL SHEET 2.
 - CONSTRUCT CONCRETE LUG PER RSD D-63.
 - INSTALL 3\" DG PER DETAIL 1 BELOW.
 - CONNECT FLUME TO EXISTING CURB AND GUTTER. MATCH EXISTING FLOW LINE.
 - CONSTRUCT CONCRETE DRIVEWAY PER IMPROVEMENT PLAN SHEET 9.
 - CONSTRUCT 6\" FREE STANDING CMU WALL TO BE INSTALLED UNDER SEPARATE BUILDING AND ADMINISTRATION PERMIT.
 - INSTALL 24\" ROLLING GATE.
 - CONNECT NEW STREET LIGHTING CONDUIT TO EXISTING ELECTRICAL PANEL.
 - REMOVE EXISTING HEAD WALL.
 - INSTALL PRIVATE STREET LIGHT PER RSD E-01. ELECTRICAL SHALL BE SINGLE PHASE 120/240V
 - CONSTRUCT CURB, GUTTER, AND SIDEWALK PER IMPROVEMENT PLAN SHEET 9.
 - INSTALL TYPE I CATCH BASIN PER RSD D-29. WITH STENCILING PER CASQA BMP SD-13.
 - INSTALL 3\" WIDE CHAINLINK GATE PER RSD M-20.
 - CONSTRUCT PERMIABLE CONCRETE PAVERS PER DETAIL ON SHEET 7.
 - EASEMENT AGREEMENT BETWEEN FARIDA FAMILY TRUST AND THE LAKESIDE FIRE PROTECTION DISTRICT FOR A NON-EXCLUSIVE ACCESS DOCUMENT # 2017-0320684 FILED ON 07-17-2017
 - EASEMENT AGREEMENT BETWEEN THE MELLUCCI IRREVOCABLE TRUST DATED 10-31-1991, THE MELLUCCI FAMILY SURVIVOR/S TRUST DATED 6-25-1999, THE MELLUCCI FAMILY BYPASS TRUST DATED 11-14-2000, AND THE LAKESIDE FIRE PROTECTION DISTRICT FOR NON-EXCLUSIVE ACCESS DOCUMENT # 2017-0320683 FILED ON 07-17-2017
 - CONSTRUCT CONCRETE DRIVEWAY (W=20') PER RSD G-26.
 - LANDSCAPE AREA.
 - INSTALL SEWER LATERAL AND LIFT STATION PER DETAIL SHEET 11.
 - CONNECT NEW SEWER PUMP TO THE EXISTING ELECTRICAL PANEL.
 - CONSTRUCT CONCRETE STAIRS PER RSD M-26
 - CONSTRUCT TYPE F CATCH BASIN PER RSD D-07. PROVIDE OPENINGS ON 2 SIDES
 - CONSTRUCT TYPE G-2 CATCH BASIN PER RSD D-08
 - INSTALL LOCKING MANHOLE COVER PER RSD M-4

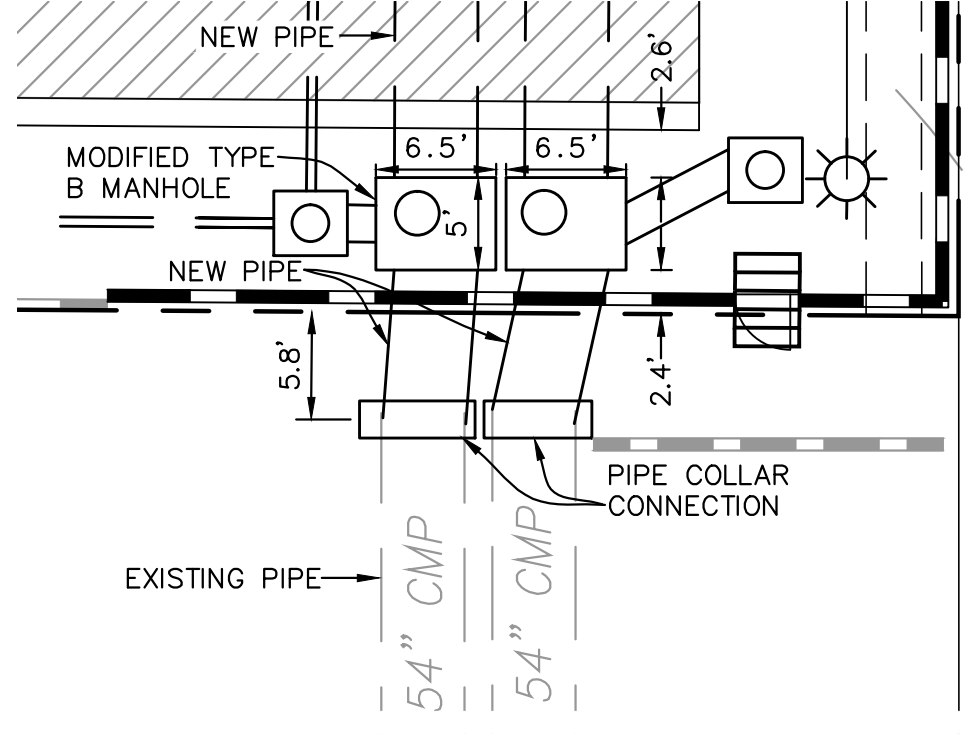

RECORD PLAN

BY: _____ NAME _____ DATE: _____
 R.C.E. _____
 EXPIRES: _____

COUNTY APPROVED CHANGES

NO.	DESCRIPTION:	APPROVED BY:	DATE:
Δ	NEW SHEET.		

BENCH MARK

DESCRIPTION: S.D. CO. 1967. C/L MON ON WINTERGARDENS BLVD. C/L MON BRASS DISC SET IN CONC. BELOW SURFACE.
 LOCATION: APPROX 187 FT NLY OF INT WITH PEPPER DRIVE.
 RECORD FROM: SAN DIEGO COUNTY VERTICAL CONTROL
 ELEVATION: 563.639' DATUM: M.S.L.

PRIVATE CONTRACT

SHEET 8 COUNTY OF SAN DIEGO DEPARTMENT OF PUBLIC WORKS 11 SHEETS

GRADING PLAN B FOR:
LAKESIDE FIRE STATION

CALIFORNIA COORDINATE INDEX 238-1785

APPROVED FOR WILLIAM P. MORGAN COUNTY ENGINEER
 ENGINEER OF WORK: GREGORY M. KUMPF R.C.E. 64416
 PDS-2015-LDRGMN-20068 GRADING PERMIT NO.



NASLAND ENGINEERING 858-292-7770

Lakeside Fire Protection District
Lakeside Fire Station No. 1 Project
Certification No. R9-2018-0064

ATTACHMENT 3
CEQA MITIGATION MONITORING AND REPORTING PROGRAM

Final Initial Study & Mitigated Negative Declaration for the Lakeside Fire State #1 Project, dated September 2015, Chapter 5 – Mitigation Monitoring and Reporting Program, pp. 5-1 through 5-3

CHAPTER 5 – MITIGATION MONITORING AND REPORTING PROGRAM

The California Environmental Quality Act (CEQA) requires that a Lead Agency establish a program to report on and monitor measures adopted as part of the environmental review process to mitigate or avoid significant effects on the environment. This Mitigation Monitoring and Reporting Program (MMRP) is designed to ensure that the mitigation measures identified in the *Lakeside Fire Station #1 Project Initial Study / Mitigated Negative Declaration (IS/MND)* are properly implemented and documented. The MMRP conforms to the requirements of Public Resources Code Section 21081.6 and State CEQA Guidelines Section 15097. As outlined in the following table, the MMRP describes monitoring actions, schedules, and responsibilities for all mitigation measures identified in the MND. The MMRP table is organized by topic in the same order as the contents of the MND. The components of the MMRP are explained briefly below.

Impact Area. Environmental resource topic potentially affected by project implementation.

Mitigation Measure. The MMRP summarizes the mitigation measures for the potential environmental impacts identified in the IS/MND. The measures are given the same numbers as in the IS/MND.

Implementation. The MMRP identifies the primary party or parties responsible for undertaking each measure. In most cases, the primary responsibility for implementing the mitigation measures has been assigned to the Lakeside Fire Protection District (also the Lead Agency and Project Applicant) and may be undertaken by contractual assignment to the District's Construction Contractor.

Monitoring Responsibility. Identification of primary party or parties responsible for monitoring the compliance of, and adherence to, the mitigation measures contained in the IS/MND.

Timing of Compliance. The MMRP identifies the specific timeframe when the measure must take place, initiated, and often the duration of the measure.

Date of Completion. Upon completion of the mitigation measure, the date and signatures of the monitoring persons will be noted within the MMRP.

Resource Area	Mitigation Measure	Implementation	Monitoring Responsibility	Timing of Compliance	Date of Completion
<p>CULTURAL RESOURCES Potential to affect unknown cultural resources, and potentially cause a substantial adverse change in the significance of an archaeological resource pursuant to §15064.5; directly or indirectly destroy a unique paleontological resource or site or unique geological feature; and/or potential to disturb unknown human remains.</p>	<p>CR-1 If artifacts, bones or skeletal remains are encountered during grading, grading activities shall be immediately ceased, and a County-approved Qualified Archaeologist called in to evaluate the materials to allow a determination of potential significance, and subsequent actions required.</p>	Contractor	Lakeside Fire Protection District	During site grading activities	
	<p>CR-2 As specified by California Health and Safety Code Section 7050.5, if human remains are found on the project site during construction or during archaeological work, the person responsible for the excavation, or his or her authorized representative, shall immediately notify the San Diego County Coroner’s office by telephone. No further excavation or disturbance of the discovery or any nearby area reasonably suspected to overlie adjacent remains (as determined by the Qualified Archaeologist) shall occur until the Coroner has made the necessary findings as to origin and disposition pursuant to Public Resources Code 5097.98. If such a discovery occurs, a temporary construction exclusion zone shall be established surrounding the area of the discovery so that the area would be protected (as determined by the Qualified Archaeologist), and consultation and treatment could occur as prescribed by law. As further defined by State law, the Coroner would determine within two working days of being notified if the remains are subject to his or her authority. If the Coroner recognizes the remains to be Native American, he or she shall contact the Native American Heritage Commission (NAHC) within 24 hours. The NAHC would make a determination as to the Most Likely Descendent. If Native American remains are discovered, the remains shall be kept in situ (“in place”), or in a secure location in close proximity to where they were found, and the analysis of the remains shall only occur on-site in the presence of a County-approved Native American monitor.</p>	Contractor	Lakeside Fire Protection District	During site grading activities	

Resource Area	Mitigation Measure	Implementation	Monitoring Responsibility	Timing of Compliance	Date of Completion
<p>NOISE Potential of an exposure of persons to, or generation of, noise levels in excess of standards established in the local general plan or noise ordinance, or applicable standards of other agencies. -and- Potential substantial temporary or periodic increase in ambient noise levels in the project vicinity above existing levels.</p>	<p>N-1 To ensure temporary construction noise levels comply with the San Diego County Noise Ordinance, the applicant shall employ the following measures:</p> <ul style="list-style-type: none"> • Notify all adjacent residents of the construction schedule in writing. • Designate a “construction noise coordinator” who would be responsible for responding to any local complaints about construction noise. The construction noise coordinator shall determine the cause of the complaint and shall require that reasonable measures warranted to correct the problem be implemented. The telephone number for the construction noise coordinator shall be conspicuously posted at the construction site and included in the notice sent in the neighbors regarding the construction schedule. • Provide sound-control devices on equipment no less effective than those provided by the manufacturer. • Locate stationary equipment, material stockpiles, and vehicle staging areas as far as practicable from sensitive receptors. • Prohibit unnecessary idling of internal combustion engines. • Construct the southern 8-foot masonry wall at the onset of Phase 1 construction so that it serves as a noise barrier between the remaining construction activities and noise-sensitive land use to the south. • If feasible, when constructing the permanent fire station, construct the southern wall of the permanent fire station first so that it serves as a noise barrier between the remaining building construction and adjacent noise-sensitive land use. • Use temporary sound barriers or sound curtains around loud stationary equipment when the construction activity would generate noise in excess of 75 dBA Leq over any one-hour period at impacted residences if the other noise reduction methods are not effective or possible as a means to resolve a noise complaint. 	<p>Contractor</p>	<p>Lakeside Fire Protection District</p>	<p>Construction</p>	