

CITY OF POWAY

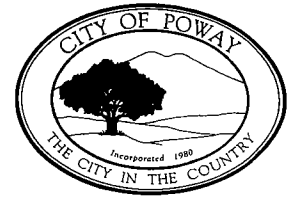

MICKEY CAFAGNA, Mayor
DON HIGGINSON, Deputy Mayor
MERRILEE BOYACK, Councilmember
JIM CUNNINGHAM, Councilmember
BETTY REXFORD, Councilmember

April 21, 2009

John H. Robertus, Executive Officer
CA Regional Water Quality Control Board
9174 Sky Park Court, Suite 100
San Diego, CA 92123-4353

Attn: Michael Porter

Dear Mr. Robertus:

SUBJECT: City of Poway Concrete Flood Control Channel Maintenance and Cleaning (File No. 07C-068); 401 Certification; WPC: 18-2007068.02:woodd

The City of Poway is currently authorized under the 401 Certification to clean in accordance with the permit specifications, forty-five (45) channels within the limits of the City of Poway. The City of Poway is requesting the addition of two (2) sections of channels to the existing 401 Certification:

1. Bounty Way Channel, 1,728 feet long by 4 feet long (Attachment 2)
2. Poway Royal Channel, 924 feet long by 4 feet long (Attachment 3)

A City Map (Attachment 1), Concrete Channel List (Attachment 4) and a copy of the existing permit (Attachment 5) are included identifying locations and size.

All work will be performed in accordance with the current Clean Water Act Section 401 Water Quality Certification for the Concrete Flood Control Channel Maintenance and Cleaning Project (File No. 07C-068)

If you have any questions or concerns regarding this request, please contact Patrick Ryan at (858) 668-4717 or PRyan@ci.poway.ca.us.

Sincerely,

Patrick Ryan
Operations Manager

- Attachments: 1) City Map
2) Bounty Way Channel Map/Photo
3) Poway Royal Channel Map/Photo
4) Concrete Channel List with Bounty and Poway Royal Addition
5) 401 Water Quality Certification for the Concrete Flood Control Channel Maintenance and Cleaning Project (File No. 07C-068)

City Hall Located at 13325 Civic Center Drive
Mailing Address: P.O. Box 789, Poway, California 92074-0789 • (858) 668-4400

Bounty/Poway Royal Map

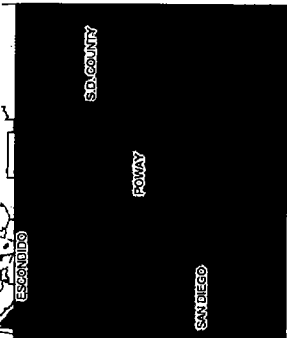
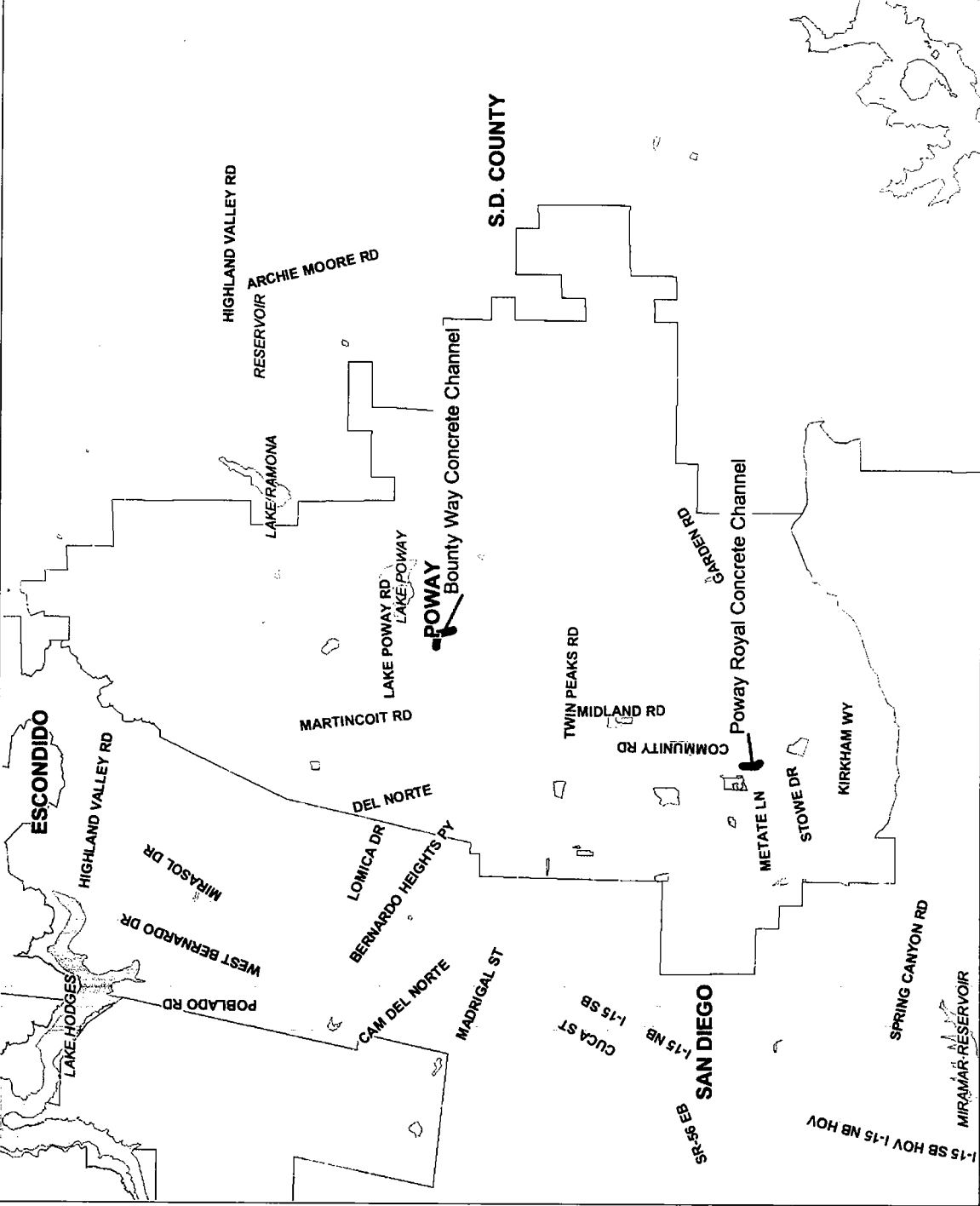

Legend

- City Parks
- Lakes



Scale: 1:105,888

This map is a user generated static output from an Internet mapping site and is for general reference only. Data layers that appear on this map may or may not be accurate, current, or otherwise reliable. THIS MAP IS NOT TO BE USED FOR NAVIGATION.



Bounty Chan 01

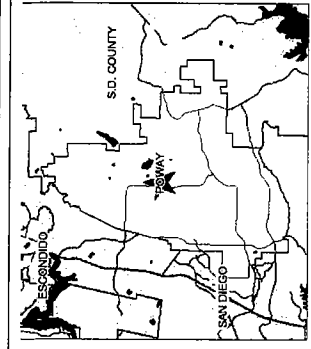
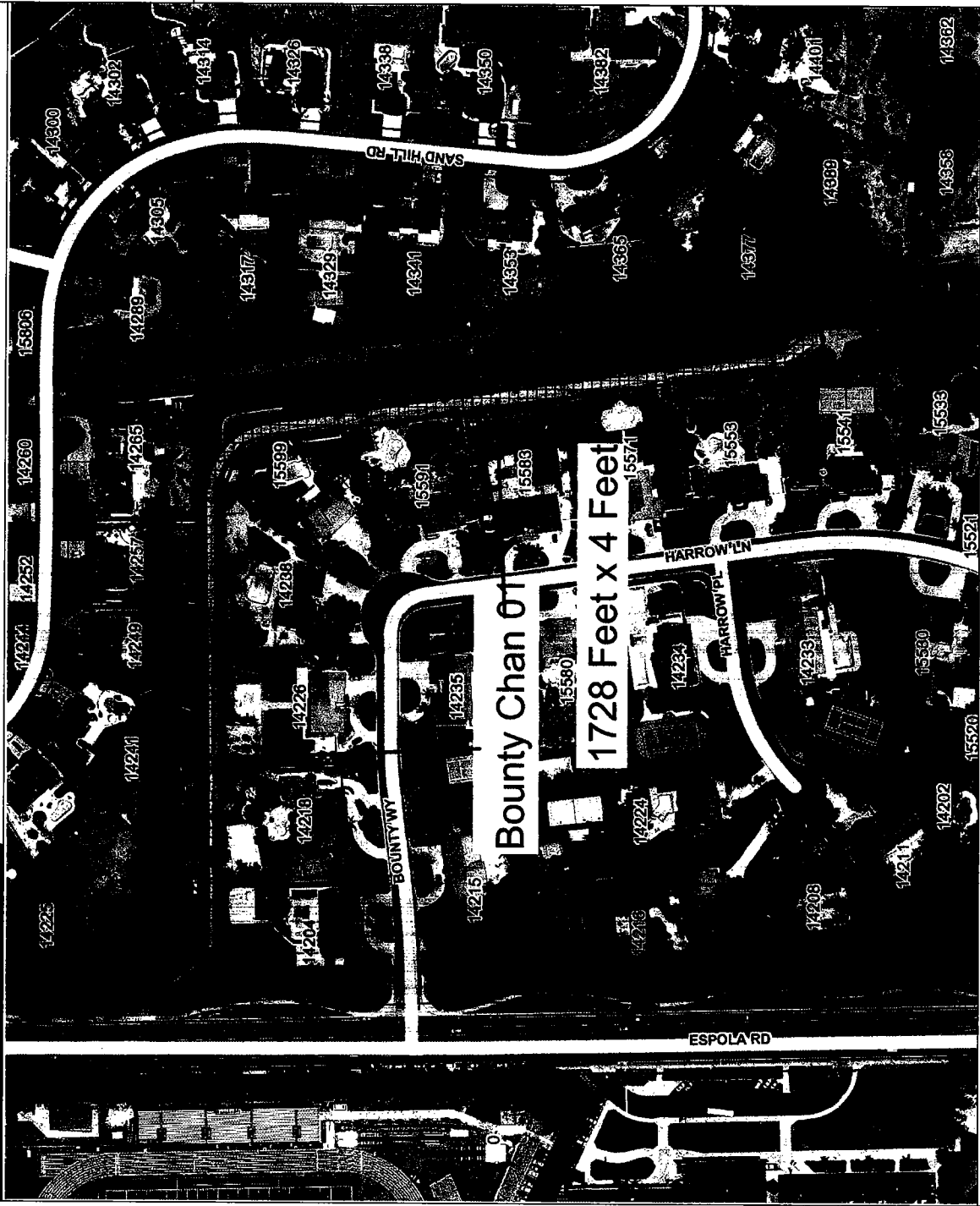

Legend

- Buildings
- City Parks
- Lakes
- Imagery (March 2005)

Scale: 1:2,687

This map is a user generated static output from an Internet mapping site and is for general reference only. Data layers that appear on this map may or may not be accurate, current, or otherwise reliable. THIS MAP IS NOT TO BE USED FOR NAVIGATION.





Pow Royal Chan 01

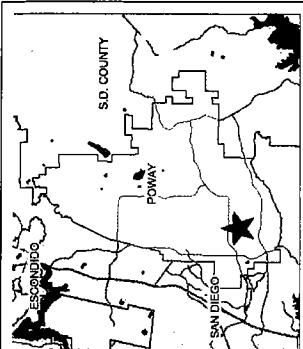

Legend

- Buildings
- City Parks
- Lakes
- Imagery (March 2005)

Scale: 1:2,253

This map is a user generated static output from an Internet mapping site and is for general reference only. Data layers that appear on this map may or may not be accurate, current, or otherwise reliable. THIS MAP IS NOT TO BE USED FOR NAVIGATION.



Concrete Channels '09

ID	Location / Description	Thos Coord	Anul	Inspect	Wet/Dry	Length	Width	Waddle Lf	Oil Boom Lf	Stream Length Impact Lf
PomChan 1	Monte Vista west to Pomerado Rd (Pharmacy)	1170 C6	Yes	5/1/2007	Dry	918'	3'	3	4	1
PomChan 2	Pharmacy south to Via Monte Claro	1170 C6	Yes	5/1/2007	Wet	345'	7' 8"	18	4	2
PomChan 3	Via Monte Claro south to Casa Avenida	1170 C6	Yes	5/1/2007	Wet	553'	7' 8"	18	4	2
PomChan 4	Casa Avenida south to Roberto Way	1170 C6	Yes	5/1/2007	Wet	529'	7' 8"	18	4	2
PomChan 5	Roberto Way to Kaliz St.	1170 C7	Yes	5/1/2007	Wet	1332'	6' 3"	15	4	2
PomChan 6	Kaliz St. looking south.	1170 C7	Yes	5/1/2007	Wet	461'	8'	18	4	2
PomChan 7	14975 Amso looking toward Jacala St.	1170 C7	Yes	5/1/2007	Wet	714'	10'	24	4	2
PomChan 8	Jacala St. south to Twin Peaks.	1190 C1	Yes	5/1/2007	Wet	500'	9'	18	4	2
PomChan 9	RCP pipes under shopping center	1190 C1	Yes	5/1/2007	Wet	192'	0	0	4	0.5
PomChan 10	Glen Oak south to Holland St.	1190 C2	Yes	5/1/2007	Wet	1295'	10'	24	4	2
PomChan 11	Holland St. to Vaughan St.	1190 C2	Yes	5/1/2007	Wet	1410'	10'	24	4	2
PomChan 12	Vaughan St. to foot bridge.	1190 C2 and C3	Yes	5/1/2007	Wet	1552'	10'	24	4	2
PomChan 13	Foot bridge to Tassel St.	1190 C3	Yes	5/1/2007	Wet	1206'	16' 8"	45	8	2.5
PomChan 14	Tassel St. to McFeron.	1190 C4	Yes	5/1/2007	Wet	999'	13'	30	4	2
PomChan 15	McFeron to Robison	1190 C4	Yes	5/1/2007	Wet	775'	10'	24	4	2
PomChan 16	Outlet at Brookview Apts.	1190 C5	Yes	5/1/2007	Wet	45'	0	0	4	0.5
PomChan 17	Outlet at Poway Rd. to Oak Knoll Rd.	1190 C5	Yes	5/1/2007	Wet	53'	0	0	4	0.5
PomChan 18	Outlet at Oak Knoll to 50' south of Oak Knoll.	1190 B5	Yes	5/1/2007	Wet	130'	0	0	4	0.5
FloralChan 1	Bowdoin to Fairburn	1190 J4	Yes	5/1/2007	Dry	600'	5' 4"	12	4	1
FloralChan 2	F-airburn to Garden Rd.	1190 J4	Yes	5/1/2007	Dry	825'	4' 9"	9	4	1
AllbrookChan1	East of Iola Wy.	1190 A5	Yes	5/1/2007	Dry	423'	2'	2	4	1
RedCloudChan1	West to Garden Rd	1190 H4	Yes	5/1/2007	Wet	408'	2'	2	4	1
SpringChan 1	Bowdoin south to Springvale	1190 H4	Yes	5/1/2007	Wet	587'	7' 6"	18	4	1.5
PowChan 1	Whitewater at Garden Rd.	1190 J4	Yes	5/1/2007	Wet	383'	30' / 16'	42	8	2.5
PowChan 2	Acton Ave to Standish	1190 H5	Yes	5/2/2007	Wet	1182'	14'	36	4	2
PowChan 3	Standish to Neddick	1190 H5	Yes	5/2/2007	Wet	306'	14'	36	4	2
PowChan 4	Neddick to Claire	1190 H5	Yes	5/2/2007	Wet	585'	20' 5"	60	4	2
CarlCtChan 1	South to Twin Peaks Rd	1190 H1	Yes	5/2/2007	Dry	836'	2' 5"	6	4	1
MtnRdChan 1	West to Espola Rd	1170 G1	Yes	5/2/2007	Dry	218'	2' 3" / 8'	18	4	2
DurhulChan 1	South	1170 G7	Yes	5/2/2007	Dry	942'	3' 2"	9	4	2
DurhulChan 2	East to Espola Rd	1190 G1	Yes	5/2/2007	Dry	695'	10' 8"	24	8	2
DurhulChan 3	South on Espola Rd. to TwinPeaks	1190 G1	Yes	5/2/2007	Dry	840'	3' 2"	9	4	1.5
BudChan 1	South to RSCK	1190 F1	Yes	5/2/2007	Wet	720'	8'	18	4	1.5

Channel Name	Description	Address	Project ID	Start Date	Condition	Length (ft)	Width (ft)	Depth (ft)	Volume (cu ft)	Impact Length	Notes
MidNorChan 1	Midland Rd. North Ch.	Orange Blossom south to Twin Peaks Rd.	1190 F1	5/2/2007	Dry	506'	5' 10"	12	4	1	
R5CKChan 1	R5CK Channel (Norwalk south to Aubrey St.)	Norwalk south to Aubrey St.	1190 F2	5/2/2007	Wet	918'	10'	24	4	1.5	
R5CKChan 2	R5CK Channel (Hilleary Pk.south to Wanesta)	Hilleary Pk.south to Wanesta	1190 E4	5/2/2007	Wet	1161'	20' 9"	60	8	2.5	
R5CKChan 3	R5CK Ch. Community Pk. To Confluence Wall.		1190 D5	5/2/2007	Wet	1530'	31'	60	8	2.5	
AdahChan 1	Adah Ln. Channel (Poway Rd.south to Adah.)		1190 G4	5/2/2007	Dry	817'	8' 7" / 14'	24	4	2	
CedarTreeChan1	Cedar Tree Channel.	East of Elmfield Ln.	1170 D3	5/2/2007	Wet	155'	5' 3"	12	4	1.5	
LuisenoChan 1	Luiseno Bennyee Lee Channel.	Stone Canyon north to Luiseno.	1170 D5	5/2/2007	Wet	260'	4' 6"	12	4	1.5	
IndianTriChan 1	Indian Trail Ch.	North of Bennyee Lee.	1170 D4	5/2/2007	Wet	151'	6' 8"	15	4	1.5	
ReoRealChan 1	Reo Real Ch.	Blanco Ct. west past Reo Real.	1190 D5	5/2/2007	Dry	955'	3' 3"	9	4	1.5	
ComMetChanS 1	Community Rd. Channel. South/of Metate Ln.	Community Pk. To Confluence Wall	1190 D5	5/2/2007	Wet	1006'	5' 5"	12	4	1.5	
ComMetChanN 2	Community Rd. Channel North/of Metate Ln.	North/of Metate Ln.	1190 E5	5/2/2007	Wet	328'	8'	24	4	2	
FranChan 1	Francine and Selma	Need Concrete Repair	1190 B5	5/2/2007	Dry	408'	2'	6	4	2	
BountyChan 1	Add Bounty Way Channel	Perreleis Bounty Way and Harrow Lane	1170 G5	4/15/2009	Dry	1728'	4	12	4	1	
Met North 1	Add Poway Royal	From Metate north to Poway Creek	1190 E5	4/15/2009	Wet	924'	4	12	4	1	
						Total Length If			208	76.5	
						Total Impact Length			76.5		
						BMP Footprint (feet)	0.5		0.5		
						Total BMP Footprint (sq ft)	449		104		Total BMP Footprint (sq ft) 553 SF
						Total BMP Foot Print, (acre) 0.013 acre					

898+208=1106 lf
1106x5x.5=276.5 cu
ft 276.5/27=10.24

Total Cubic Yards
10.24



Linda S. Adams
Secretary for
Environmental Protection

California Regional Water Quality Control Board San Diego Region

Over 50 Years Serving San Diego, Orange, and Riverside Counties

Recipient of the 2004 Environmental Award for Outstanding Achievement from USEPA



Arnold Schwarzenegger
Governor

9174 Sky Park Court, Suite 100, San Diego, California 92123-4353
(858) 467-2952 • Fax (858) 571-6972
<http://www.waterboards.ca.gov/sandiego>

August 13, 2007

In reply refer to:

WPC:18-2007068.02:woodd

Patrick Ryan
Public Works Department
City of Poway
P.O. Box 789
Poway, CA 92074-0789

WDID	9 000001674
CIWQS:	
Place	653562
Reg. Measure	327661
Party	387178
Person	367179

Dear Mr. Ryan:

SUBJECT: Action on Request for Clean Water Act Section 401 Water Quality Certification for the Concrete Flood Control Channel Maintenance and Cleaning Project (File No. 07C-068)

Please find enclosed the Clean Water Act Section 401 Water Quality Certification for the Concrete Flood Control Channel Maintenance and Cleaning Project (Certification). A description of the project and project location can be found in the information sheet, location map, site map, channel location list, site photos, and equipment/BMP schematic, included as part of the Certification (Attachments 1 through 7). Any petition for reconsideration of this Certification must be filed with the State Water Resources Control Board within 30 days of certification action (23 CCR § 3867). If no petition is received, it will be assumed that the City of Poway has accepted and will comply with all conditions of the Certification. Failure to comply with all conditions of this Certification will result in enforcement actions against the City of Poway.

The heading portion of this letter includes a Regional Board code number noted after "In reply refer to:" In order to assist us in the processing of your correspondence please include this code number in the heading or subject line portion of all correspondence and reports to the Regional Board pertaining to this matter.

If you have any questions regarding this notification, please contact Deborah Woodward at (858) 637-5586 or dwoodward@waterboards.ca.gov.

Respectfully,

JOHN H. ROBERTUS
Executive Officer

JHR:bdk:cmc:dlw

California Environmental Protection Agency

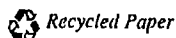

Mr. Patrick Ryan
401 Certification 07C-068

- 2 -

August 13, 2007

Enclosures

1. Clean Water Act Section 401 Water Quality Certification for the Concrete Flood Control Channel Maintenance and Cleaning Project (File No. 07C-068)

cc (via email):

See Distribution List included with Certification (Attachment 2).

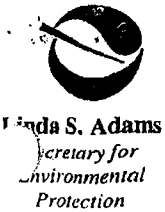

California Regional Water Quality Control Board San Diego Region



Internet Address: <http://www.swrcb.ca.gov/rwqcb9/>
9174 Sky Park Court, Suite 100, San Diego, California 92123
Phone (858) 467-2952 • FAX (858) 571-6972

Arnold Schwarzenegger
Governor

Action on Request for Clean Water Act Section 401 Water Quality Certification and Waiver of Waste Discharge Requirements for Discharge of Dredged and/or Fill Materials

PROJECT: Concrete Flood Control Channel Maintenance and Cleaning
(File No. 07C-068)

APPLICANTS: Mr. Patrick Ryan
Public Works Department
City of Poway
P.O. Box 789
Poway, CA 92074-0789

WDID	9 000001674
CIWQS:	
Place	653562
Reg. Measure	327661
Party	387178
Person	387179

ACTION:

- Order for Low Impact Certification
- Order for Denial of Certification
- Order for Technically-conditioned Certification
- Waiver of Waste Discharge Requirements

STANDARD CONDITIONS:

The following three standard conditions apply to all certification actions, except as noted under Condition 3 for denials (Action 3).

1. This certification action is subject to modification or revocation upon administrative or judicial review, including review and amendment pursuant to section 13330 of the California Water Code and section 3867 of Title 23 of the California Code of Regulations (23 CCR).
2. This certification action is not intended and shall not be construed to apply to any discharge from any activity involving a hydroelectric facility requiring a Federal Energy Regulatory Commission (FERC) license or an amendment to a FERC license unless the pertinent certification application was filed pursuant to 23 CCR subsection 3855(b) and the application specifically identified that a FERC license or amendment to a FERC license for a hydroelectric facility was being sought.
3. The validity of any non-denial certification action (Actions 1 and 2) shall be conditioned upon total payment of the full fee required under 23 CCR section 3833, unless otherwise stated in writing by the certifying agency.

California Environmental Protection Agency

The energy challenge facing California is real. Every Californian needs to take immediate action to reduce energy consumption. For a list of simple ways you can reduce demand and cut your energy costs, see our Web-site at <http://www.swrcb.ca.gov>.

Recycled Paper



ADDITIONAL CONDITIONS:

In addition to the three standard conditions, the City of Poway shall satisfy the following:

A. GENERAL CONDITIONS

1. The City of Poway shall, at all times, fully comply with the engineering plans, specifications and technical reports submitted with this application for 401 Water Quality Certification and all subsequent submittals required as part of this certification. The conditions within this certification shall supersede conflicting provisions within such plans submitted prior to the certification action.
2. The City of Poway shall maintain a copy of this certification at the project site so as to be available at all times to site personnel and agencies.
3. Prior to the start of the project, the City of Poway shall educate all personnel on the requirements in this certification, pollution prevention measures, spill response, and best management practices.
4. The City of Poway shall permit the San Diego Regional Water Quality Control Board (SDRWQCB) or its authorized representative at all times, upon presentation of credentials:
 - a) Entry onto project premises, including all areas on which wetland fill or wetland mitigation is located or in which records are kept.
 - b) Access to copy any records required to be kept under the terms and conditions of this certification.
 - c) Inspection of any treatment equipment, monitoring equipment, or monitoring method required by this certification.
5. The City of Poway shall notify the SDRWQCB within 24 hours of any unauthorized discharge to waters of the U.S. and/or State; measures that were implemented to stop and contain the discharge; measures implemented to clean-up the discharge; the volume and type of materials discharged and recovered; and additional BMPs or other measures that will be implemented to prevent future discharges.
6. The City of Poway shall, at all times, maintain appropriate types and sufficient quantities of materials onsite to contain any spill or inadvertent release of materials that may cause a condition of pollution or nuisance if the materials reached a waters of the U.S. and/or State.
7. This Certification is not transferable to any person except after notice to the Executive Officer of the SDRWQCB. The City of Poway shall submit this notice in writing at least 30 days in advance of any proposed transfer. The notice must include a written agreement between the existing and new owner containing a

specific date for the transfer of this Certification's responsibility and coverage between the current discharger and the new discharger. This agreement shall include an acknowledgement that the existing owner is liable for compliance and violations up to the transfer date and that the new owner is liable from the transfer date on.

8. In the event of any violation or threatened violation of the conditions of this certification, the violation or threatened violation shall be subject to any remedies, penalties, process or sanctions as provided for under state law. For purposes of section 401(d) of the Clean Water Act, the applicability of any state law authorizing remedies, penalties, process or sanctions for the violation or threatened violation constitutes a limitation necessary to assure compliance with the water quality standards and other pertinent requirements incorporated into this certification.
9. In response to a suspected violation of any condition of this certification, the SDRWQCB may require the holder of any permit or license subject to this certification to furnish, under penalty of perjury, any technical or monitoring reports the SDRWQCB deems appropriate, provided that the burden, including costs, of the reports shall be a reasonable relationship to the need for the reports and the benefits to be obtained from the reports.
10. In response to any violation of the conditions of this certification, the SDRWQCB may add to or modify the conditions of this certification as appropriate to ensure compliance.
11. This certification authorizes work only in the concrete channels specified in the application for this Certification; it does not authorize work in earthen channels. Maintenance activities in concrete channels other than those specified in this Certification shall require an amendment to the Certification.
12. This certification expires five years from the date of issuance.

B. REPORTING

1. All information requested in this Certification is pursuant to California Water Code (CWC) section 13267. Civil liability may be administratively imposed by the Regional Board for failure to furnish requested information pursuant to CWC section 13268.
2. All applications, reports, or information submitted to the Regional Board shall be signed and certified as follows:

"I certify under penalty of law that I have personally examined and am familiar with the information submitted in this document and all attachments and that, based on my inquiry of those individuals immediately responsible for obtaining the information, I believe that the information is true, accurate, and complete. I am aware that there are significant penalties for submitting false information, including the possibility of fine and imprisonment."

3. The City of Poway shall submit reports required under this certification, or other information required by the Regional Board, to:

Executive Officer
California Regional Water Quality Control Board
San Diego Region
Attn: 401 Certification; File No 07C-068
9174 Sky Park Court, Suite 100
San Diego, California 92123

PUBLIC NOTIFICATION OF PROJECT APPLICATION:

On July 6, 2007, receipt of the project application was posted on the SDRWQCB web site to serve as appropriate notification to the public.

REGIONAL WATER QUALITY CONTROL BOARD CONTACT PERSON:

Deborah Woodward
California Regional Water Quality Control Board, San Diego Region
9174 Sky Park Court, Suite 100
San Diego, CA 92123
(858) 637-5586
dwoodward@waterboards.ca.gov

WATER QUALITY CERTIFICATION:

I hereby certify that the proposed discharge from the Concrete Flood Control Channel Maintenance and Cleaning (File No. 07C-068) will comply with the applicable provisions of sections 301 ("Effluent Limitations"), 302 ("Water Quality Related Effluent Limitations"), 303 ("Water Quality Standards and Implementation Plans"), 306 ("National Standards of Performance"), and 307 ("Toxic and Pretreatment Effluent Standards") of the Clean Water Act. This discharge is also regulated under California Regional Water Quality Control Board, San Diego Region, Waiver of Waste Discharge Requirements (Waiver Policy) No. 17. Please note that this waiver is conditional and, should new information come to our attention that indicates a water quality problem, the Regional Board may issue waste discharge requirements at that time.

Except insofar as may be modified by any preceding conditions, all certification actions are contingent on (a) the discharge being limited and all proposed mitigation being completed in strict compliance with the applicants' project description and/or on the attached Project Information Sheet, and (b) on compliance with all applicable requirements of the Regional Water Quality Control Board's Water Quality Control Plan (Basin Plan).

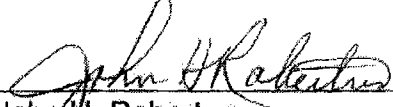

John H. Robertus
Executive Officer
Regional Water Quality Control Board

8/13/2007
Date

- Attachments:
1. Project Information
 2. Distribution List
 3. Location Map
 4. Site Map
 5. List of Concrete Channel Sections
 6. Site Photos
 7. Schematic of Equipment/BMP Placement

**ATTACHMENT 1
PROJECT INFORMATION**

Applicant: Mr. Patrick Ryan
Public Works Department
City of Poway
P.O. Box 789
Poway, CA 92074-0789

Applicant Same
Representatives:

Project Name: Concrete Flood Control Channel Maintenance and Cleaning

Project Location: Various concrete channels in the City of Poway, CA.
See Location Map (**Attachment 3**) and Site Map (**Attachment 4**).

Type of Project: Concrete channel maintenance

Project Description: Annual maintenance of concrete drainage channels in the City of Poway to remove sediment, weeds, trash, and debris (concrete channels only; no natural channels). See List of Concrete Channel Sections to be maintained (**Attachment 5**) and Site Photos (**Attachment 6**).

Federal Agency/Permit: U.S. Army Corps of Engineers Nationwide Permit 18

Other Required Regulatory Approvals: None

California Environmental Quality Act (CEQA) Compliance: On June 26, 2007, the City of Poway determined that the project was Categorically Exempt from CEQA pursuant to CEQA Guidelines Section 15301(b), Class 1.

Receiving Water: Rattlesnake Creek, Poway Creek, Concrete Flood Channels that feed to Los Penasquitos Creek and Los Penasquitos Lagoon.

Impacted Waters of the United States: The project will entail temporary impacts to 0.0123 acres of un-vegetated waters. [Per U.S. Army Corps of Engineers, placement of waddles and oil-absorbent booms during maintenance activities constitutes fill.] No permanent impacts to Waters of the US/State will occur.

Dredge Volume: None

Related Projects Implemented/to be Implemented by the Applicant(s):	None
Compensatory Mitigation:	All impacts will be temporary, and no compensatory mitigation is required.
Best Management Practices:	Straw waddles and oil absorbent booms will be placed at the downstream end of each concrete channel section during maintenance to prevent downstream transport of sediment, debris, and oil. A vacuum truck will be used to remove the straw waddles, oil absorbent booms, and any sediment that may have collected after maintenance activity on each section is completed. Absorbent waddles, drip pan, spill kit, and tarp will be used as appropriate for out-of-channel equipment storage. Concrete channels will be maintained one section at a time to minimize environmental impact. Maintenance will be conducted prior to rainy season when there is little water in the concrete channels, weeds are dry, debris is visible, and the need to control vectors and odor is greatest. In-channel equipment (skid steer, small tractor) will be hoisted out of the channel at the end of each day, and/or if there is a 50% or greater chance of rain within 24 hours. See Schematic of Equipment/BMP Placement (Attachment 7).
Public Notice:	On July 6, 2007, receipt of the project application was posted on the SDRWQCB web site to serve as appropriate notification to the public
Fees:	Total Due: \$500 Total Paid: \$500 (Check No. #00163232)

**ATTACHMENT 2
DISTRIBUTION LIST**

Jeannette Baker
U.S. Army Corps of Engineers
Regulatory Branch
16885 W. Bernardo Dr., Suite 300 A
San Diego, CA 92127
(858) 674-5388 (fax)
jeannette.m.baker.@usace.army.mil

Elizabeth Goldmann
Wetlands Regulatory Office
U.S. Environmental Protection Agency, Region 9
75 Hawthorne Street
San Francisco, CA 94105
(415) 972-3398
goldmann.elizabeth@epa.gov

Bill Orme
State Water Resources Control Board
Division of Water Quality
401 Water Quality Certification and Wetlands Unit
P.O. Box 100
Sacramento, CA 95812-0100
BOrme@waterboards.ca.gov

ATTACHMENT 3 LOCATION MAP

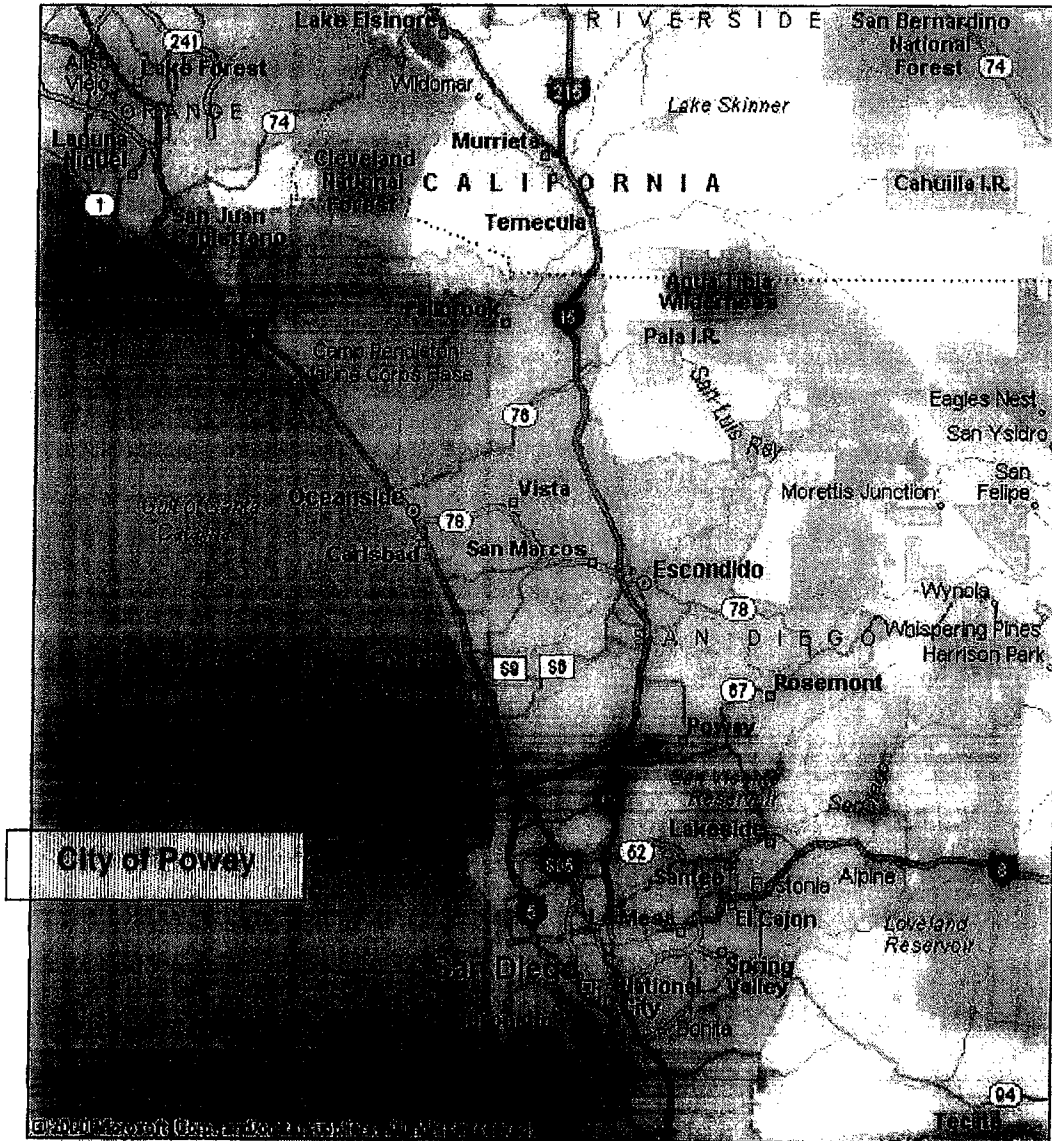

ATTACHMENT 4 SITE MAP

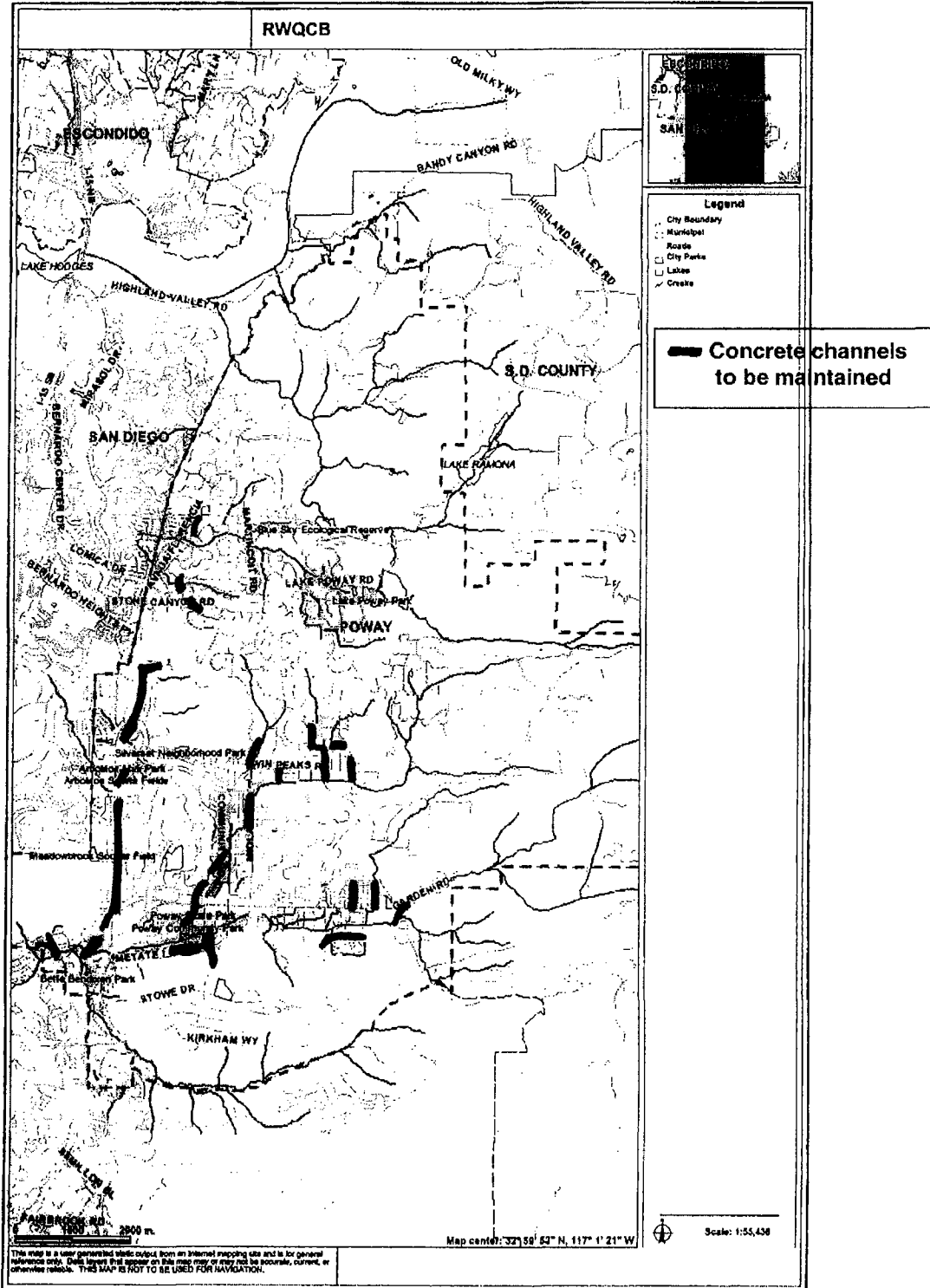

**ATTACHMENT 5
LIST OF CONCRETE CHANNEL SECTIONS**

Concrete Channels '07

ID	Location / Description	Annul	Inspect	Wet/Dry	Length	Width	Waddle Lf	Oil Boom Lf	Stream Length Impact Lf
PomChan 1	Pomerado Channel (South to Poway Creek)	Yes	5/1/2007	Dry	918'	3'	3	4	1
PomChan 2		Yes	5/1/2007	Wet	345'	7' 8"	18	4	2
PomChan 3		Yes	5/1/2007	Wet	553'	7' 8"	18	4	2
PomChan 4		Yes	5/1/2007	Wet	529'	7' 8"	18	4	2
PomChan 5		Yes	5/1/2007	Wet	1332'	6' 3"	15	4	2
PomChan 6		Yes	5/1/2007	Wet	461'	8'	18	4	2
PomChan 7		Yes	5/1/2007	Wet	714'	10'	24	4	2
PomChan 8		Yes	5/1/2007	Wet	500'	9'	18	4	2
PomChan 9		Yes	5/1/2007	Wet	192'	10'	0	4	0.5
PomChan 10		Yes	5/1/2007	Wet	1295'	10'	24	4	2
PomChan 11		Yes	5/1/2007	Wet	1410'	10'	24	4	2
PomChan 12		Yes	5/1/2007	Wet	1552'	10'	24	4	2.5
PomChan 13		Yes	5/1/2007	Wet	1206'	16' 8"	45	8	2
PomChan 14		Yes	5/1/2007	Wet	999'	13'	30	4	2
PomChan 15		Yes	5/1/2007	Wet	775'	10'	24	4	2
PomChan 16		Yes	5/1/2007	Wet	45'	0	0	4	0.5
PomChan 17		Yes	5/1/2007	Wet	63'	0	0	4	0.5
PomChan 18		Yes	5/1/2007	Wet	130'	0	0	4	0.5
FloralChan 1	Floral Channel (South to Poway Creek.)	Yes	5/1/2007	Dry	600'	5' 4"	12	4	1
FloralChan 2	Floral Ch. (East of Iola Wv.)	Yes	5/1/2007	Dry	825'	4' 9"	9	4	1
AlbrookChan1	Albrook Ch. (West of Iola Wv.)	Yes	5/1/2007	Dry	423'	2'	2	4	1
RedCloudChan1	Red Cloud Ch. (West to Garden Rd.)	Yes	5/1/2007	Wet	408'	2'	2	4	1
SpringChan 1	Springvale Ch. (Bowdoin south to Springvale)	Yes	5/1/2007	Wet	587'	7' 6"	18	4	1.5
PowChan 1	Poway Channel (West to Poway Creek)	Yes	5/1/2007	Wet	393'	30' / 16"	42	8	2.5
PowChan 2		Yes	5/1/2007	Wet	1182'	14'	36	4	2
PowChan 3		Yes	5/1/2007	Wet	306'	14'	36	4	2
PowChan 4		Yes	5/1/2007	Wet	565'	20' 5"	60	4	2
CarlChan 1	Carlson Ct.Ch. (South to Twin Peaks Rd.)	Yes	5/1/2007	Dry	836'	2' 5"	6	4	1
MtnRdChan 1	Mountain Rd. Ch. (west to Espolia Rd.)	Yes	5/1/2007	Dry	218'	2' 3" / 8"	18	4	2

**ATTACHMENT 6
SITE PHOTOS**



Adah Ln Chan 01 LS.jpg

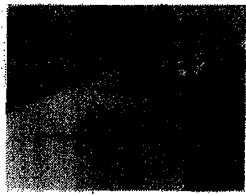

Adah Ln Chan 01.JPG

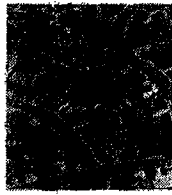

Allbrook Chan 01 LS.jpg

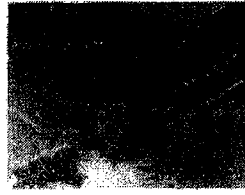

Allbrook Chan 01.JPG



Budwin Chan 01 LS.jpg



Budwin Chan 01.JPG



Carlson Ct Chan 01 LS.jpg

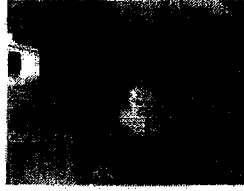

Carlson Ct Chan 01.JPG



Cedar Tree Chan 01 LS.jpg



Cedar Tree Chan 01.JPG



Community Metate North Chan 01 LS.jpg



Community Metate North Chan 01.JPG



Community Metate South Chan 01 LS.jpg



Community Metate South Chan 01.JPG



Durhullen Chan 01 LS.jpg



Durhullen Chan 01.JPG



Floral Chan 01 LS.jpg



Floral Chan 01.JPG



Floral Chan 02 LS.jpg



Floral Chan 02.JPG



Fran Chan 01.JPG



Indian Trail Chan 01 LS.jpg



Indian Trail Chan 01.JPG



Luiseno B. Lee Chan 01 LS.jpg

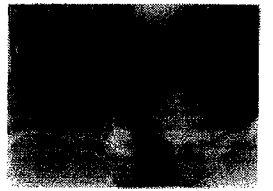

Luiseno B. Lee Chan 01.JPG



Midland North Chan 01 LS.jpg



Midland North Chan 01.JPG



Mtn Rd Chan 01 LS.jpg

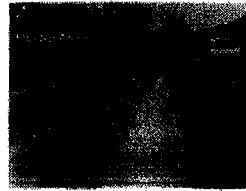

Mtn Rd Chan 01.JPG



Pom Chan 01 LS.jpg



Pom Chan 01.JPG



Pom Chan 02 LS.jpg



Pom Chan 02.JPG



Pom Chan 03 LS.jpg



Pom Chan 03.JPG



Pom Chan 04 LS.jpg



Pom Chan 04.JPG



Pom Chan 05 LS.jpg



Pom Chan 05.JPG



Pom Chan 06 LS.jpg



Pom Chan 06.JPG



Pom Chan 07 LS.jpg



Pom Chan 07.JPG



Pom Chan 08 LS.jpg



Pom Chan 08.JPG

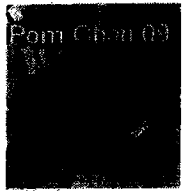

Pom Chan 09 LS.jpg



Pom Chan 09.JPG



Pom Chan 10 LS.jpg



Pom Chan 10.JPG



Pom Chan 11 LS.jpg

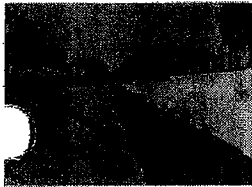

Pom Chan 11.JPG



Pom Chan 12 LS.jpg

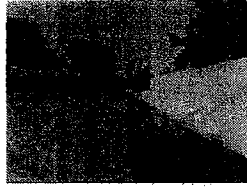

Pom Chan 12.JPG



Pom Chan 13 LS.jpg

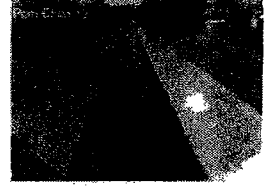

Pom Chan 13.JPG



Pom Chan 14 LS.jpg



Pom Chan 14.JPG



Pom Chan 15 LS.jpg



Pom Chan 15.JPG



Pom Chan 16 LS.jpg



Pom Chan 16.JPG



Pom Chan 17 LS.jpg



Pom Chan 17.JPG



Pom Chan 18 LS.jpg



Pom Chan 18.JPG



Pow Chan 01 LS.jpg



Pow Chan 01.JPG



Pow Chan 02 LS.jpg

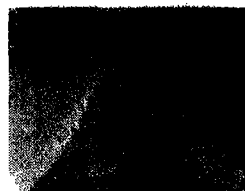

Pow Chan 02.JPG



Pow Chan 03 LS.jpg



Pow Chan 03.JPG



Pow Chan 04 LS.jpg

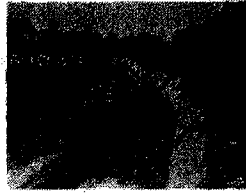

Pow Chan 04.JPG



Red Cloud Chan 01 LS.jpg



Red Cloud Chan 01.JPG

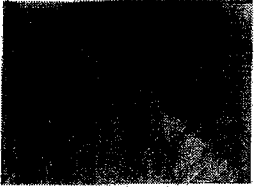

Reo Real Chan 01.JPG



Reo Real Chan 011.jpg



RSCK Chan 01 LS.jpg

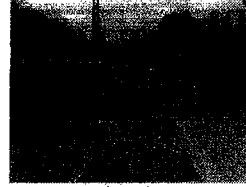

RSCK Chan 01.JPG



RSCK Chan 02 LS.jpg



RSCK Chan 02.JPG



RSCK Chan 03 LS.jpg



RSCK Chan 03.JPG



Springvale Chan 01 LS.jpg



Springvale Chan 01.JPG

ATTACHMENT 7 SCHEMATIC OF EQUIPMENT/BMP PLACEMENT

