



California Regional Water Quality Control Board

San Diego Region



Over 50 Years Serving San Diego, Orange, and Riverside Counties

Recipient of the 2004 Environmental Award for Outstanding Achievement from USEPA

Linda S. Adams
Acting Secretary for
Environmental Protection

Edmund G. Brown Jr.
Governor

9174 Sky Park Court, Suite 100, San Diego, California 92123-4353
(858) 467-2952 • Fax (858) 571-6972
<http://www.waterboards.ca.gov/sandiego>

April 25, 2011

Certified Mail – Return Receipt Requested
Article Number: 7010 1060 0000 4952 7914

Jerry Backoff
City of San Marcos
1 Civic Center Drive
San Marcos, CA 92069

In reply refer to:
751786: amonji

Subject: Action on Request for Clean Water Act Section 401 Water Quality Certification for the **Grand Avenue/Los Posas Reach Flood Protection Project** Water Quality Certification No. **10C-029**.

Dear Mr. Backoff:

Enclosed find Clean Water Act Section 401 Water Quality Certification for discharges to waters of the U.S. and acknowledgment of enrollment under State Water Resources Control Board Order No. 2003-017 DWQ for the **Grand Avenue/Los Posas Reach Flood Protection Project** (Project). A description of the Project and Project location can be found in the project information sheet, location map, and site maps, which are included as Attachments 1 through 4.

Any petition for reconsideration of this Certification must be filed with the State Water Resources Control Board within 30 days of certification action (23 CCR § 3867). If no petition is received, it will be assumed that you have accepted and will comply with all the conditions of this Certification.

Failure to comply with all conditions of this Certification may subject you to enforcement actions by the California Regional Water Quality Control Board, San Diego Region, including administrative enforcement orders requiring you to cease and desist from violations, or to clean up waste and abate existing or threatened conditions of pollution or nuisance; administrative civil liability in amounts of up to \$10,000 per day per violation; referral to the State Attorney General for injunctive relief; and, referral to the District Attorney for criminal prosecution.

In the subject line of any response, please include the requested "In reply refer to:" information located in the heading of this letter. For questions pertaining to the subject matter, please contact Alan Monji at (858) 627-7140 or amonji@waterboards.ca.gov.

Respectfully,



DAVID W. GIBSON
Executive Officer

Enclosures:

Clean Water Act Section 401 Water Quality Certification No. 10C-029 for the Grand Avenue/Los Posas Reach Flood Protection Project, with 4 attachments.

cc: Refer to Attachment 2 of Certification 10C-029 for Distribution List.

Tech Staff Info & Use	
File No.	10C-029
WDID	9000002059
Reg. Measure ID	373818
Place ID	751786
Party ID	369584
Person ID	522180

California Regional Water Quality Control Board San Diego Region



Edmund G.
Brown Jr.
Governor

Over 50 Years Serving San Diego, Orange, and Riverside Counties
Recipient of the 2004 Environmental Award for Outstanding Achievement from USEPA

9174 Sky Park Court, Suite 100, San Diego, California 92123-4340
(858) 467-2952 • Fax (858) 571-6972
[http:// www.waterboards.ca.gov/sandiego](http://www.waterboards.ca.gov/sandiego)

Action on Request for
Clean Water Act Section 401 Water Quality Certification
and Waste Discharge Requirements
for Discharge of Dredged and/or Fill Materials

PROJECT: Grand Avenue/Los Posas Reach Flood Protection Project
Certification Number: 10C-029
WDID Number: 9 000002059

APPLICANT: Jerry Backoff
City of San Marcos
1 Civic Center Drive
San Marcos, CA 92069

CIWQS
Reg. Mes. ID: 373818
Place ID: 751786
Party ID: 369584

ACTION:

<input type="checkbox"/> Order for Low Impact Certification	<input type="checkbox"/> Order for Denial of Certification
<input checked="" type="checkbox"/> Order for Technically-conditioned Certification	<input type="checkbox"/> Waiver of Waste Discharge Requirements
<input checked="" type="checkbox"/> Enrollment in SWRCB GWDR Order No. 2003-017 DWQ	<input type="checkbox"/> Enrollment in Isolated Waters Order No. 2004-004 DWQ

PROJECT DESCRIPTION:

The Project is located in the City of San Marcos along the south side of Grand Avenue between Via Vera Cruz and Linda Vista Drive. Los Posas Creek is an existing north to south trending perennial drainage channel that crosses under Grand Avenue. The Project site is approximately 2.5 acres within a 9.5 acre area surrounding City of San Marcos owned land.

The project includes the installation of a new two-lane, 57-foot-long by 38-foot-wide (2,166 square feet) by 15-foot-high bridge spanning Las Posas Creek to provide access to future redevelopment on the south side of the creek and improved energy dissipaters for six culvert outlets. Future development projects draining into these culverts will need to address treatment of all run-off flowing into these culverts with compliance with the County of San Diego's Municipal Storm Water NPDES permit. Roadway improvements on either side of the bridge will be part of future site redevelopment plans and are not included in this permit action.

California Environmental Protection Agency

The energy challenge facing California is real. Every Californian needs to take immediate action to reduce energy consumption. For a list of simple ways you can reduce demand and cut your energy costs, see our Web-site at <http://www.swrcb.ca.gov>.

Recycled Paper



The project will permanently impact 0.021 acres (192 linear feet) of wetland waters of the United States and impact 0.06 acres (319 linear feet) of waters of the State.

The project proposes to widen a 750 foot section of Las Posas Creek from the box culvert located under Grand Avenue to the southwest property line where the creek exits the site. The creek will be widened to a maximum width of 48 feet to accommodate a 100-year storm event and restore more natural functions and services to that portion of the creek. The channel bottom and banks will remain earthen and be restored with native riparian plant species.

A setback of 20 feet will be established from the new channel top of bank, which will be hydroseeded with a non-invasive seed mix. Future development of the adjacent property will include landscaping and stormwater management designs with natural upland vegetation and functions that will be in compliance with R9-2007-0001, the current San Diego Municipal Storm Water NPDES permit, and subsequent versions of the permit.

Proposed improvements that were originally part of the application but have since been removed include:

- The construction of a 24 to 42-foot-wide (curb to curb) street within an approximately 0.4-acre disturbed/developed area from Grand Avenue to the proposed bridge;
- The rough grading of an approximately 1.4-acre area along Grand Avenue between the proposed new street and Las Posas Creek for a potential future building pad; and
- The demolition of three existing buildings at 983, 1003, and 1023 Grand Avenue in support of future redevelopment activities.

STANDARD CONDITIONS:

The following three standard conditions apply to all Certification actions, except as noted under Condition 3 for denials (Action 3).

1. This Certification action is subject to modification or revocation upon administrative or judicial review, including review and amendment pursuant to section 13330 of the California Water Code and section 3867 of Title 23 of the California Code of Regulations (23 CCR).
2. This Certification action is not intended and must not be construed to apply to any discharge from any activity involving a hydroelectric facility requiring a Federal Energy Regulatory Commission (FERC) license or an amendment to a FERC license unless the pertinent Certification application was filed pursuant to 23 CCR subsection 3855(b) and the application specifically identified that a FERC license or amendment to a FERC license for a hydroelectric facility was being sought.

3. The validity of any non-denial Certification action (Actions 1 and 2) must be conditioned upon total payment of the full fee required under 23 CCR section 3833, unless otherwise stated in writing by the certifying agency.

ADDITIONAL CONDITIONS:

In addition to the three standard conditions, City of San Marcos must satisfy the following:

A. GENERAL CONDITIONS:

1. City of San Marcos must, at all times, fully comply with the engineering plans, specifications and technical reports submitted to the California Regional Water Quality Control Board, San Diego Region (San Diego Water Board), to support this 401 Water Quality Certification (Certification) and all subsequent submittals required as part of this Certification and as described in Attachment 1. The conditions within this Certification must supersede conflicting provisions within such plans submitted prior to the Certification action. Any modifications thereto, would require notification to the San Diego Water Board and reevaluation for individual Waste Discharge Requirements and/or Certification amendment.
2. During construction, City of San Marcos must maintain a copy of this Certification at the Project site so as to be available at all times to site personnel and agencies.
3. City of San Marcos must permit the San Diego Water Board or its authorized representative at all times, upon presentation of credentials:
 - a. Entry onto Project premises, including all areas on which wetland fill or wetland mitigation is located or in which records are kept.
 - b. Access to copy any records required to be kept under the terms and conditions of this Certification.
 - c. Inspection of any treatment equipment, monitoring equipment, or monitoring method required by this Certification.
 - d. Sampling of any discharge or surface water covered by this Order.
4. The City of San Marcos must report to the San Diego Water Board any noncompliance which may endanger human health or the environment. Any information shall be provided orally **within 24 hours** from the time the City of San Marcos becomes aware of the circumstances. A written submission shall also be provided within five (5) days of the time the City of San Marcos becomes aware of the circumstances. The written submission shall contain a written description of the incident and its cause, the period of the noncompliance including exact dates and times, and if the and if the noncompliance has not been corrected, the anticipated time it is expected to

continue; and steps taken or planned to reduce, eliminate, and prevent reoccurrence of the noncompliance. The San Diego Water Board may waive the above-required written report under this provision on a case-by-case basis if an oral report has been received within 24 hours.

5. City of San Marcos must, at all times, maintain appropriate types and sufficient quantities of materials onsite to contain any spill or inadvertent release of materials that may cause a condition of pollution or nuisance if the materials reach waters of the United States and/or State.
6. This Certification is not transferable to any person except after notice to the San Diego Water Board in accordance with the following term.
 - a. **Transfer of Property Ownership:** City of San Marcos must notify the San Diego Water Board of any change in ownership of the project area. Notification of change in ownership must include, but not be limited to, a statement that City of San Marcos has provided the purchaser with a copy of the Section 401 Water Quality Certification and that the purchaser understands and accepts the certification requirements and the obligation to implement them or be subject to liability for failure to do so; the seller and purchaser must sign and date the notification and provide such notification to the Executive officer of the San Diego Water Board within **10 days** of the transfer of ownership.
 - b. **Transfer of Mitigation Responsibility:** Any notification of transfer of responsibilities to satisfy the mitigation requirements set forth in Section D shall include a signed statement from an authorized representative of the new party (transferee) demonstrating acceptance and understanding of the responsibility to comply with and fully satisfy the mitigation conditions and agreement that failure to comply with the mitigation conditions and associated requirements may subject the transferee to enforcement by the San Diego Water Board under Water Code section 13385, subdivision (a). Notification of transfer of responsibilities meeting the above conditions must be provided to the San Diego Water Board within **10 days** of the transfer date.
 - c. **Transfer of Post-Construction BMP Maintenance Responsibility:** The City of San Marcos assumes responsibility for the inspection and maintenance of all post-construction structural BMPs until such responsibility is legally transferred to another entity. At the time maintenance responsibility for post-construction BMPs is legally transferred, the City of San Marcos must submit to the San Diego Water Board a copy of such documentation and must provide the transferee with a copy of a long-term BMP maintenance plan that complies with manufacturer specifications.

7. In the event of any violation or threatened violation of the conditions of this Certification, the violation or threatened violation must be subject to any remedies, penalties, process or sanctions as provided for under State law. For purposes of section 401(d) of the Clean Water Act, the applicability of any State law authorizing remedies, penalties, process or sanctions for the violation or threatened violation constitutes a limitation necessary to assure compliance with the water quality standards and other pertinent requirements incorporated into this Certification.
8. In response to a suspected violation of any condition of this Certification, the San Diego Water Board may, pursuant to Water Code sections 13267 and 13383, require the holder of any permit or license subject to this Certification to investigate, monitor, and report information on the violation. The only restriction is that the burden, including costs of the reports, must bear a reasonable relationship to the need and the benefits to be obtained from the reports.
9. In response to any violation of the conditions of this Certification, the San Diego Water Board may modify the conditions of this Certification as appropriate to ensure compliance.
10. City of San Marcos and successor owners must submit annual progress reports to the San Diego Water Board prior to **August 1** of each year following the issuance of this Certification until the project has reached completion.
11. City of San Marcos must submit a **Final Project Annual Report** to the San Diego Water Board within 30 days of completion of the project. The report should include as-built drawings no bigger than 11" x 17" and photos of the completed project including post-construction BMPs.

B. PROJECT CONDITIONS:

1. Prior to the start of the project, and annually thereafter, City of San Marcos must educate all personnel on the requirements in this Certification, pollution prevention measures, spill response, and BMP implementation and maintenance.
2. City of San Marcos must comply with the requirements of State Water Resources Control Board Water Quality Order No. 2003-0017-DWQ; *Statewide General Waste Discharge Requirements for Discharges of Dredged or Fill Material that has Received State Water Quality Certification*. These General Waste Discharge Requirement are accessible at:
http://www.waterboards.ca.gov/cwa401/docs/generalorders/go_wdr401regulated_projects.pdf.

3. City of San Marcos must notify the San Diego Water Board in writing at least **5 days** prior to the actual commencement of dredge, fill, and discharge activities.
4. City of San Marcos must enroll in and comply with the requirements of State Water Resources Control Board Water Quality Order No. 2009-0009-DWQ, and any subsequent re-issuance as applicable, the *NPDES General Permit for Storm Water Discharges Associated with Construction Activity*.
5. The treatment, storage, and disposal of wastewater during the life of the project must be done in accordance with waste discharge requirements established by the San Diego Water Board pursuant to CWC § 13260.
6. Discharges of concentrated flow during construction or after completion must not cause downstream erosion or damage to properties or stream habitat.
7. Water containing mud, silt, or other pollutants from equipment washing or other activities, must not be discharged to waters of the United States and/or the State or placed in locations that may be subjected to storm flows. Pollutants discharged to areas within a stream diversion area must be removed at the end of each work day or sooner if rain is predicted.
8. All surface waters, including ponded waters, must be diverted away from areas undergoing grading, construction, excavation, vegetation removal, and/or any other activity which may result in a discharge to the receiving water. Diversion activities must not result in the degradation of beneficial uses or exceedance of water quality objectives of the receiving waters. Any temporary dam or other artificial obstruction constructed must only be built from materials such as clean gravel which will cause little or no siltation. Normal flows must be restored to the affected stream immediately upon completion of work at that location.
9. Substances hazardous to aquatic life including, but not limited to, petroleum products, raw cement/concrete, asphalt, and coating materials, must be prevented from contaminating the soil and/or entering waters of the United States and/or State. BMPs must be implemented to prevent such discharges during each project activity involving hazardous materials.
10. All areas that will be left in a rough graded state must be revegetated with native species no later than one week after completion of grading. The revegetation palette must not contain any plants listed on the California Invasive Plant Council Invasive Plant Inventory, which can be found online at <http://www.cal-ipc.org/ip/inventory/weedlist.php>.
11. A copy of the Final Wetland Restoration and Monitoring Plan for the Grand Avenue/Las Posas Reach Flood Control Protection Project will be submitted

to the San Diego Water Board within **30 days of issuance of the this Water Quality Certification** for review and approval.

C. POST CONSTRUCTION STORM WATER MANAGEMENT:

1. All storm drain inlet structures within the project boundaries must be stamped and/or stenciled (or equivalent) with appropriate language prohibiting non-storm water discharges.
2. All post-construction BMPs, in the *Final Master Water Quality Technical Report for Grand Ave. Drainage/Road Improvements, San Marcos, CA, CIP No. 317, revised on February 3, 2011*, and approved by the City of San Marcos on February 28, 2011, must be sized to comply with the following numeric sizing criteria:

a. Volume

Volume-based BMPs must be designed to mitigate (infiltrate, filter, or treat) either:

- i. The volume of runoff produced from a 24-hour 85th percentile storm event, as determined from the local historical rainfall record; or
- ii. The volume of runoff produced by the 85th percentile 24-hour rainfall event, determined as the maximized capture storm water volume for the area, from the formula recommended in Urban Runoff Quality Management, WEF Manual of Practice No. 23/ASCE Manual of Practice No. 87, (1998); or
- iii. The volume of annual runoff based on unit basin storage volume, to achieve 90% or more volume treatment by the method recommended in California Stormwater Best Management Practices Handbook – Industrial/Commercial, (1993); or
- iv. The volume of runoff, as determined from the local historical rainfall record, that achieves approximately the same reduction in pollutant loads and flows as achieved by mitigation of the 85th percentile 24-hour runoff event; or

b. Flow

Flow-based BMPs must be designed to mitigate (infiltrate, filter, or treat) either:

- i. The maximum flow rate of runoff produced from a rainfall intensity of 0.2 inch of rainfall per hour; or
- ii. The maximum flow rate of runoff produced by the 85th percentile hourly rainfall intensity, as determined from the local historical rainfall record, multiplied by a factor of two; or
- iii. The maximum flow rate of runoff, as determined from the local historical rainfall record, that achieves approximately the same reduction in pollutant loads and flows as achieved

by mitigation of the 85th percentile hourly rainfall intensity multiplied by a factor of two.

3. Post-construction BMPs include efficient irrigation systems, storm water conveyance system stenciling and signage, and two bioretention facilities. Post-construction BMPs must be installed and functional prior to occupancy and/or planned use of development areas.
4. Records must be kept regarding inspections and maintenance in order to assess the performance of the systems and determine whether adaptations are necessary to protect receiving waters.
5. All post-construction structural BMPs must be regularly inspected and maintained for the life of the project per manufacturers' specifications and the Water Quality Management Plan prepared for the project by O'Day Consultants for the City of San Marcos on December 10, 2009, last revised on February 3, 2011, and approved on February 28, 2011.
6. Preventive and corrective maintenance procedures during construction will be performed as outlined in the Storm Water Pollution Prevention Plan prepared for the project by O'Day Consultants for the City of San Marcos on June 25, 2010.
7. A setback of 20 feet will be established from the new channel top of bank, and will be hydroseeded with a non-invasive seed mix.

D. COMPENSATORY MITIGATION FOR LOSS OF WATERS OF THE UNITED STATES/STATE:

1. Mitigation for permanent impacts to 0.021 acres (192 linear feet) of wetland waters of the United States and impact to 0.06 acres (319 linear feet) of waters of the State associated with the City of San Marcos Grand Ave/Los Posas Creek project must be achieved by restoration and establishment of portions of Los Posas Creek on City of San Marcos lands at a 5:1 ratio. Based on this ratio, 0.62 acres of restoration and establishment is required to be conducted in accordance with the Revised Wetland Restoration and Monitoring Plan for the Grand Avenue/Los Posas Reach Flood Protection Project prepared by Dudek and dated August, 2010 (and any subsequent versions of the plan approved by the San Diego Water Board; See Condition B.11).
2. City of San Marcos must restore all areas of temporary impacts and all other areas of temporary disturbance which could result in a discharge or a threatened discharge to waters of the United States/State. Restoration must include grading of disturbed areas to pre-project contours and revegetation

with native species. The City of San Marcos must implement all necessary BMPs to control erosion and runoff from areas associated with this project.

3. San Diego Water Board acceptance of the final mitigation plan applies only to the site and plan that mitigates for the City of San Marcos **Grand Ave/Los Posas Creek Reach Flood Protection Project** and must not be construed as approval of the mitigation site or plan for use by other current or future project.
4. City of San Marcos must salvage leaf litter, coarse woody debris, and upper soil horizons from impacted jurisdictional water sites that are relatively free of invasive exotic species for use in on-site mitigation areas.
5. City of San Marcos must also salvage large cuttings from appropriate tree species if they exist at the impact site and use them as pole plantings at the mitigation site.
6. **Prior to the start of construction**, City of San Marcos must provide the San Diego Water Board a draft preservation mechanism (e.g. deed restriction, conservation easement, etc.) that will protect all mitigation areas and their buffers in perpetuity. **Within one year of the issuance of this Certification**, City of San Marcos must submit proof of a completed preservation mechanism that will protect all mitigation areas and their buffers in perpetuity. The conservation easement, deed restriction, or other legal limitation on the mitigation property must be adequate to demonstrate that the site will be maintained without future development or encroachment on the site which could otherwise reduce the functions and values of the site for the variety of beneficial uses of waters of the United States that it supports. The legal limitation must prohibit, without exception, all residential, commercial, industrial, institutional, and transportation development, and any other infrastructure development that would not maintain or enhance the wetland and streambed functions and values of the site. The preservation mechanism must clearly prohibit activities that would result in soil disturbance or vegetation removal, other than the removal of non-native vegetation. Other infrastructure development to be prohibited includes, but is not limited to, additional utility lines, maintenance roads, and areas of maintained landscaping for recreation.
7. City of San Marcos must submit a report (including topography maps and planting locations) to the San Diego Water Board within **90 days** of completion of mitigation site preparation and planting, describing as-built status of the mitigation project.
8. The construction of proposed mitigation must be concurrent with project grading and completed no later than 9 months following the initial discharge of dredge or fill material into on-site waters. Delays in implementing

mitigation must be compensated by increasing mitigation by 10 percent of the cumulative compensatory mitigation for each month of delay.

9. Prior to initiation of activities, City of San Marcos must conduct a quantitative function-based assessment using California Rapid Assessment Method (CRAM) to evaluate the pre-project condition of the site. The results of the assessment must be submitted in the San Diego Water Board **first Mitigation Monitoring Report (see Condition D.14)**. Follow-up CRAM assessments will be conducted upon establishment of success criteria and reported in the final mitigation report.
10. Bioassessment monitoring shall be performed using the professional-level non-point source protocol of the California Stream Bioassessment procedure¹ to assess effects of the project on the biological integrity of receiving waters prior to initiating activities and upon establishment of success criteria. At a minimum, bioassessment monitoring shall be performed at three sites (assessment stations) on Los Posas Creek once per year, during the established "index period" for the watershed. The first assessment station is the reference station, which shall be located upstream of the discharge from the project site on Los Posas Creek in an reference area; the second assessment station shall be located immediately upstream of the discharge from the project site on the Los Posas Creek; the third assessment station shall be located immediately downstream of the discharge from the Los Posas Creek. The reference station upstream of the project discharge shall be located and sampled concurrently with second and third assessment stations. The results of the Benthic Macroinvertebrate Community Analysis shall be submitted **with the respective Mitigation Monitoring Report** (see Condition D.14).
11. Throughout the mitigation monitoring program mitigation areas must be maintained free of perennial exotic plant species including, but not limited to, pampas grass, giant reed, tamarisk, sweet fennel, tree tobacco, castor bean, and pepper tree. Annual exotic plant species must not occupy more than 10 percent of the onsite or offsite mitigation areas.
12. Any maintenance activities that do not contribute to the success of the mitigation site and enhancement of beneficial uses and ecological functions and services are prohibited. Maintenance activities are limited to the removal of trash and debris, removal of exotic plant species, replacement of dead native plant species and remedial measures deemed necessary for the success of the restoration program.

¹ Copies of the California Stream Bioassessment Procedure can be obtained at <http://www.dfg.ca.gov/cabw/cabwhome.html>. Additional information on stream bioassessment may be obtained at <http://www.waterboards.ca.gov/sandiego/programs/bioassessment.html>

13. If at any time during the implementation and establishment of the mitigation area(s), and prior to verification of meeting success criteria, a catastrophic natural event (e.g., fire, flood) occurs and impacts the mitigation area, City of San Marcos is responsible for repair and replanting of the damaged area(s).
14. Mitigation monitoring reports must be submitted annually until mitigation has been deemed successful. Annual monitoring reports must be submitted prior to **December 1** of each year. Monitoring reports must include, but not be limited to, the following:
 - a. Names, qualifications, and affiliations of the persons contributing to the report;
 - b. Tables presenting the raw data collected in the field as well as analyses of the physical and biological data, including at a minimum;
 - c. Topographic complexity characteristics at each mitigation site;
 - d. Upstream and downstream habitat and hydrologic connectivity;
 - e. Source of hydrology;
 - f. Width of native vegetation buffer around the entire mitigation site;
 - g. Qualitative and quantitative comparisons of current mitigation conditions with pre-construction conditions and previous mitigation monitoring results;
 - h. Photo documentation from established reference points;
 - i. A Survey report documenting boundaries of mitigation area; and
 - j. Other items specified in the final Revised Wetland Restoration and Monitoring Plan.
15. For purposes of this Certification, establishment is defined as the creation of vegetated or unvegetated waters of the United States/State where the resource has never previously existed (e.g. conversion of nonnative grassland to a freshwater marsh). Restoration is divided into two activities, re-establishment and rehabilitation. Re-establishment is defined as the return of natural/historic functions to a site where vegetated or unvegetated waters of the United States/State previously existed (e.g., removal of fill material to restore a drainage). Rehabilitation is defined as the improvement of the general suite of functions of degraded vegetated or unvegetated waters of the United States/State (e.g., removal of a heavy infestation or monoculture of exotic plant species from jurisdictional areas and replacing with native species). Enhancement is defined as the improvement to one or two functions of existing vegetated or unvegetated waters of the United States/State (e.g., removal of small patches of exotic plant species from an area containing predominantly natural plant species). Preservation is defined as the acquisition and legal protection from future impacts in perpetuity of existing vegetated or unvegetated waters of the United States/State (e.g., conservation easement).

16. For the purpose of determining mitigation credit for the removal of exotic/invasive plant species, only the actual area occupied by exotic/invasive plant species must be quantified to comply with mitigation requirements.

E. PHOTO DOCUMENTATION PROCEDURE:

1. City of San Marcos must conduct photo documentation of the Project site including post construction BMPs, all areas of permanent and temporary impact, prior to and after project construction, and mitigation areas prior to and after project construction. Photo documentation must be conducted in accordance with the State Water Resources Control Board Standard Operating Procedure 4.2.1.4: Stream Photo Documentation Procedure, found at:
http://www.waterboards.ca.gov/water_issues/programs/swamp/docs/cwt/guidance/4214.pdf). In addition, photo documentation must include Geographic Positioning System (GPS) coordinates for each of the photo points referenced. City of San Marcos must submit this information in a photo documentation report to the San Diego Water Board with **Annual Reports (see Condition A.10)**. The report must include a compact disc that contains digital files of all the photos (jpeg file type or similar).

F. GEOGRAPHIC INFORMATION SYSTEM REPORTING

1. City of San Marcos must submit Geographic Information System (GIS) shape files of the impact and mitigation areas within **30 days** of mitigation installation. All impact and mitigation areas shape files must be polygons. Two GPS readings (points) must be taken on each line of the polygon and the polygon must have a minimum of 10 points. GIS metadata must also be submitted.

G. REPORTING:

1. The submittal of information under this Certification is required pursuant to California Water Code (CWC) sections 13267 and 13383. Civil liability may be administratively imposed by the San Diego Water Board for failure to submit required information pursuant to CWC section 13268.
2. All reports and information submitted to the San Diego Water Board must be submitted in both hardcopy and electronic format. The preferred electronic format for each report submission is one file in PDF format that is also Optical Character Recognition (OCR) capable.
3. All applications, reports, or information submitted to the San Diego Water Board must be signed and certified as follows:

- a. For a corporation, by a responsible corporate officer of at least the level of vice president.
 - b. For a municipality, or a state, federal, or other public agency, by either a principal executive officer or ranking elected official.
 - c. For a municipality, or a state, federal, or other public agency, by either a principal executive officer or ranking elected official.
4. A duly authorized representative of a person designated in Items 3.a. through 3.c. above may sign documents if:
- a. The authorization is made in writing by a person described in Items 3.a. through 3.c. above.
 - b. The authorization specifies either an individual or position having responsibility for the overall operation of the regulated activity.
 - c. The written authorization is submitted to the San Diego Water Board Executive Officer.
5. All applications, reports, or information submitted to the San Diego Water Board must be signed and certified as follows:

"I certify under penalty of law that I have personally examined and am familiar with the information submitted in this document and all attachments and that, based on my inquiry of those individuals immediately responsible for obtaining the information, I believe that the information is true, accurate, and complete. I am aware that there are significant penalties for submitting false information, including the possibility of fine and imprisonment."

6. City of San Marcos must submit reports required under this Certification, or other information required by the San Diego Water Board, to:

Executive Officer
California Regional Water Quality Control Board
San Diego Region
Attn: 401 Certification; Project No. 10C-029
9174 Sky Park Court, Suite 100
San Diego, California 92123

7. The following list summarizes the required reports, excluding spill notifications and emergency situations, per the conditions of this Certification to be submitted to the San Diego Water Board.

Report Topic	Certification Condition	Due Date(s)
Unauthorized Discharge	A.4	Within 24 hours
Transfer of Property Ownership	A.6.a	Within 10 Days of Transfer of Ownership
Transfer of Mitigation Responsibility	A.6.b	Within 10 Days of Transfer Date
Project Annual Reports	A.10	August 01, Annually
As-Built Drawings	A.11	With Annual Reports
Notification of dredge/fill	B.3	5 days prior
Final Mitigation Plan	B.11	Within 30 Days of Certification
Draft Preservation Mechanism	D.6	Prior to Construction
Final Preservation Mechanism	D.6	Within 1 year of Start of Construction
Mitigation As-Built Drawings	D.7	Within 90 Days of Mitigation Site Preparation and Planting
CRAM Assessment	D.9	With Annual Reports (D.14)
Benthic Macroinvertebrate Community Analysis	D.10	With Annual Reports (D.14)
Mitigation Annual Reports	D.14	December 1, Annually
Photo Documentation	E.1	With Mitigation Reports
GIS Reporting	F.1	Within 30 Days of Mitigation Installation

CEQA FINDINGS:

1. City of San Marcos is the lead agency under the California Environmental Quality Act (Public Resources Code section 21000, et seq., (CEQA)), and prepared a Mitigated Negative Declaration pursuant to CEQA requirements. A Notice of Determination was filed on December 7, 2009 for a Mitigated Negative Declaration (SCH# 2009091007) for the project under CEQA Guidelines Title 14, California Code of Regulations, 15075 (14 CCR § 15075).
2. The San Diego Water Board has reviewed the Mitigated Negative Declaration and also finds that the project as proposed will not have a significant effect on the environment with incorporation of mitigation measures. The San Diego Water Board therefore determines that issuance of this Certification is consistent with the Mitigated Negative Declaration.

PUBLIC NOTIFICATION OF PROJECT APPLICATION:

On **April 20, 2010** receipt of the project application was posted on the San Diego Water Board web site to serve as appropriate notification to the public. No comments were received for this project.

SAN DIEGO WATER BOARD CONTACT PERSON:

Alan Monji
California Regional Water Quality Control Board, San Diego Region
9174 Sky Park Court, Suite 100
San Diego, CA 92123
858-637-7140
amonji@waterboards.ca.gov

WATER QUALITY CERTIFICATION:

I hereby certify that the proposed discharge from the City of San Marcos (Project No. 10C-029) will comply with the applicable provisions of sections 301 ("Effluent Limitations"), 302 ("Water Quality Related Effluent Limitations"), 303 ("Water Quality Standards and Implementation Plans"), 306 ("National Standards of Performance"), and 307 ("Toxic and Pretreatment Effluent Standards") of the Clean Water Act. This discharge is also regulated under State Water Board Order No. 2003-0017-DWQ, "*Statewide General Waste Discharge Requirements for Dredged or Fill Discharges that have Received State Water Quality Certification (General WDRs)*," which requires compliance with all conditions of this Water Quality Certification. Please note that enrollment under Order No. 2003-017 DWQ is conditional and, should new information come to our attention that indicates a water quality problem, the San Diego Water Board may issue waste discharge requirements at that time.

Except insofar as may be modified by any preceding conditions, all Certification actions are contingent on (a) the discharge being limited and all proposed mitigation being completed in strict compliance with the applicants' project description and/or on the attached Project Information Sheet, and (b) on compliance with all applicable requirements of the San Diego Water Board's Water Quality Control Plan (Basin Plan).



DAVID W. GIBSON
Executive Officer
San Diego Water Board

4-25-2011
Date

- Attachments:
1. Project Information
 2. Distribution List
 3. Project and Site Maps
 4. Post-Construction BMP Map

Attachment 1

Project Identifiers	
WDID No:	900002059
Reg. Meas. ID:	373818
Place ID:	751786
Party ID:	369584
USAGOE No:	NWP 14, 27, 33, 43
Other File No:	10C-029

PROJECT INFORMATION	
Details	
Application Received Date:	04/08/2010
Application Completed Date:	01/28/2011
Additional Info Completed Date:	05/13/2010, 05/24/2010, 09/22/2010, 09/23/2010, 12/22/2010, 01/14/2011, and 1/28/2011
Applicant:	Jerry Backoff City of San Marcos 1 Civic Center Drive San Marcos, CA 92069
Applicant Representative(s):	Tricia Wotipka Dudek 605 Third St Encinitas, CA 920241
Project Title:	Grand Ave/Los Posas Reach Flood Protection Project (CIP 317)
Regulating Water Board:	Region 9
Type of Project:	Capital improvement project and creek restoration.
Project Description:	
<p>The Project is located in the City of San Marcos along the south side of Grand Avenue between Via Vera Cruz and Linda Vista Drive. Los Posas Creek is an existing north to south trending perennial drainage channel that crosses under Grand Avenue. The Project site is approximately 2.5 acres within a 9.5 acre area surrounding City of San Marcos owned land.</p> <p>The project also includes the installation of a new two-lane, 57-foot-long by 38-foot-wide (2,166 square feet) by 15-foot-high bridge spanning Las Posas Creek to provide access to future redevelopment on the south side of the creek and improved energy dissipaters for six culvert outlets. Future development projects draining into these culverts will need to address treatment of all run-off flowing into these culverts with compliance with the County of San Diego's Municipal Storm Water NPDES permit. Roadway improvements on either side of the bridge will be part of future site redevelopment plans and are not included in this permit action.</p> <p>The project will permanently impact 0.021 acres (192 linear feet) of wetland waters of the United States and impact 0.06 acres (319 linear feet) of waters of the State.</p> <p>The project proposes to widen a 750 feet section of Las Posas Creek from the box culvert located under Grand Avenue to the southwest property line where the creek exits the site. The creek will be widened to a maximum width of 48 feet to accommodate a 100-year storm event and restore more natural functions and services to that portion of the creek. The channel bottom and banks will remain earthen and be restored with native riparian plant species.</p> <p>A setback of 20 feet will be established from the new channel top of bank, which will be hydroseeded with a non-invasive seed mix. Future development of the adjacent property will include landscaping and stormwater management designs with natural upland vegetation and functions that will be in compliance with R9-2007-0001, the current San Diego Municipal Storm Water NPDES permit, and subsequent versions of the permit.</p>	
Location	
City:	San Marcos
County:	San Diego



Attachment 1

10C-029

Cross Streets:	Linda Vista Dr and Via Vera Cruz
Section, Township, Range:	Section 10, Township 12 South, Range 3 West
Zip code:	92069
Directions:	Take State Route 78 to Los Posas Blvd. Exit and turn right onto Las Posas Rd. Turn left on Grand Ave. Turn right into the Ace Hardware parking lot.
Latitude(s) and Longitude(s):	N 33° 08' 23", W -117° 11" 15"

Public Notice

Water Board Public Notice: Information regarding this project was noticed on the San Diego Water Board's website from April 20, 2010 to present.

✓✓ No Comments were received. Comments were responded to in writing.

Fees

Application Fee Provided: A certification fee of \$640.00 was submitted on April 8, 2010 as required by 23 CCR §3833b(2)(A) and by 23 CCR § 2200(e). An additional fee of \$3,100.00 (IF APPLICABLE) to offset additional design impacts was received on May 24, 2010 as required by 23 CCR §3833b(2)(A) and by 23 CCR § 2200(e).

Hydrologic Information

Receiving Water(s):	Los Posas Creek
Hydrologic Unit(s):	904.32, Buena HSA
Water Body Type(s):	Streambed

Designated Beneficial Use(s)

✓	AGR		COMM		FRSH		MIGR		RARE		SPWN		
	AQUA		CUL		GWR	✓	MUN	✓	REC-1	✓	WARM		
	ASBS		EST	✓	IND		NAV	✓	REC-2		WET		
	BIOL		FISH		LWRM		POW		SAL	✓	WILD		
	COLD		FLD		MAR		PRO		SHELL		WQE		

Candidate, Sensitive, or Special Status Species

None

Other Permits/Licenses/Agreements/Plans

Federal (Type and Permit/License Number):

U.S. Army Corps, Nation Wide Permit 14, 27, 33, 43

State (Type and Permit/License/Agreement Number):

Department of Fish and Game Streambed Alteration notification.

Other County, City, etc. (Type and Permit/License Number):
Any Required Documents or Plan Submittals (SWPPP, Mitigation & Monitoring, etc.)
SWPPP, Restoration and Monitoring Plan

NEPA and/or CEQA Compliance	
Document type:	Notice of Determination
Lead Agency:	City of San Marcos
Date completed:	January 11, 2010
State Clearinghouse Number:	2009091007

IMPACTS
Describe Potential Water Quality Impacts:
Potential impacts from construction activities are from the excavation and fill of Los Posas Creek and construction of the bridge.

Final Project Impacts (Fill)*						
Waterbody Type	Permanent			Temporary		
	Acres**	Linear Feet	Cubic Yards	Acres**	Linear Feet	Cubic Yards
Lake						
Ocean						
Riparian						
Streambed	0.02/0.06	192/319				
Vernal Pool						
Wetland						

* Include all three measurements (acres, linear feet and cubic yards) for all federal and non-federal waterbody types.
 ** Provide acres to three decimal places (e.g., 0.006).

Final Project Impacts (Dredge*/Excavation)**						
Waterbody Type	Permanent			Temporary		
	Acres***	Linear Feet	Cubic Yards	Acres***	Linear Feet	Cubic Yards
Lake						
Ocean						
Riparian						
Streambed						
Vernal Pool						
Wetland						

* For projects that will occur annually please provide the total volume to be dredged for the entire certification period (typically 5 years).
 ** Include all three measurements (acres, linear feet and cubic yards) for all federal and non-federal waterbody types.
 *** Provide acres to three decimal places (e.g., 0.006).

Impact Comparison								
	Fill				Dredge			
	Permanent		Temporary		Permanent		Temporary	
	Initial	Final	Initial	Final	Initial	Final	Initial	Final
<i>Impacts (Acres)**</i>								

* Include impacts to both federal and non-federal waters.
 ** Provide acres to three decimal places (e.g., 0.006).

MITIGATION

Describe Avoidance and Minimization for Impacts to Waters:

The project is primarily a stream restoration project. A setback of 20 feet will be established from the new channel top of bank, which will be hydroseeded with a non-invasive seed mix. Future development of the adjacent property will include landscaping and stormwater management designs with natural upland vegetation and functions.

Describe Compensatory Mitigation for Impacts to Waters (temporary and permanent):

The restoration program includes restoration and establishment of 0.62 acre of wetland habitat. The restoration will include 0.09 acres of freshwater marsh/herbaceous wetland habitat, 0.41 acre of Southern Willow Scrub/Herbaceous Wetlands Mosaic, and 0.12 acre of open water.

Compensatory Mitigation (Proponent Provided)

Waterbody Type	Acres Established		Acres Restored		Acres Enhanced		Acres Preserved	
	Temp.*	Perm.	Temp.*	Perm.	Temp.*	Perm.	Temp.*	Perm.
Lake								
Ocean								
Riparian								
Streambed		0.12						
Vernal Pool								
Wetland		0.50						

* Report as mitigation for temporary impacts at a 1:1 ratio any required conditions to restore the site (e.g., re-vegetating or re-contouring).

Compensatory Mitigation (Mitigation Bank)

Waterbody Type	Acres Established	Acres Restored	Acres Enhanced	Acres Preserved
Lake				
Ocean				
Riparian				
Streambed				
Vernal Pool				
Wetland				

Compensatory Mitigation (In-Lieu)

Waterbody Type	Acres Established	Acres Restored	Acres Enhanced	Acres Preserved
Lake				
Ocean				
Riparian				
Streambed				
Vernal Pool				
Wetland				

Proponent Provided Mitigation Information (If Applicable)*		
	Site 1	Site 2
Mitigation Site Location(s):		
Mitigation Site Lat/Long(s)		
Name of Watershed & Hydrologic Unit:		
Mitigation Site City and County:		

*If more than two sites, please provide additional information in the additional information table located at the end of this form.

Mitigation Bank Information (If Applicable)*		
	Bank 1	Bank 2
Mitigation Bank Name:		
Name of Mitigation Bank Operator:		
Address of Mitigation Bank Office:		
Mitigation Bank Location(s):		
Mitigation Bank Lat/Long(s)		
Name of Watershed & Hydrologic Unit:		
Mitigation Bank City and County:		
Mitigation purchase amount (\$):		

*If more than two sites, please provide additional information in the additional information table located at the end of this form.

In-Lieu Mitigation Information (If Applicable)*		
	Program 1	Program 2
Name of approved in-lieu fee mitigation sponsor:		
Address of In-lieu mitigation sponsor:		
Description of in-lieu mitigation arrangements:		
In-lieu mitigation location:		
In-lieu mitigation Lat/Long(s):		
In-lieu mitigation City and County:		
Name of Watershed & Hydrologic Unit:		

*If more than two sites, please provide additional information in the additional information table located at the end of this form.

Additional Mitigation Information (Proponent, Bank, or In-Lieu)		
	Site 1	Site 2
Mitigation Site Name:		
Name of Mitigation Site Operator:		
Address of Mitigation Site Office:		
Mitigation Site Location(s):		
Mitigation Site Lat/Long(s)		
Name of Watershed & Hydrologic Unit:		
Mitigation Site City and County:		
Mitigation purchase amount (\$):		

**ATTACHMENT 2
E-MAIL DISTRIBUTION LIST**

Jerry Backoff
City of San Marcos
jbackoff@ci.san-marcos.ca.us

Michelle L. Mattson
Army Corps of Engineers
Michelle.L.Mattson@usace.army.mil

Kelly Fisher, California Department of Fish and Game
kfisher@dfg.ca.gov

Tricia Wotipka
Dudek Consulting
Twotipka@dudek.com

State Water Resources Control Board, Division of Water Quality
401 Water Quality Certification and Wetlands Unit
Stateboard401@waterboards.ca.gov

U.S. EPA, OWOW, Region 9
75 Hawthorne St.,
San Francisco, CA 94105
R9-WTR8-Mailbox@epa.gov

ATTACHMENT 3

PROJECT AND SITE MAPS



DUDEK

5206-01
OCTOBER 2009

SOURCE: USGS 7.5 Minute Series Los Marcos Quadrangle

Grand Avenue/Las Posas Reach Flood Protection Project - Joint Permit Application

FIGURE 2
Vicinity Map

DRAFT

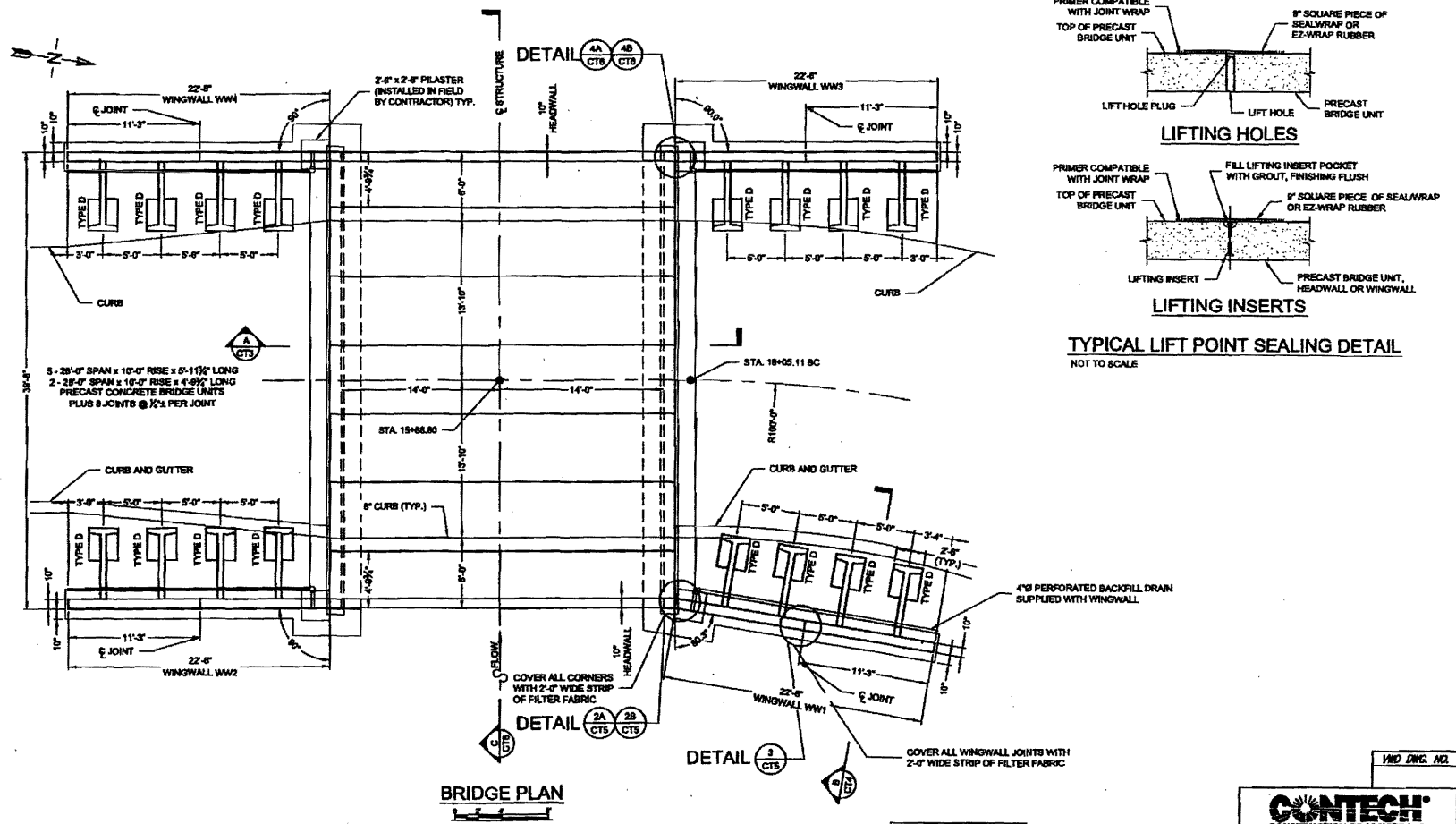

BRIDGE PLAN

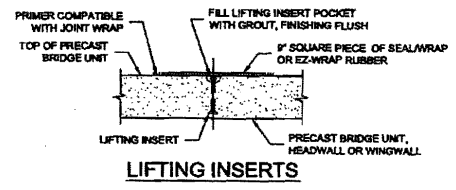
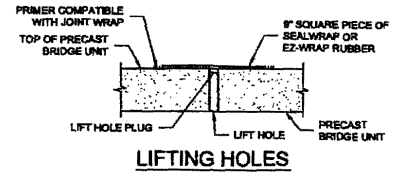

TYPICAL LIFT POINT SEALING DETAIL
 NOT TO SCALE

SAN Marcos FIRE DEPARTMENT		MULLENBACH WATER DISTRICT		OWNER OF WORK		CITY APPROVED CHANGES		RECOMMENDED FOR APPROVAL		APPROVED FOR CONSTRUCTION		CITY OF SAN MARCOS ENGINEERING DIVISION		City Drawing No. IP-4826	
By: _____		By: _____		By: _____		By: _____		By: _____		By: _____		APPROVED FOR CONSTRUCTION		APPROVED FOR CONSTRUCTION	
DATE: _____		DATE: _____		DATE: _____		DATE: _____		DATE: _____		DATE: _____		DATE: _____		DATE: _____	

CONTECH
 CONSTRUCTION PRODUCTS INC.
 www.contech-cpi.com
 8025 Coonrod Pkwy Dr., Suite 400, West Chester, OH 43081
 800-338-1122 513-643-7000 513-643-7180 FAX

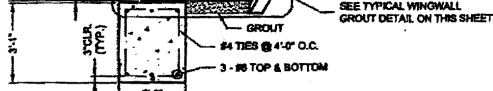
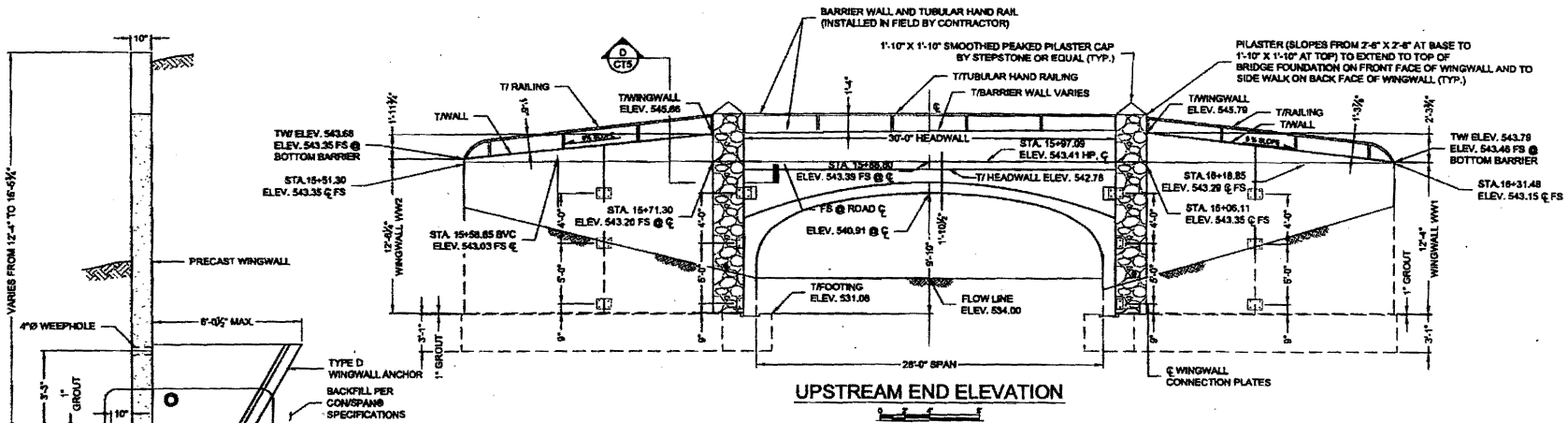

SECTION B-C

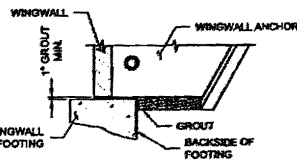

- NOTES:**
- MINIMUM 1" GROUT UNDER WINGWALL LEG & ANCHOR STEM.
 - AREA BETWEEN WINGWALL FOOTING AND WINGWALL ANCHOR SHALL BE GROUTED SOLID BEFORE BACKFILL.
 - FORM BACKSIDE OF FOOTING TO DIMENSIONS SHOWN ON FOUNDATION PLAN.

TYPICAL WINGWALL GROUT DETAIL
NOT TO SCALE

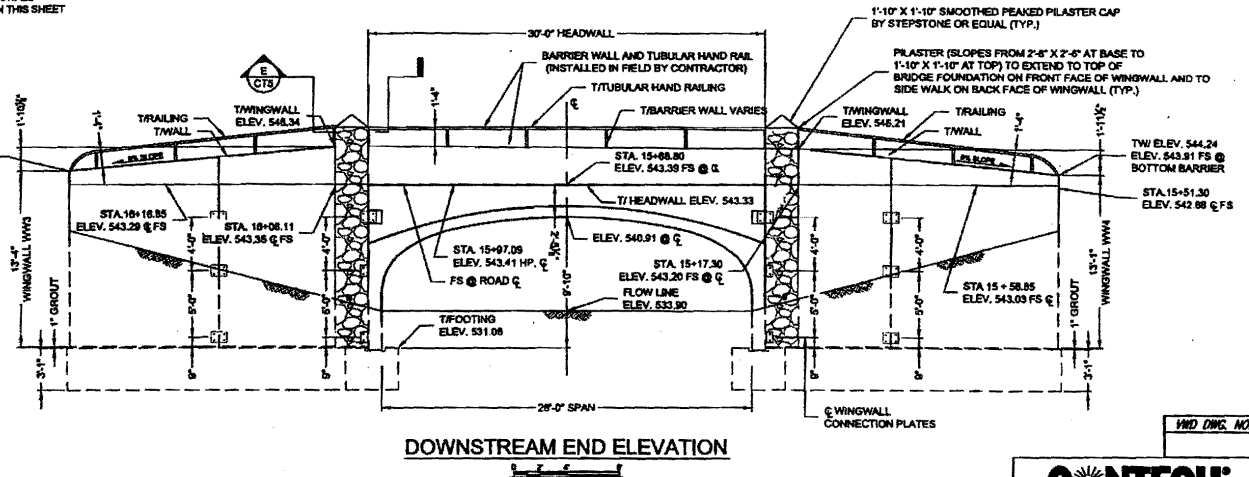

DOWNSTREAM END ELEVATION

SAN MARCOS FIRE DEPARTMENT		WILLIAMSBURG WATER DISTRICT		ENGINEER OF WORK		CITY APPROVED CHANGES		RECOMMENDED FOR APPROVAL		APPROVED FOR CONSTRUCTION		CITY OF SAN MARCOS ENGINEERING DIVISION		City Drawing No.	
By: _____ Date: _____		By: _____ Date: _____		By: _____ Date: _____		By: _____ Date: _____		By: _____ Date: _____		By: _____ Date: _____		APPROVED FOR CONSTRUCTION		APPROVED FOR CONSTRUCTION	
SAN MARCOS FIRE DEPARTMENT		WILLIAMSBURG WATER DISTRICT		ENGINEER OF WORK		CITY APPROVED CHANGES		RECOMMENDED FOR APPROVAL		APPROVED FOR CONSTRUCTION		CITY OF SAN MARCOS ENGINEERING DIVISION		City Drawing No.	
By: _____ Date: _____		By: _____ Date: _____		By: _____ Date: _____		By: _____ Date: _____		By: _____ Date: _____		By: _____ Date: _____		APPROVED FOR CONSTRUCTION		APPROVED FOR CONSTRUCTION	

CONTECH
CONSTRUCTION PRODUCTS INC.
www.contech-usa.com
9025 Centre Pointe Dr., Suite 400, West Chester, OH 43080
800-338-1122 513-945-7000 513-945-7903 FAX

CT4
NAME _____
DATE _____
R.C.E. _____
C.P. _____

AMPROVEMENT PLANS FOR BRIDGE AT
GRAND AVENUE DRAINAGE/ROAD IMPROVEMENTS
SHEET 18 OF 21

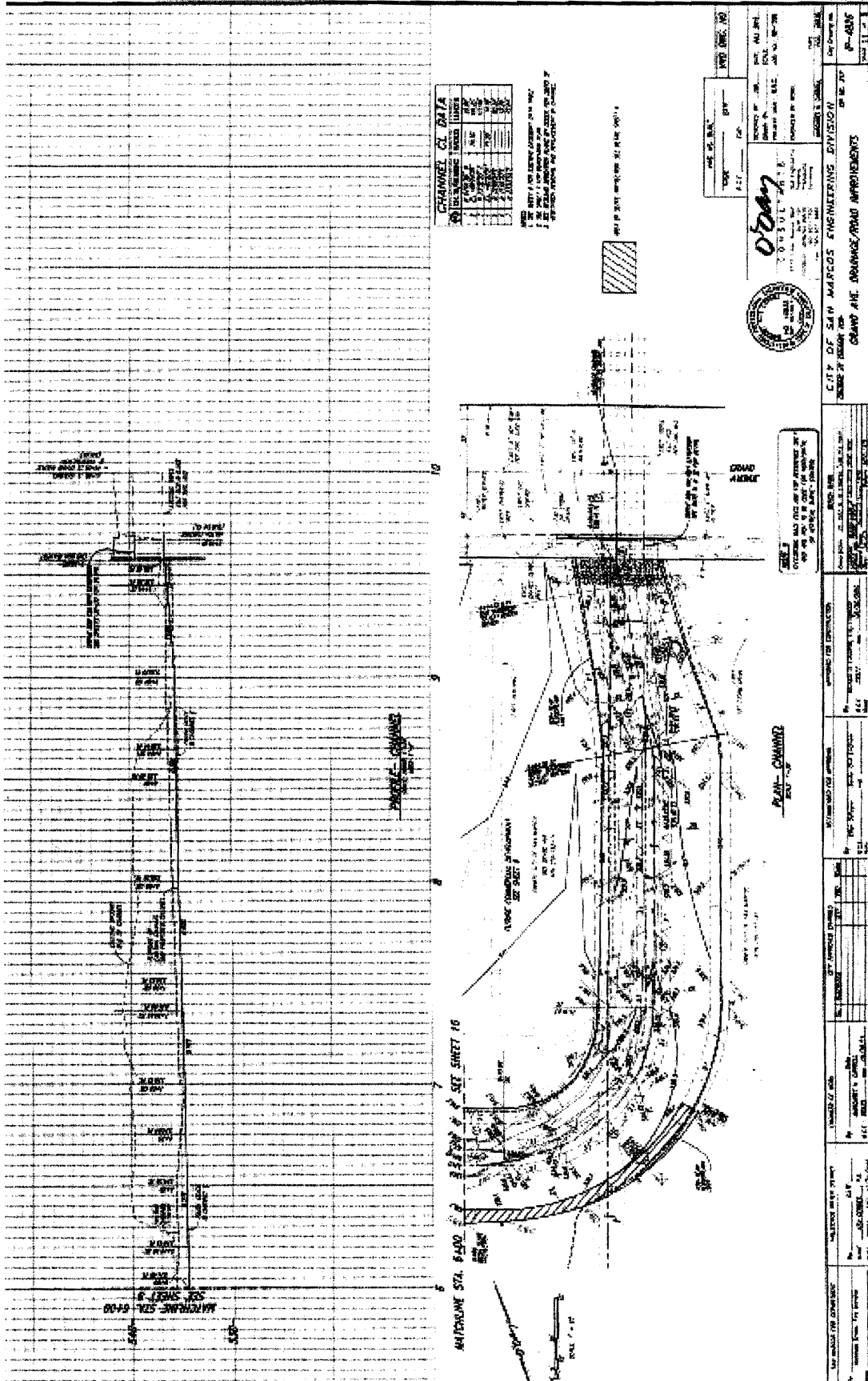

CHANNEL DATA

NO.	DATE	BY	REVISION
1	10/15/78	J.M.	ISSUED FOR PERMITS
2	10/15/78	J.M.	ISSUED FOR PERMITS
3	10/15/78	J.M.	ISSUED FOR PERMITS
4	10/15/78	J.M.	ISSUED FOR PERMITS
5	10/15/78	J.M.	ISSUED FOR PERMITS
6	10/15/78	J.M.	ISSUED FOR PERMITS
7	10/15/78	J.M.	ISSUED FOR PERMITS

THIS SET IS TO BE USED ONLY FOR THE PROJECT SHOWN ON THESE PLANS. IT IS NOT TO BE USED FOR ANY OTHER PROJECTS.

DATE: 10/15/78
 DRAWN BY: J.M.
 CHECKED BY: J.M.
 PROJECT NO.: 10C-029
 SHEET NO.: 10
 TOTAL SHEETS: 10
 CITY OF SAN MARCOS ENGINEERING DIVISION
 GRAND AVE. DRAINAGE/ROAD IMPROVEMENTS
 P-428
 DATE: 10/15/78

NO.	DATE	BY	REVISION
1	10/15/78	J.M.	ISSUED FOR PERMITS
2	10/15/78	J.M.	ISSUED FOR PERMITS
3	10/15/78	J.M.	ISSUED FOR PERMITS
4	10/15/78	J.M.	ISSUED FOR PERMITS
5	10/15/78	J.M.	ISSUED FOR PERMITS
6	10/15/78	J.M.	ISSUED FOR PERMITS
7	10/15/78	J.M.	ISSUED FOR PERMITS
8	10/15/78	J.M.	ISSUED FOR PERMITS
9	10/15/78	J.M.	ISSUED FOR PERMITS
10	10/15/78	J.M.	ISSUED FOR PERMITS

ATTACHMENT 4
MITIGATION MAPS

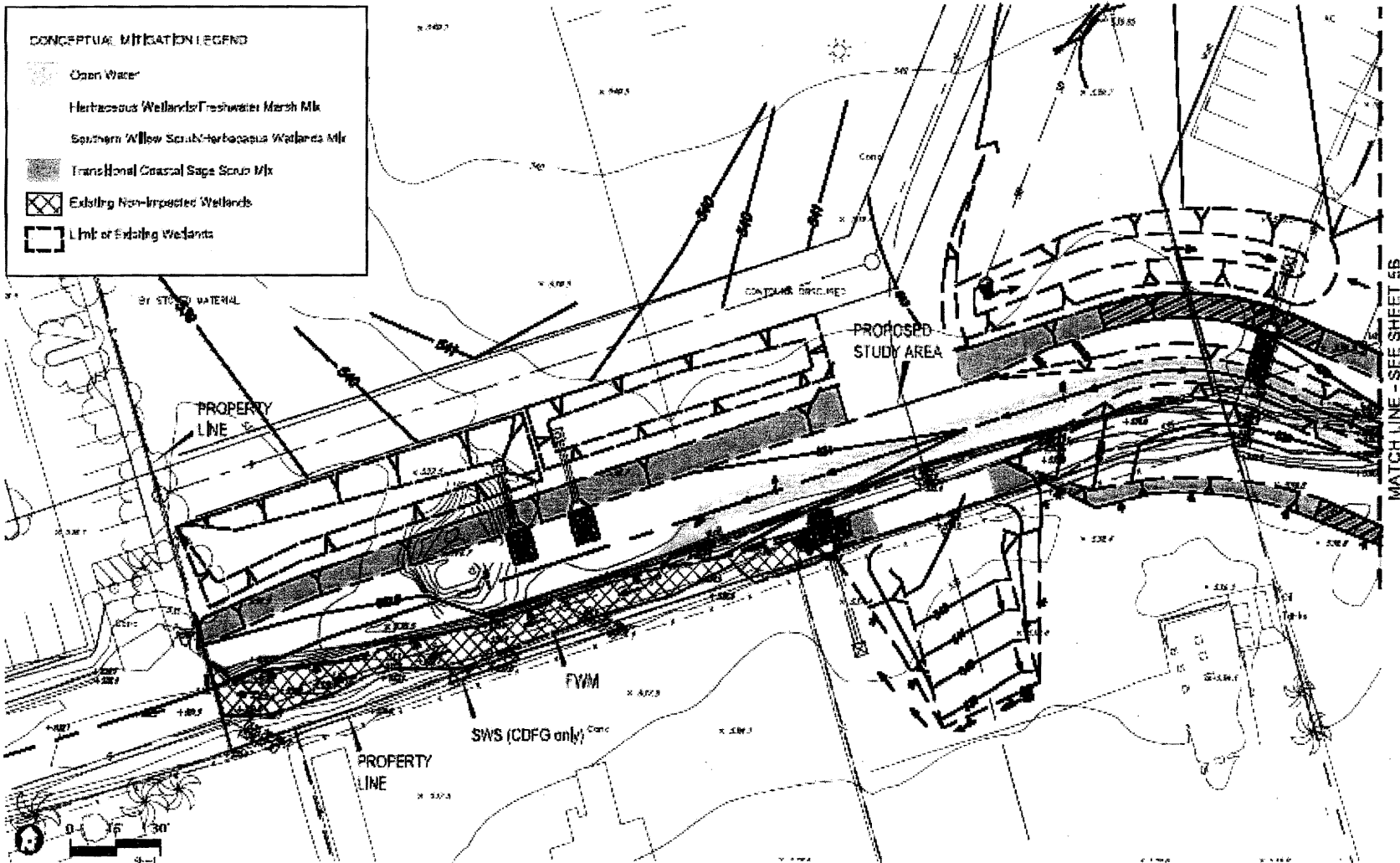

DUDEK

DESIGN SOLUTIONS & DAY CONSULTANTS, INC.

Grand Avenue Las Vegas Road Flood Protection Project - Revised Wetland Restoration and Mitigation Plan







FIGURE 5A
Wetland Mitigation Plan

MATCH LINE - SEE SHEET 5A

PROPERTY LINE

PROPOSED STUDY AREA

CONCEPTUAL MITIGATION LEGEND

-  Open Water
-  Herbaceous Wetlands/Freshwater Marsh Mix
-  Southern Willow Scrub/Herbaceous Wetlands Mix
-  Transitional Coastal Sage Scrub Mix
-  Existing Non-Impacted Wetlands
-  Limit of Existing Wetlands

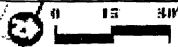

DUDEK

DESIGN SOURCE/DAY CONSULTANTS 2010

Grand Avenue/Las Pallas Reach Flood Protection Project - Ambient Wetland Restoration and Mitigation Plan

FIGURE 5B
Wetland Mitigation Plan

10C-029

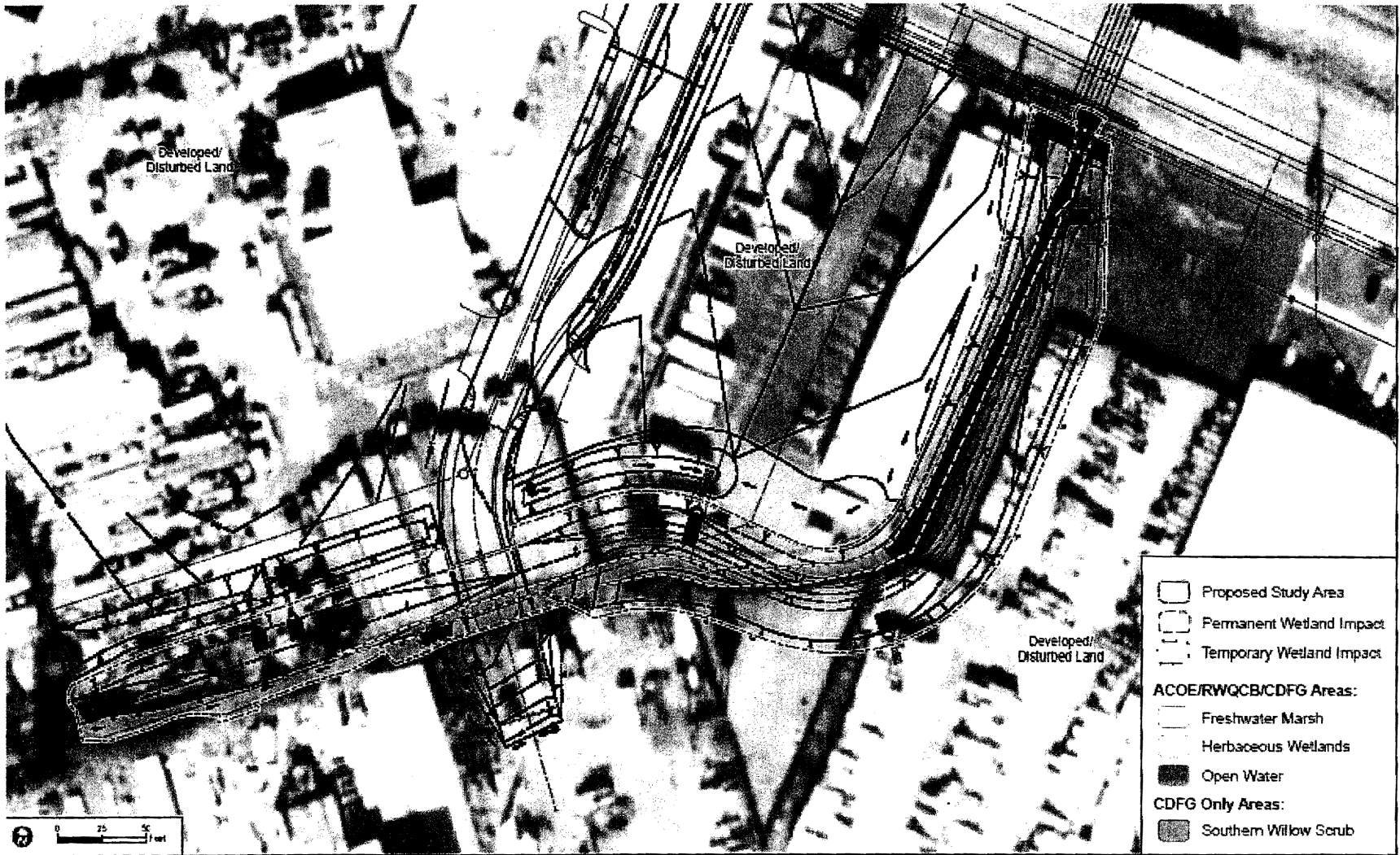

DUDEK

Environmental Solutions
2000 Valley Road, Suite 200
Baltimore, MD 21286

0206-01
AUGUST 2010

Grand Avenue/Lewis Ponds Reach Flood Protection Project - Revised Wetland Restoration and Monitoring Plan

- Proposed Study Area
- Permanent Wetland Impact
- Temporary Wetland Impact
- ACOE/RWQCB/CDFG Areas:**
- Freshwater Marsh
- Herbaceous Wetlands
- Open Water
- CDFG Only Areas:**
- Southern Willow Scrub

FIGURE 4
Wetlands Impacts Map

7010 1060 0000 4952 7914

PLEASE STICK TO ONE SIDE OF THE MAIL TO BE RIGHT
ON THE MAIN ADDRESS-POSTAGE FACED LINE

CERTIFIED MAIL™



7010 1060 0000 4952 7914
7010 1060 0000 4952 7914

U.S. Postal Service™
CERTIFIED MAIL™ RECEIPT
(Domestic Mail Only; No Insurance Coverage Provided)

For delivery information visit our website at www.usps.com®

OFFICIAL USE

Postage	\$	Postmark Here
Certified Fee		
Return Receipt Fee (Endorsement Required)		
Restricted Delivery Fee (Endorsement Required)		
Total Postage & Fees	\$	

Sent To Jerry Backoff
 Street, Apt. No. or PO Box No. 1 Civic Center Drive
 City, State, ZIP+4 San Marcos, CA 92069

PS Form 3800, August 2006 See Reverse for Instructions

SENDER: COMPLETE THIS SECTION

- Complete items 1, 2, and 3. Also complete item 4 if Restricted Delivery is desired.
- Print your name and address on the reverse so that we can return the card to you.
- Attach this card to the back of the mailpiece, or on the front if space permits.

1. Article Addressed to:
 City of San Marcos
 1 Civic Center Drive
 San Marcos, CA
 92069
 Attn: Jerry Backoff

2. Article Number
 (Transfer from service label)

COMPLETE THIS SECTION ON DELIVERY

A. Signature X Agent Addressee

B. Received by (Printed Name) C. Date of Delivery

D. Is delivery address different from item 1? Yes
 If YES, enter delivery address below: No

3. Service Type
 Certified Mail Express Mail
 Registered Return Receipt for Merchandise
 Insured Mail C.O.D.

4. Restricted Delivery? (Extra Fee) Yes