

CALIFORNIA REGIONAL WATER QUALITY CONTROL BOARD  
CENTRAL VALLEY REGION

ORDER NO. 76-231

REVISION AND AMENDMENT OF THE WATER QUALITY CONTROL PLAN,  
SACRAMENTO RIVER BASIN 5A, BY THE ADDITION OF A  
PROHIBITION OF WASTE DISCHARGE FROM LEACHING AND  
PERCOLATION SYSTEMS WITHIN THE DAPHNEDALE AREA

MODOC COUNTY

The California Regional Water Quality Control Board, Central Valley Region (hereafter referred to as Board), finds that:

1. On 25 July 1975, the Board adopted a Water Quality Control Plan for the Sacramento River Basin 5A.
2. The Plan contains areas where discharge of waste from leaching and percolation systems is prohibited.
3. The Daphnedale area is located immediately north and adjacent to the City of Alturas, approximately 1 mile (1.6 km) north of Highway 299 in Sections 1 and 2, T 42 N, R 12 E, MDB&M. Sewage disposal in this area is by means of individual leaching and percolation systems.
4. A sanitary survey conducted in the Daphnedale area between March and May 1976 by the Modoc County Health Department indicated that 12, or 33 percent, of the 36 individual sewage disposal systems surveyed were unsatisfactory. Unsatisfactory systems include "seepage from septic tanks, seepage from leach lines, open cesspools, pit privies, and any disposal of sewage or waste other than subsurface." The unsatisfactory systems were declared "a threat to the immediate health, safety, and well-being of the public."
5. The residents of the area are in the process of forming the Daphnedale Community Services District, a public entity, which will be responsible for the collection and disposal of sewage.
6. Surface drainage from the Daphnedale area is to the North Fork of the Pit River, just upstream from its confluence with the South Fork of the Pit River. The beneficial uses of the Pit River are agricultural supply; recreation; aesthetic enjoyment; and preservation and enhancement of fish, wildlife, and other aquatic resources.
7. The beneficial uses of the groundwater are domestic and agricultural supply.
8. The area of concern is the entire area within the proposed Daphnedale Community Services District boundary, as identified on Attachments "A" and "B".
9. Continued installation and usage of leaching and percolation systems will increase the threat to public health and impairment of water quality.

REVISION AND AMENDMENT OF THE WATER  
QUALITY CONTROL PLAN 5A  
DAPHNEDALE AREA  
MODOC COUNTY

-2-

10. The Modoc County Health Department concurs with staff that a prohibition of waste discharge from leaching and percolation systems is warranted.
11. On 22 October 1976, in the City Hall Council Chambers, Redding, after due public notice, the Board conducted a public hearing at which evidence was received concerning the discharge of wastes from individual sewage disposal systems.

IT IS HEREBY ORDERED that:

1. The discharge of waste within the Daphnedale area, as delineated on Attachments "A" and "B" of this Order, from leaching or percolation systems installed after approval of this amendment by the State Water Resources Control Board is prohibited. An exemption to this prohibition may be granted by the Executive Officer after presentation by the proposed discharger of geologic and hydrologic evidence that leaching system disposal will not, individually or collectively, result in pollution or nuisance.
2. The discharge of waste within the Daphnedale area from leaching or percolation systems is prohibited after 1 January 1981. An exemption to this prohibition may be granted whenever the Board finds that the continued operation of individual sewage disposal systems in a particular area will not, individually or collectively, directly or indirectly, adversely affect water quality or threaten public health.
3. Chapter V of the Water Quality Control Plan is revised by the addition of this prohibition, upon approval of the State Water Resources Control Board.

I, JAMES A. ROBERTSON, Executive Officer, do hereby certify the foregoing is a full, true, and correct copy of an Order adopted by the California Regional Water Quality Control Board, Central Valley Region, on 22 October 1976.

Original signed by

JAMES A. ROBERTSON, Executive Officer

EJG:cr 30 September 1976



PROPOSED DAPHNE DALE COMMUNITY  
SERVICES DISTRICT BOUNDARY

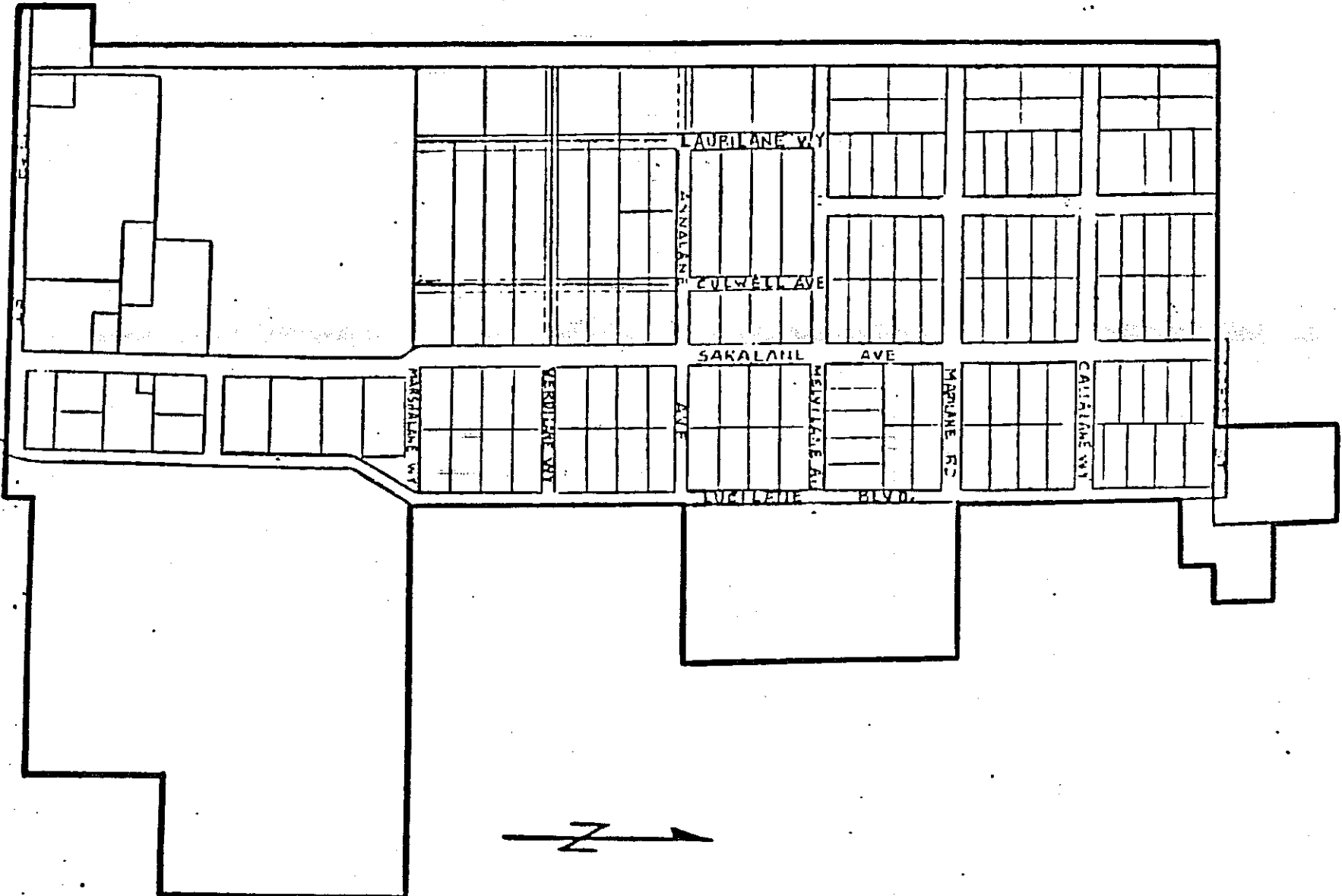

Attachment "B"