

**CALIFORNIA REGIONAL WATER QUALITY CONTROL BOARD  
COLORADO RIVER BASIN REGION**

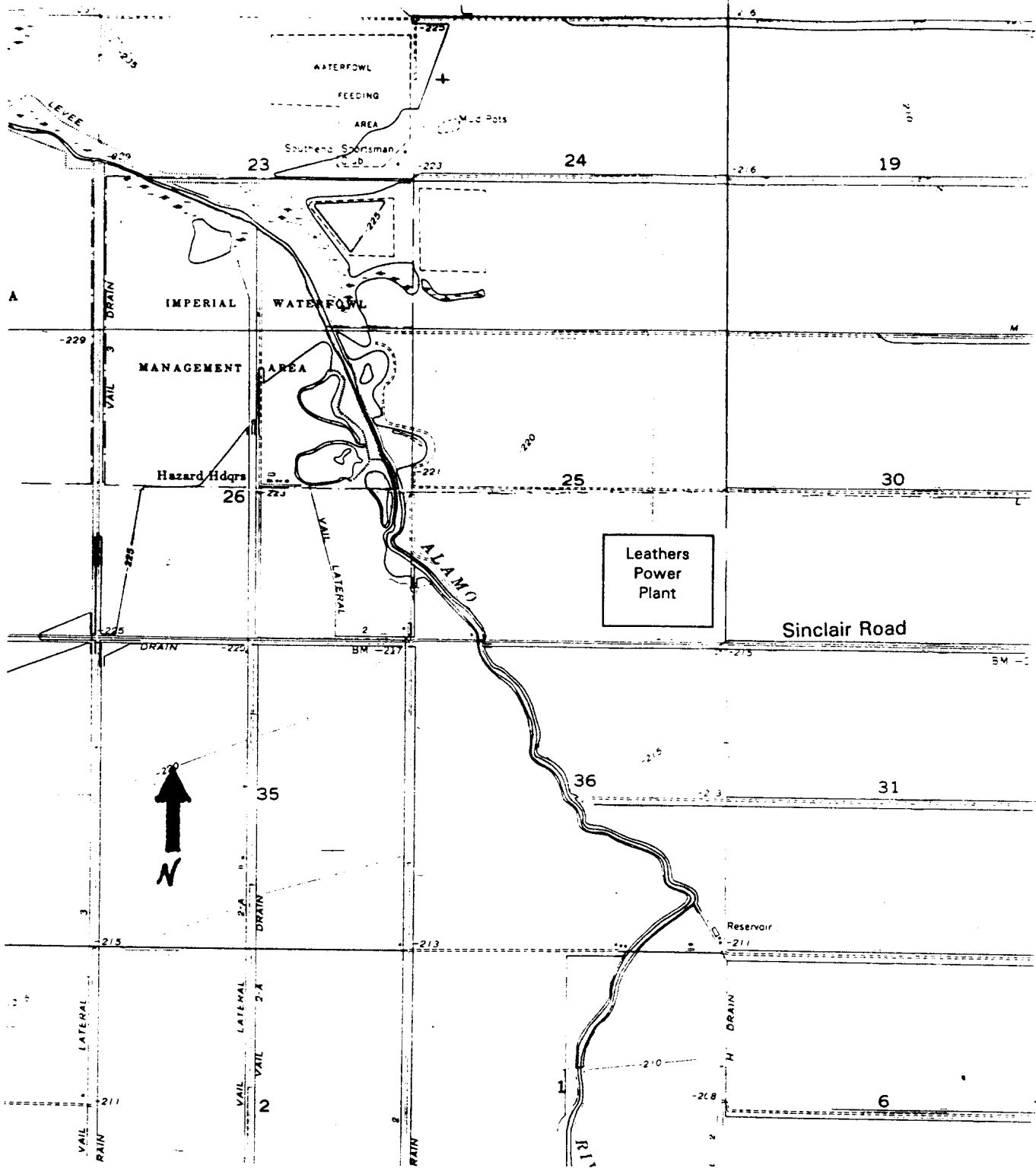

**Attachment A**

MAGMA POWER COMPANY, LANDOWNER  
 CALENERGY OPERATING CORPORATION, OPERATOR  
 FOR LEATHERS POWER PLANT HOLDING POND AND WELLFIELD BASINS (MUD SUMPS)  
 Salton Sea Known Geothermal Resource Area - Imperial County  
 SE¼, SE¼, Section 25, T11S, R13E, SBB&M

**Board Order No. R7-2008-0050**