

**CALIFORNIA REGIONAL WATER QUALITY CONTROL BOARD
COLORADO RIVER BASIN REGION**

ORDER NO. 88-6

**WASTE DISCHARGE REQUIREMENTS
FOR
A&N MOTEL
North Palm Springs - Riverside County**

The California Regional Water Quality Control Board, Colorado River Basin Region, finds that:

1. A&N Development Company (hereinafter also referred to as the discharger), P.O. Box 906, North Palm Springs, California, 92158, submitted a Report of Waste Discharge dated December 3, 1986.
2. The discharger proposes to discharge a maximum of 30,000 gallons-per-day of domestic sewage from a motel complex designed to have a total of 116 motel units with an office building, a service station and a restaurant. Wastewater would be discharged into septic tank/seepage pit disposal systems, to be located in the NE $\frac{1}{4}$, NE $\frac{1}{4}$ of Section 22, and in the SE $\frac{1}{4}$, SE $\frac{1}{4}$ of Section 15, T3S, R4E, SBB&M.
3. The discharger is reserving areas of sufficient size for possible future 100 percent replacement of the seepage pits.
4. There are no domestic wells within 200 feet of the proposed discharge facilities described in Findings No. 2 and 3 (above).
5. Wastewater from a swimming pool and a hot pool would be periodically discharged onto landscape plantings.
6. The Water Quality Control Plan for the Colorado River Basin Region of California was adopted by the Regional Board on November 14, 1984.
7. The Basin Plan delineates the location of discharge to be in the Coachella Hydrologic Subunit, which has the following beneficial uses of ground water:
 - a. Municipal supply
 - b. Industrial supply
 - c. Agricultural supply
8. The Board has notified the discharger and interested agencies and persons of its intent to prescribe waste discharge requirements for the proposed discharge.
9. The Board in a public meeting heard and considered all comments pertaining to the proposed discharge.

*Cancelled
3/22/89*

10. The Riverside County Planning Department has approved Negative Declaration EA. No. 31446 (approval date November 3, 1987) for this proposed complex. The Regional Board has reviewed this Negative Declaration. The below waste discharge requirements are designed to insure against any significant adverse effects on water quality.

IT IS HEREBY ORDERED, the discharger shall comply with the following:

A. Discharge Specifications

1. Neither the treatment nor the discharge of wastewater shall create a pollution or a nuisance as defined in Division 7 of the California Water Code.
2. No wastewater other than domestic sewage and swimming pool and hot pool wastewater shall be discharged at this location.
3. Wastewater discharged subsurface shall be retained underground with no surfacing.
4. Adequate measures shall be taken to assure that flood or surface drainage waters do not erode or otherwise render portions of the discharge facilities inoperable.
5. Septic tank cleanings shall be discharged only by a duly authorized service.
6. Swimming pool and hot pool wastewater shall not be discharged into a sewage disposal system.

B. Provisions

1. Sufficient land area shall be reserved for possible future 100 percent replacement of the seepage pits, until such time as this complex is connected to a municipal sewerage system.
2. The discharger shall comply with the attached "Monitoring and Reporting Program No. 88-6", and future revisions thereto, as specified by the Executive Officer.
3. Prior to any modifications in this facility which would result in material change in the quality or quantity of wastewater discharged, or any material change in location of discharge, the discharger shall report in writing to the Regional Board.
4. Prior to any change of ownership of this motel complex, the discharger shall:
 - a. Specify as a condition of transfer that the area specified in Provision B.1 (above) remain servient to the development for the purpose of providing additional subsurface sewage disposal capacity

until such time as this complex is connected to a municipal sewerage system.

- b. Transmit a copy of this Order to the succeeding owner or operator, and file a copy of the transmittal letter with this Board.

I, Arthur Swajian, Executive Officer, do hereby certify the foregoing is a full, true and correct copy of an Order adopted by the California Regional Water Quality Control Board, Colorado River Basin Region, on January 27, 1988.

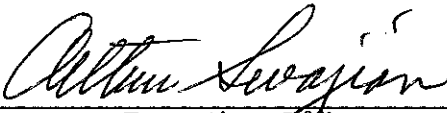

Executive Officer

**CALIFORNIA REGIONAL WATER QUALITY CONTROL BOARD
COLORADO RIVER BASIN REGION**

**MONITORING AND REPORTING PROGRAM NO. 88-6
FOR
A&N MOTEL
North Palm Springs - Riverside County**

Location: Portion of the NE $\frac{1}{4}$, NE $\frac{1}{4}$ of Section 22, and of the SE $\frac{1}{4}$, SE $\frac{1}{4}$ of Section 15,
T3S, R4E, SBB&M

MONITORING

The discharger shall submit an annual status report on the following:

1. Number of motel units and other buildings presently connected to the sewerage system.
2. List any proposed changes in the sewage disposal facilities during the upcoming year.
3. Explain any surfacing of wastewater or other failures of the system over the past year.

REPORTING

1. Annual reports are to be submitted by January 15th of each year to:

California Regional Water Quality Control Board
Colorado River Basin Region
73-271 Highway 111, Suite 21
Palm Desert, CA 92260

2. Report immediately any surfacing of wastewater or other failures by telephone and follow-up by letter.

ORDERED BY:

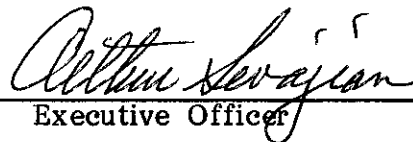
Executive Officer

January 27, 1988
Date

CALIFORNIA REGIONAL WATER QUALITY CONTROL BOARD -7

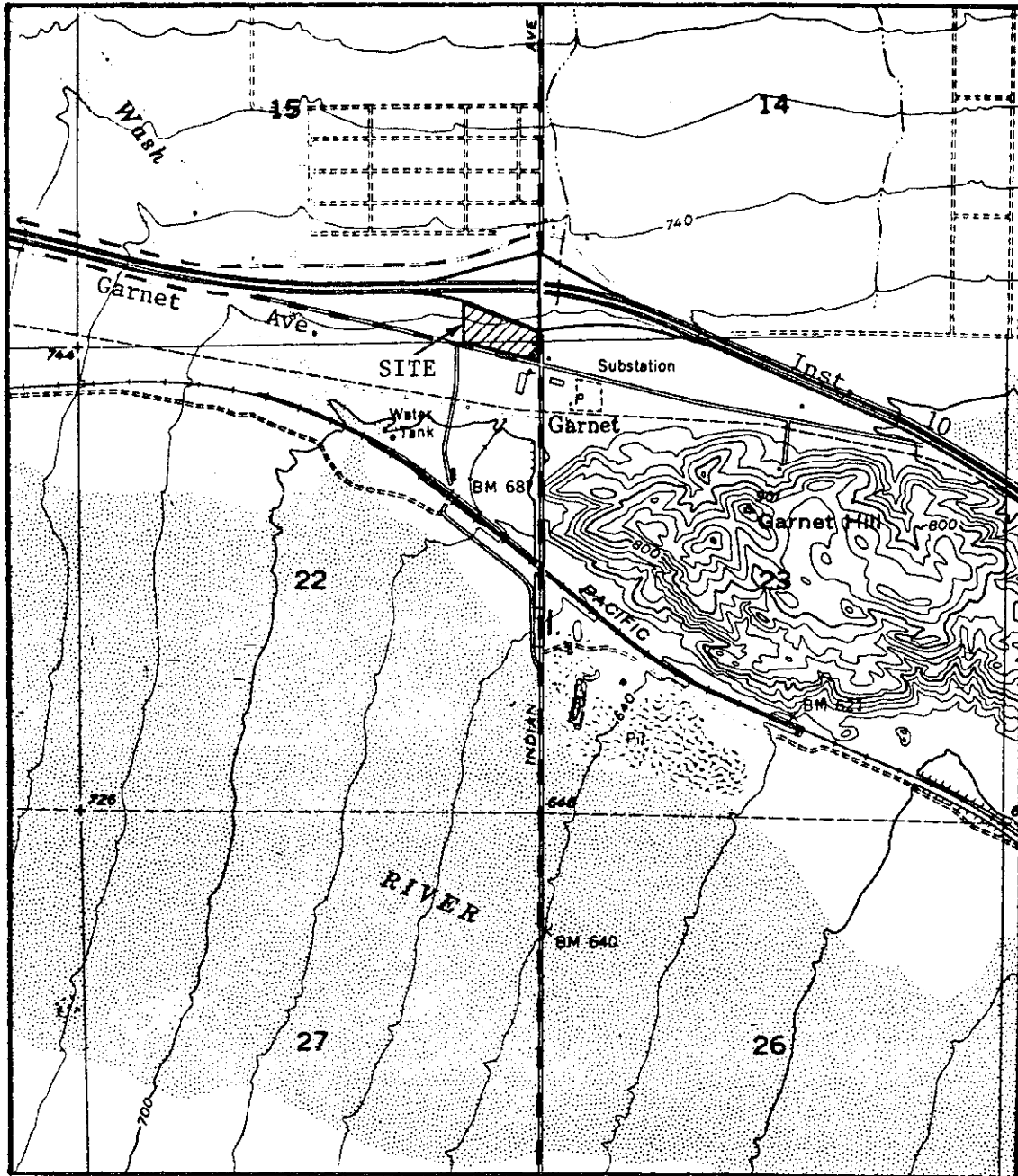

SITE MAP



A&N MOTEL

North Palm Springs - Riverside County
Portion of NE $\frac{1}{4}$, NE $\frac{1}{4}$ of Sec. 22, and of SE $\frac{1}{4}$, SE $\frac{1}{4}$ of Sec. 15,
T3S, R4E, SBB&M
USGS Desert Hot Springs 7.5 min. Topographic Map

Order No. 88-6

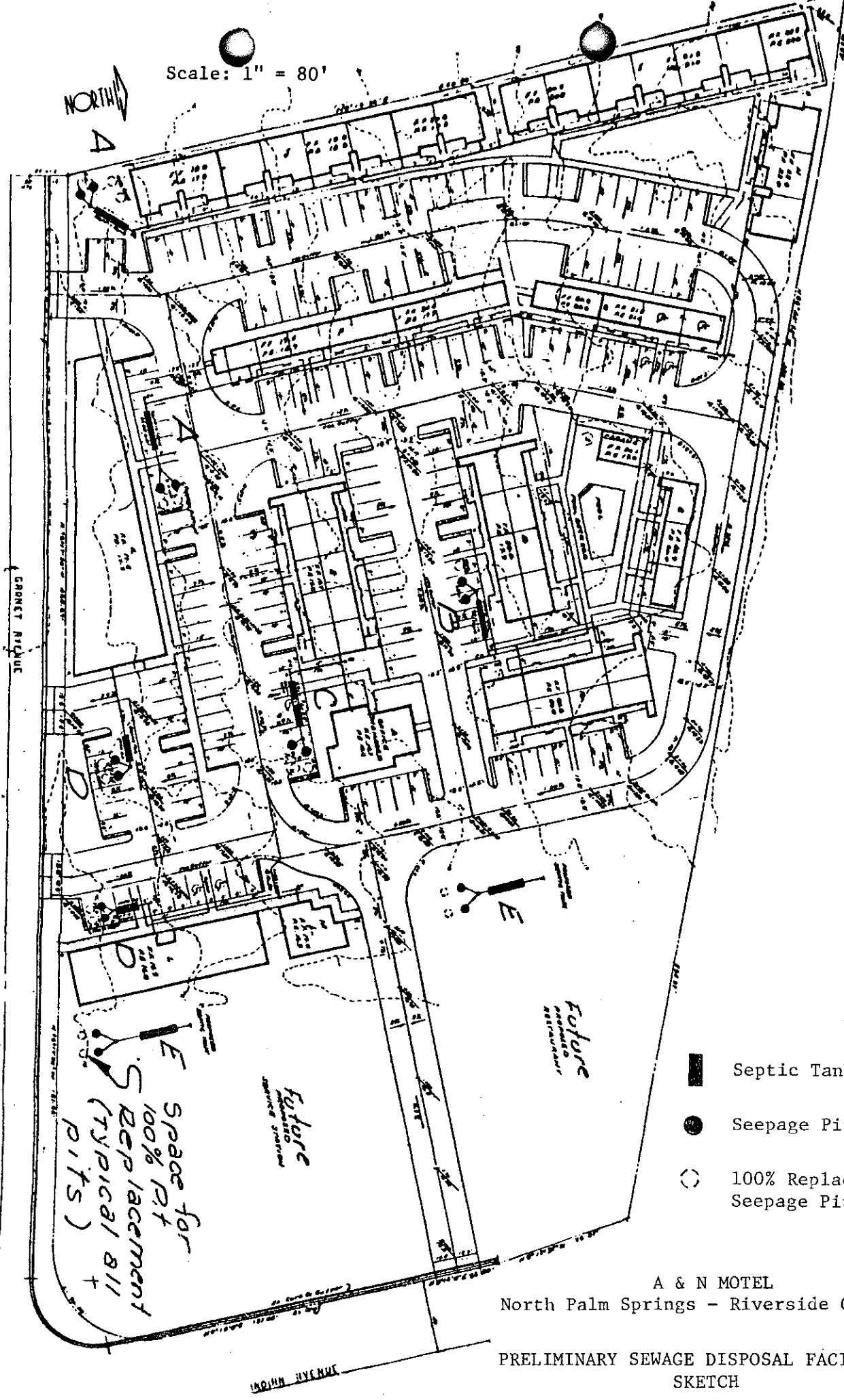
Scale: 1" = 80'



-  Septic Tank
-  Seepage Pit
-  100% Replacement Seepage Pit

A & N MOTEL
North Palm Springs - Riverside County

PRELIMINARY SEWAGE DISPOSAL FACILITIES
SKETCH